

U. S. Department of Agriculture  
FOREST SERVICE

U-V 1

Chippewa NATIONAL FOREST

CORNERS OF THE PUBLIC SURVEY

T. 147 R. 6 S. 4 Mer.

Corner common to Sections

25, and 30

Corner consists of a Iron Post (not) in place

State condition Good

Dimensions above ground 11 1/2" inches

Sketch grooves, letters, figures, or notches, on proper face or edge.

CARDINAL POSITION

DIAGONAL POSITION

T-147			
B-27	B-30		
S-25	S-30		
N	W	S	E

NW	SW	SE	NE

Mound of \_\_\_\_\_ is located \_\_\_\_\_

Pits are located \_\_\_\_\_

Sketch markings of Bearing Trees (or Rocks) in proper box and fill blanks below, giving bearings from Corner to Trees and Distances in Links.

T-147 B-27 S-25	T-147 B-30 S-30		
B-27	B-30		

Species White Pine White Pine

Diameter 12" 5"

Bearing N-42°E N-10°E

Distance 144 100

Do you believe this to be a genuine Land Office Corner? Yes

If not, why? \_\_\_\_\_

C. B. Baker  
(Signature)

1920  
(Date)

Land Office  
(Title)

Metal Location Poster is on a tree inches diameter, on the side of from which this Corner bears chains distant.

Give any further facts which will aid in finding this Corner again.

	Sec.		Sec.
	Sec.		Sec.

(Make sketch of topography near Corner)

T. Lutz R. Mer.

Form 874-9—Revised May, 1918  
 U. S. Department of Agriculture  
 FOREST SERVICE

4-4-1

Chippewa NATIONAL FOREST

CORNERS OF THE PUBLIC SURVEY

T. 147N R. 26W 5th Mer.

no. Corner common to Sections

25, and 30

Corner consists of a Iron Post (not) in place

State condition New

Dimensions above ground 1" - 28" inches

Sketch grooves, letters, figures, or notches, on proper face or edge.

CARDINAL POSITION

DIAGONAL POSITION

B27	B26
525	530

N W S E

--	--	--	--

NW SW SE NE

Mound of \_\_\_\_\_ is located \_\_\_\_\_

Pits are located \_\_\_\_\_

Sketch markings of Bearing Trees (or Rocks) in proper box and fill blanks below, giving bearings from Corner to Trees and Distances in Links.

F147
B26
530

F147
B27
525

--

--

BT
----

no BT
-------

--

--

Species W. Oak J.P.

Diameter 12 5

Bearing N41 3/4 E N24 1/2 W

Distance 141 141

Do you believe this to be a genuine Land Office Corner? yes

If not, why? \_\_\_\_\_

(Signature)

(Date)

(Title)

1136

(Make sketch of topography near Corner)

T. 142 R. 26 Mer. 15th

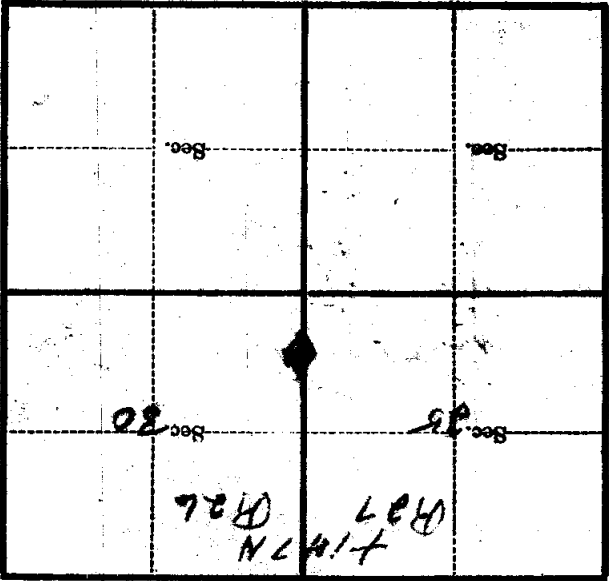

Metal Location Poster is on a

tree inches diameter, on the

side of

from which this Corner bears

chains distant.

Give any further facts which will aid in finding this

Corner again.

U. S. Department of Agriculture

FOREST SERVICE

~~U-1~~  
U-1

Chippewa NATIONAL FOREST

CORNERS OF THE PUBLIC SURVEY

T. 147N R. 26W 5th Mer.

M.C. Corner common to Sections

25, and 30

Corner consists of a Iron Post (not) in place

State condition New

Dimensions above ground 1" - 28" inches

Sketch grooves, letters, figures, or notches, on proper face or edge.

CARDINAL POSITION

DIAGONAL POSITION

B27	B26
525	530

N W S E

NW SW SE NE

Mound of \_\_\_\_\_ is located \_\_\_\_\_

Pits are located \_\_\_\_\_

Sketch markings of Bearing Trees (or Rocks) in proper box and fill blanks below, giving bearings from Corner to Trees and Distances in Links.

F147
B26
530

F147
B27
525



BT
----

MC BT
-------

--

--

Species W. Oak J P

Diameter 12 5

Bearing N41 3/4 E N24 1/4 W

Distance 141 141

Do you believe this to be a genuine Land Office Corner? yes  
If not, why?

(Signature)

(Date)

(Title)

Metal Location Poster is on a tree inches diameter, on the side of from which this Corner bears chains distant.

Give any further facts which will aid in finding this Corner again.

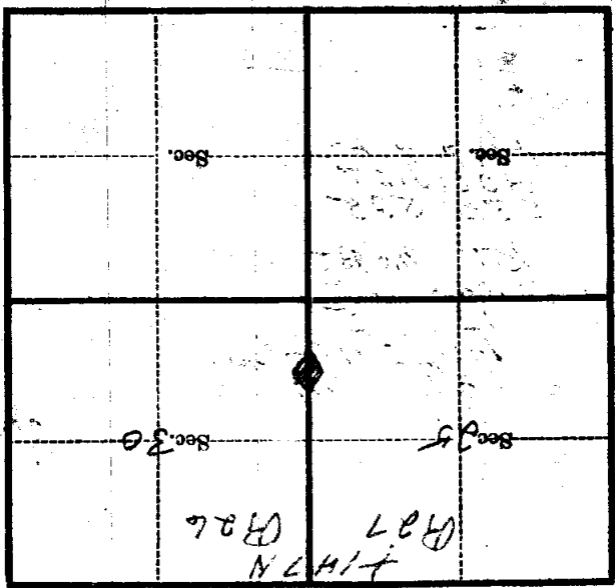

(Make sketch of topography near Corner)

T. 147 N. R. 26 E. P. 5-74 Mer.

Form 874-9—Revised May, 1918  
**U. S. Department of Agriculture**  
**FOREST SERVICE**

4-1-11

Chippewa NATIONAL FOREST  
**CORNERS OF THE PUBLIC SURVEY**

T. 147 R. 26 5<sup>th</sup> Mer.

M.C. Corner common to Sections  
25, and 30.

Corner consists of a Iron Post ~~(post)~~ in place  
 State condition new

Dimensions above ground 1" x 2 1/2" inches

Sketch grooves, letters, figures, or notches, on proper face or edge.

**CARDINAL POSITION**

**DIAGONAL POSITION**

T. 147			
R. 26	/		R. 26
S. 25	/		S. 30
N	W	S	E

NW	SW	SE	NE

Mound of \_\_\_\_\_ is located \_\_\_\_\_

Pits are located \_\_\_\_\_

Sketch markings of Bearing Trees (or Rocks) in proper box and fill blanks below, giving bearings from Corner to Trees and Distances in Links.

T. 147
R. 26
S. 30

T. 147
R. 26
S. 25

--

--

B.T.
------

B.T.
------

--

--

Species W. OAK D. PINE

Diameter 12" 5"

Bearing N. 42° E N. 34° W

Distance 1.41 1.41

Do you believe this to be a genuine Land Office Corner? Yes.

If not, why? \_\_\_\_\_

B. Albee  
 (Signature)

1936  
 (Date)

Leader  
 (Title)

Corner again.

Give any further facts which will aid in finding this

chains distant.

from which this Corner bears

side of

tree inches diameter, on the

Metal Location Poster is on a

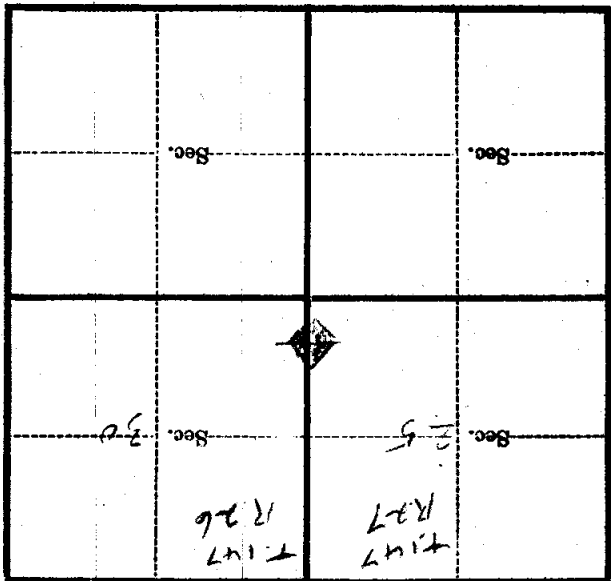

(Make sketch of topography near Corner)

T. 147 R. 26 Mer. *SA*