

U. S. Department of Agriculture
FOREST SERVICE

25

NATIONAL FOREST

CORNERS OF THE PUBLIC SURVEY

T. 147 R. 26425 5th Mer.

14 Corner common to Sections _____, _____, and 6

Corner consists of a 2" pipe & cap (not) in place

State condition New

Dimensions above ground 16 inches

Sketch grooves, letters, figures, or notches, on proper face or edge.

CARDINAL POSITION

DIAGONAL POSITION

--	--	--	--

N W S E

--	--	--	--

NW SW SE NE

Mound of _____ is located _____

Pits are located _____

Sketch markings of Bearing Trees (or Rocks) in proper box and fill blanks below, giving bearings from Corner to Trees and Distances in Links.

<u>147</u>	<u>147</u>	<u>147</u>	
<u>R-26</u>	<u>R-26</u>	<u>35</u>	
<u>S-1</u>	<u>S-1</u>	<u>S 6</u>	
<u>BT</u>	<u>BT</u>	<u>BT</u>	

Species Elm Bass Elm

Diameter 5" 6" 4"

Bearing N 23W S 64W N 42E

Distance 20' 11.3 10.3

Do you believe this to be a genuine Land Office Corner? _____

If not, why? _____

10-29-58
(Date)

(Signature)

(Title)

Corner again.
Bearing of Cor. is on the cor.
of old fence line
to on post along Rd # 2188

Give any further facts which will aid in finding this
chain distant.
11.3
from which this Corner bears
N 44 E
side of ~~the~~
tree 6 inches diameter, on the NE
Metal Location Poster is on a ~~Bar Wood~~

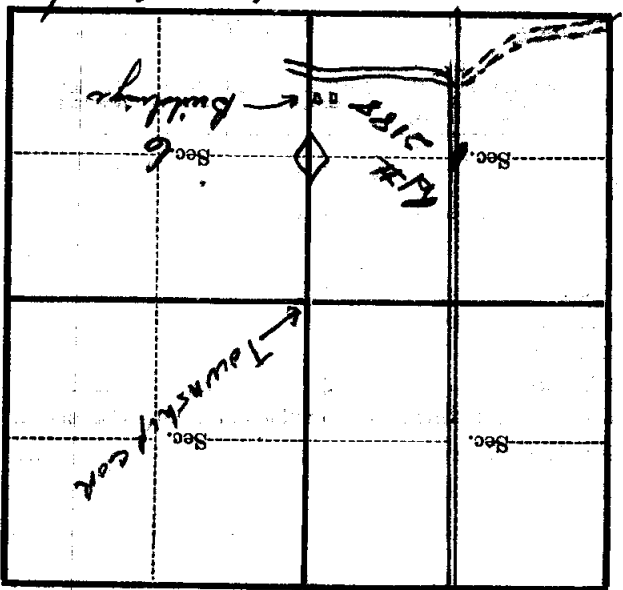

(Make sketch of topography near Corner)