

Form 874-9—Revised May, 1918  
 U. S. Department of Agriculture  
 FOREST SERVICE

E11

NATIONAL FOREST

CORNERS OF THE PUBLIC SURVEY

T. 147 R. 24 Mer.

Corner common to Sections  
4, 7, and 9

Corner consists of a \_\_\_\_\_ (not) in place  
 State condition \_\_\_\_\_

Dimensions above ground \_\_\_\_\_ inches  
 Sketch grooves, letters, figures, or notches, on proper face or edge.

CARDINAL POSITION

DIAGONAL POSITION

--	--	--	--

N W S E

--	--	--	--

NW SW SE NE

Mound of \_\_\_\_\_ is located \_\_\_\_\_

Pits are located \_\_\_\_\_

Sketch markings of Bearing Trees (or Rocks) in proper box and fill blanks below, giving bearings from Corner to Trees and Distances in Links.

BT	BT		

Species Paper Paper  
 Diameter 10" 12"  
 Bearing N 29 W S 84  
 Distance 98.5 129

Do you believe this to be a genuine Land Office Corner? No

If not, why? Confusion found and  
found. Bts were in Rd. Right of  
way  
3-7-58

P. Warner  
 (Signature)

1918  
 (Date)

(Title)

Corner again.

Give any further facts which will aid in finding this

chains distant.

from which this Corner bears

side of 2188

two inches diameter, on the *North*

Metal Location Poster is on a *post*

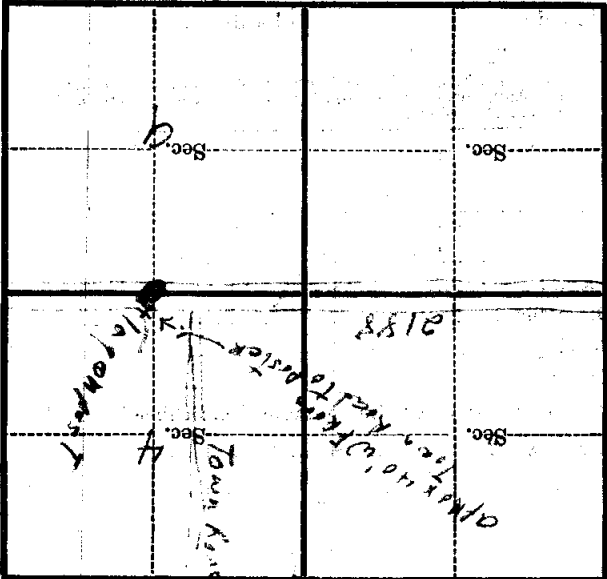

(Make sketch of topography near Corner)