

U. S. Department of Agriculture

FOREST SERVICE

V7

NATIONAL FOREST

CORNERS OF THE PUBLIC SURVEY

T. 147 R. 26 Mer.

1/4 Corner common to Sections

29, and 32

Corner consists of a sq post (not) in place

State condition good

Dimensions above ground 30 inches

Sketch grooves, letters, figures, or notches, on proper face or edge.

CARDINAL POSITION

DIAGONAL POSITION

--	--	--	--

N W S E

--	--	--	--

NW SW SE NE

Mound of is located

Pits are located

Sketch markings of Bearing Trees (or Rocks) in proper box and fill blanks below, giving bearings from Corner to Trees and Distances in Links.

Species

Diameter

Bearing

Distance

Do you believe this to be a genuine Land Office Corner? No

If not, why? No B.T.s could be found

(Signature)

8-26-58

(Date)

(Title)

Metal Location Poster is on a tree 7 inches diameter, on the side of from which this Corner bears 6 ft 5 in distant. Give any further facts which will aid in finding this Corner again.

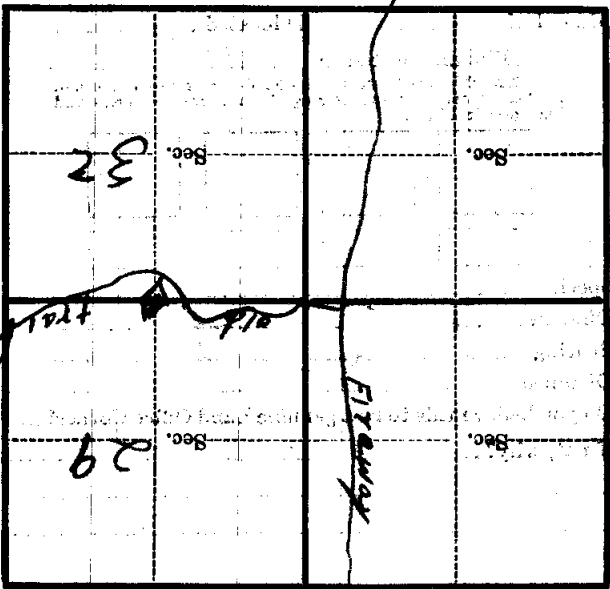

(Make sketch of topography near Corner)

T. 147 R. 21 Mer.