

U. S. Department of Agriculture

FOREST SERVICE

65

Chippewa NATIONAL FOREST

CORNERS OF THE PUBLIC SURVEY

T. 147 R. 26 54.1 Mer.

4 Corner common to Sections

7, and 8  
Corner consists of a 4x4 squared post (not) in place

State condition Fair

Dimensions above ground 34 inches

Sketch grooves, letters, figures, or notches, on proper face or edge.

CARDINAL POSITION

DIAGONAL POSITION

--	--	--	--

N W S E

--	--	--	--

NW SW SE NE

Mound of \_\_\_\_\_ is located \_\_\_\_\_

Pits are located \_\_\_\_\_

Sketch markings of Bearing Trees (or Rocks) in proper box and fill blanks below, giving bearings from Corner to Trees and Distances in Links.

Species \_\_\_\_\_

Diameter \_\_\_\_\_

Bearing \_\_\_\_\_

Distance \_\_\_\_\_

Do you believe this to be a genuine Land Office Corner? NO

If not, why? NO BYC FOUND

~~Signature~~

(Signature)

(Date)

(Title)

8-21-58

Corner again.  
 I placed here WEST  
 to Rd. Approx 5-55 ft

Give any further facts which will aid in finding this

~~chain distant.~~

from which this Corner bears  
 4 ft  
 side of tree

tree 5 inches diameter, on the WEST

Metal Location Poster is on a W. Pine

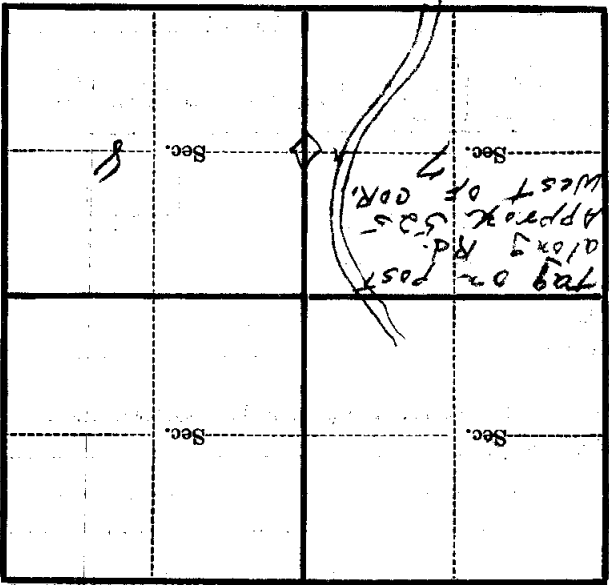

(Make sketch of topography near Corner)

T. 142 R. 06 Mer. 5