

U. S. DEPARTMENT OF AGRICULTURE
FOREST SERVICE

4
51

Minnesota NATIONAL FOREST

CORNERS OF THE PUBLIC SURVEY

T. 147 R. 26 Mer.

Sec. Corner common to Sections
17, 18, 19, and 20

DESCRIPTION OF CORNER

Corner consists of a Tam. 3" sq.

Dimension above ground 18" inches.

Sketch grooves, letters, figures, or notches, on proper face or edge.

CARDINAL POSITION

DIAGONAL POSITION

N	W	S	E

NW	SW	SE	NE

Mound of _____ is located _____

Pits are located _____

Sketch markings of Bearing Trees (or Rocks) in proper box and fill blanks below, giving bearings from Corner to Trees and Distances in Links.

			Dead

Species	<u>Spu</u>	<u>Spu</u>	<u>Cedar</u>	<u>Tam</u>
Diameter	<u>8"</u>	<u>8"</u>	<u>8"</u>	<u>10"</u>
Bearing	<u>N40W</u>	<u>S22W</u>	<u>S49E</u>	<u>N58E</u>
Distance	<u>11L</u>	<u>10L</u>	<u>12L</u>	<u>9L</u>

Do you believe this to be a genuine Land Office Corner? _____

If not, why? Yes

Geo Farley

Signature.

Aug 1923

Date.

Ranger

Title.

Metal Location Poster is on a _____
 tree _____ inches diameter, on the _____
 side of _____
 from which this Corner bears _____
 chains distant.
 Give any further facts which will aid in finding this
 Corner again.

<p>Sec. 19</p>	<p>Sec. 20</p>
<p>Sec. 18</p>	<p>Sec. 17</p>

(Make sketch of topography near Corner.)

Mer. 147 R. 26 3

U. S. Department of Agriculture
FOREST SERVICE

25

Chippewa NATIONAL FOREST
CORNERS OF THE PUBLIC SURVEY

T. 147 R. 26 S. 5 Mer.

Sec. _____ Corner common to Sections

17, 18, 19, and 20

Corner consists of a Cedar (not) in place

State condition New

Dimensions above ground 30" inches

Sketch grooves, letters, figures, or notches, on proper face or edge.

CARDINAL POSITION

DIAGONAL POSITION

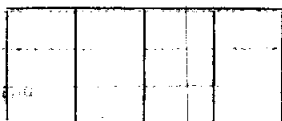
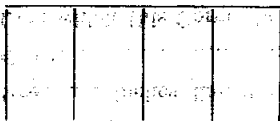

Mound of _____ is located _____

Pits are located _____

Sketch markings of Bearing Trees (or Rocks) in proper box and fill blanks below, giving bearings from Corner to Trees and Distances in Links.

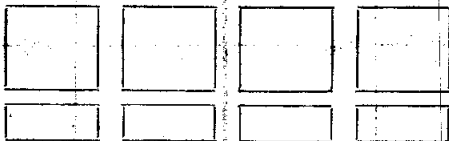

Species Cedar T-50 N-40 S-50 N-40 S-50

Diameter 6" 12" 12" 12"

Bearing S 48° E N 50° E N 40° W S 22° W

Distance 12 09 11 12

Do you believe this to be a genuine Land Office Corner? Yes

If not, why? _____

Balke
(Signature)

1937
(Date)

Leader
(Title)

69

BY C.C. CAMP
 S. SIDE OF GARAGE BUMP USED

Corner again.
 Give any further facts which will aid in finding this
 chains distant.
 from which this Corner bears
 side of
 tree inches diameter, on the
 Metal Location Poster is on a

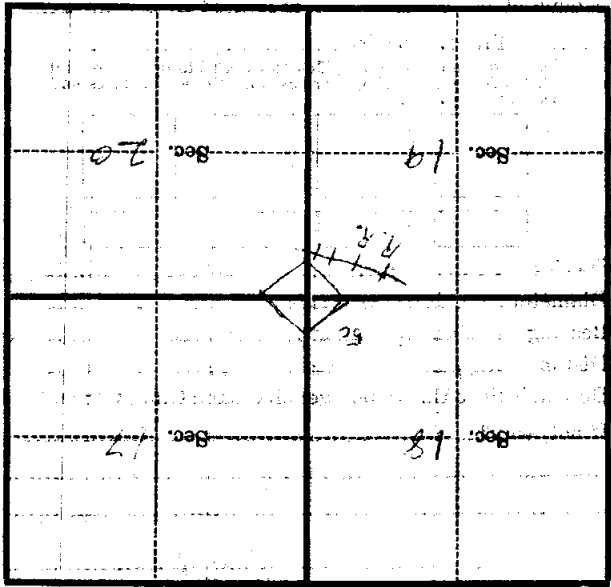

(Make sketch of topography near Corner)

T. 147 R. 26 Mer. 522

U. S. Department of Agriculture
FOREST SERVICE

2-5

Chippewa NATIONAL FOREST

CORNERS OF THE PUBLIC SURVEY

T. 147 R. 26 5th Mer.

Sec. Corner common to Sections
17, 18, 19, and 20

Corner consists of a Cedar (not) in place
State condition New

Dimensions above ground 30" inches

Sketch grooves, letters, figures, or notches, on proper face or edge.

CARDINAL POSITION

DIAGONAL POSITION

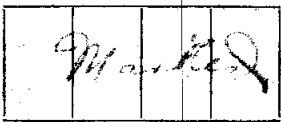
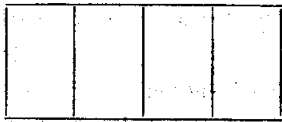

Mound of ~~_____~~ is located ~~_____~~

~~Pits are located _____~~

Sketch markings of Bearing Trees (or Rocks) in proper box and fill blanks below, giving bearings from Corner to Trees and Distances in Links.

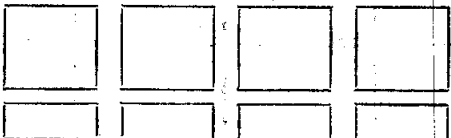

Species	<u>CEDAR</u>	<u>TAM. STUM^{HOLE}</u>	<u>SP. ST. HL^{HOLE}</u>	<u>SPRUCE STUM^{HOLE}</u>
Diameter	<u>6"</u>			
Bearing	<u>S. 48° E</u>	<u>N. 58° E</u>	<u>N. 40° W</u>	<u>S. 22° W</u>
Distance	<u>.12</u>	<u>.9</u>	<u>11</u>	<u>.12</u>

Do you believe this to be a genuine Land Office Corner? Yes

If not, why? _____

Balk
(Signature)

Leader
(Title)

(Date)

Corner again.
Corner is on South side
of Garbage dump used
by Inger and Camp -

Give any further facts which will aid in finding this
chains distant.
From which this Corner bears
side of
tree inches diameter, on the
Metal Location Poster is on a

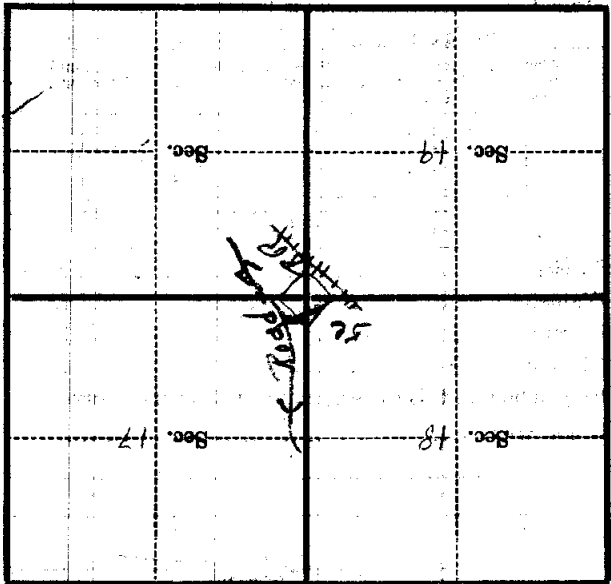

(Make sketch of topography near Corner)