

147-26

7-3

Chippewa NATIONAL FOREST

CORNERS OF THE PUBLIC SURVEY

T. 147 R. 26 5th Mer.

1/4 Corner common to Sections 6, and 31

Corner consists of a Tree (not) in place

State condition Good

Dimensions above ground 30 inches

Sketch grooves, letters, figures, or notches, on proper face or edge.

CARDINAL POSITION

DIAGONAL POSITION

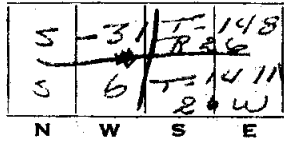

Mound of is located

Pits are located

Sketch markings of Bearing Trees (or Rocks) in proper box and fill blanks below, giving bearings from Corner to Trees and Distances in Links.

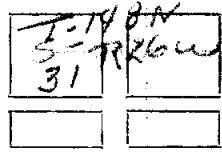
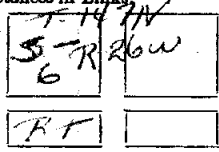

Species TAM. TAM. FALLIN

Diameter 5" 5"

Bearing S. 70° W N. 44° W

Distance .14 40

Do you believe this to be a genuine Land Office Corner? Yes

If not, why?

(Signature)

(Date)

(Title)

Corner is located at
76 - Top of stump -
and 77 - fallen -

Corner again.

Give any further facts which will aid in finding this

chains distant.

from which this Corner bears

side of

tree inches diameter, on the

Metal Location Poster is on a

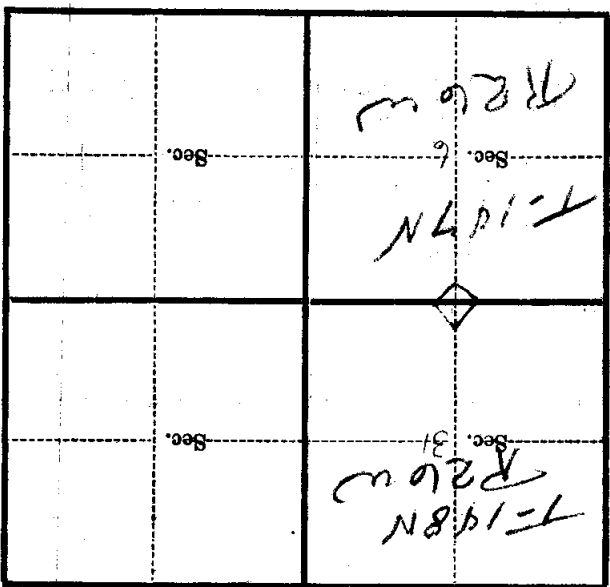

(Make sketch of topography near Corner)