

Form 874-S—Revised May, 1918
 U. S. Department of Agriculture
 FOREST SERVICE

R-3

Chippewa NATIONAL FOREST

CORNERS OF THE PUBLIC SURVEY

T. 147N R. 26W 512 Mer.

Quarter Corner common to Sections

19, and 30

Corner consists of a Cedar Post (not) in place

State condition Set New.

Dimensions above ground 36' inches

Sketch grooves, letters, figures, or notches, on proper face or edge.

CARDINAL POSITION

DIAGONAL POSITION

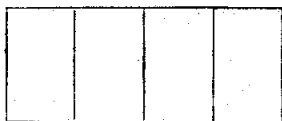

N W S E

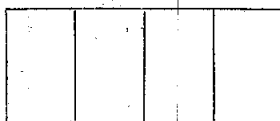

NW SW SE NE

Mound of _____ is located _____

Pits are located _____

Sketch markings of Bearing Trees (or Rocks) in proper box and fill blanks below, giving bearings from Corner to Trees and Distances in Links.

Mkd New B.Ts

<u>Orig B.T.</u> <u>1/4</u>	<u>1/4s</u> <u>19</u>	<u>1/4s</u> <u>30</u>	
	<u>B.T.</u>	<u>B.T.</u>	

Species 1 Pine Cedar Cedar

Diameter 20" 5" 5"

Bearing N50°W. N20°W. S48°W.

Distance 86 6 16 1/2

Do you believe this to be a genuine Land Office Corner? Y.

If not, why? _____

J. A. Gjelhaug

(Signature)

Jr. Civil Eng.

(Title)

7/20/36

(Date)

76

Corner again.

Give any further facts which will aid in finding this

0-16 1/2 chains distant.

from which this Corner bears N. 48° E.

side of Tree

tree 5 inches diameter, on the N.E.

Metal Location Poster is on a Cedar

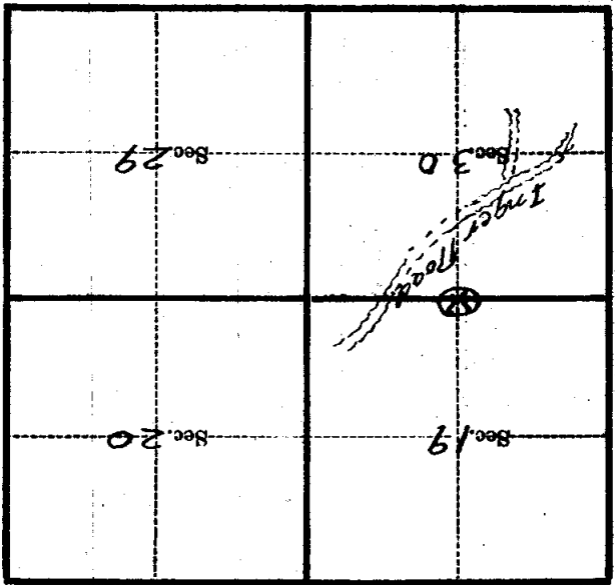

(Make sketch of topography near Corner)

T. 147N R. 26W 573 Mer.