

U. S. Department of Agriculture  
FOREST SERVICE

23

Chippewa NATIONAL FOREST  
CORNERS OF THE PUBLIC SURVEY

T. 146-47N R. 26W 59 Mer.

1/4 Corner common to Sections  
6, and 31

Corner consists of a 2" pipe with Brass cap in place

State condition \_\_\_\_\_

Dimensions above ground \_\_\_\_\_ inches.

Sketch grooves, letters, figures, or notches, on proper face or edge.

STONE CORNERS

METAL CORNERS

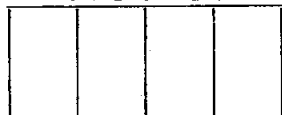

N W S E

Mound of \_\_\_\_\_ is located \_\_\_\_\_

Pits are located \_\_\_\_\_

Sketch markings of Bearing Trees (or Rocks) in proper box and fill blanks below, giving bearings from Corner to Trees and Distances in Links.

148
R-26
S-31
0219
BT

T148
R-26
S-31
NEW
BT

T147
R-26
S-6
NEW
BT

T148
R-26
S-31
NEW
BT

Species	TAM.	SPRUCE	TAM.	SPRUCE
Diameter	5" windfall	6"	6"	4"
Bearing	N44W	N42W	S3W	N67E
Distance	26.4'	9.2	15.6'	29.3'

Do you believe this to be a genuine Land Office Corner? YES  
If not, why? \_\_\_\_\_

Joseph F. Lausche  
(Signature)

10-28-58  
(Date)

ENGR. AID  
(Title)

T. 147-48N R. 26W  
 Mer. 5-27

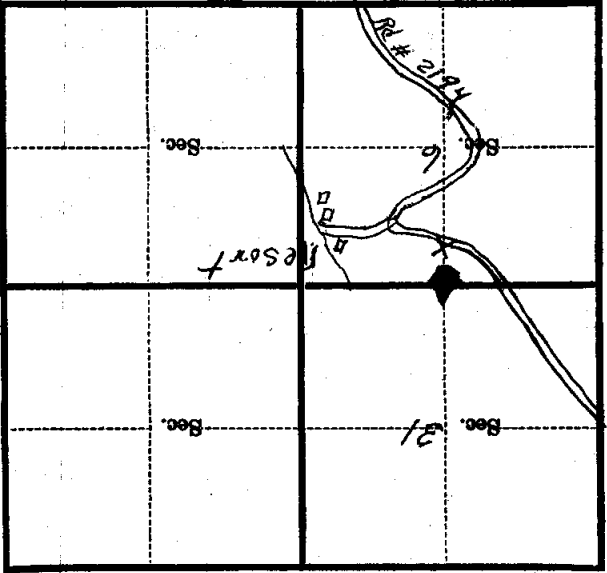

Metal Location Poster is on a Spruce tree 6 inches diameter, on the SE side of Tree from which this Corner bears S 42 E, 92' (Distance) 6 and 6 is on Section line marker between Secs. 6 and 31 on the Post on the 2194 (Tree, post, etc.) (Name of road, trail, etc.)

located 600 chains 1, 1/4, 1/2, 3/4, 1, 1 1/4, 2, 3, 4, 5, 6, 7, 8, from Sec. 6; 1/4 Cor.; 1/2 Cor.; 3/4 Cor.; 1 Cor. (Cross out nonapplicable) (Give any further facts needed to find Corner again: I blazed line south to RD # 2194 - 600 ft.)

Cor. is Approx 200 ft in Spruce Swamp.