

U. S. Department of Agriculture  
FOREST SERVICE

61

Chippewa NATIONAL FOREST  
CORNERS OF THE PUBLIC SURVEY

T. 147 R. 24 Mer.

Corner common to Sections  
7, 7, and 11

Corner consists of a Iron nail (not) in place

State condition Good

Dimensions above ground 21 inches

Sketch grooves, letters, figures, or notches, on proper face or edge.

CARDINAL POSITION

DIAGONAL POSITION

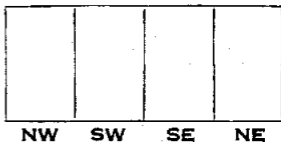
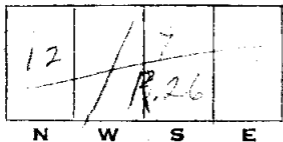

Mound of \_\_\_\_\_ is located \_\_\_\_\_

Pits are located \_\_\_\_\_

Sketch markings of Bearing Trees (or Rocks) in proper box and fill blanks below, giving bearings from Corner to Trees and Distances in Links.

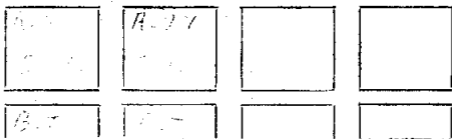

Species ...

Diameter 5"

Bearing ...

Distance 31 32

Do you believe this to be a genuine Land Office Corner? Yes

If not, why? \_\_\_\_\_

(Signature) [Signature]

(Date) 1918

(Title) [Title]

5-3

Corner again.

Give any further facts which will aid in finding this

chains distant.

from which this Corner bears

side of

tree inches diameter, on the

Metal Location Poster is on a

	Sec.		Sec.
	Sec.		Sec.

(Make sketch of topography near Corner)

T. 117 R. 26 Mer.

U. S. Department of Agriculture  
FOREST SERVICE

6-1

Chippewa NATIONAL FOREST

CORNERS OF THE PUBLIC SURVEY

T. 147 R. 26 5th Mer.

1/4 Corner common to Sections

7, and 12

Corner consists of a triangle (not) in place

State condition new

Dimensions above ground 2" - 28" inches

Sketch grooves, letters, figures, or notches, on proper face or edge.

CARDINAL POSITION

DIAGONAL POSITION

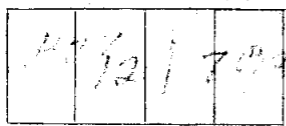

N W S E NW SW SE NE

Mound of \_\_\_\_\_ is located \_\_\_\_\_

Pits are located \_\_\_\_\_

Sketch markings of Bearing Trees (or Rocks) in proper box and fill blanks below, giving bearings from Corner to Trees and Distances in Links.

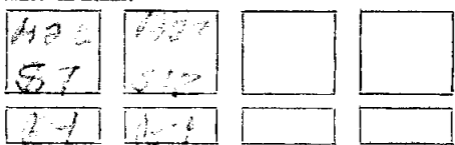

Species Spruce

Diameter 4

Bearing N 22° W

Distance 39

Do you believe this to be a genuine Land Office Corner? yes

If not, why? \_\_\_\_\_

(Signature)

(Date)

(Title)

34

Metal Location Poster is on a tree \_\_\_\_\_ inches diameter, on the \_\_\_\_\_ side of \_\_\_\_\_ from which this Corner bears \_\_\_\_\_ chains distant.

Give any further facts which will aid in finding this Corner again.

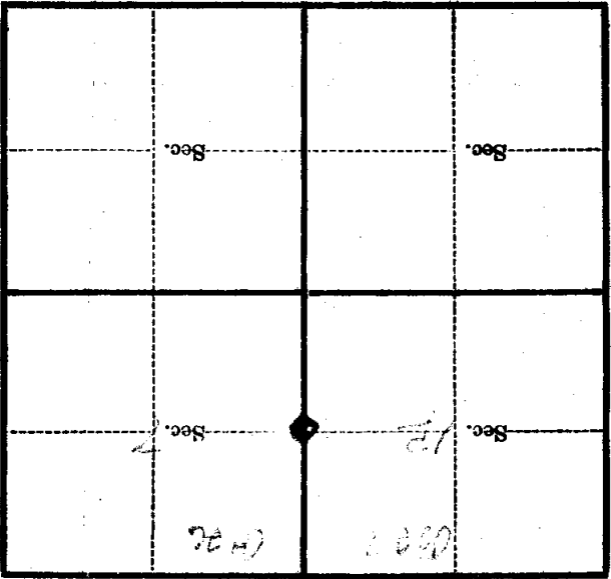

(Make sketch of topography near Corner)

T. M. R. Mer.

U. S. Department of Agriculture

FOREST SERVICE

Chippewa NATIONAL FOREST

CORNERS OF THE PUBLIC SURVEY

T. 147 R. 26 5<sup>th</sup> Mer.

1/4 Corner common to Sections 7, and 12

Corner consists of a Iron Pipe (not) in place

State condition Just Erected

Dimensions above ground 24 - 28 inches

Sketch grooves, letters, figures, or notches, on proper face or edge.

CARDINAL POSITION

DIAGONAL POSITION

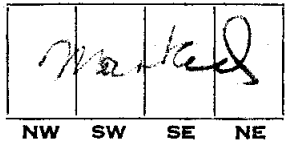
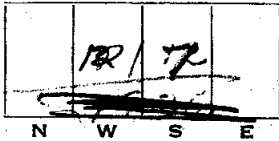

Mound of \_\_\_\_\_ is located \_\_\_\_\_

Pits are located \_\_\_\_\_

Sketch markings of Bearing Trees (or Rocks) in proper box and fill blanks below, giving bearings from Corner to Trees and Distances in Links.

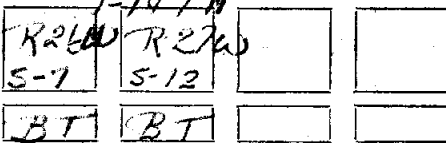

Species Spruce Spruce

Diameter 4" 5"

Bearing N57°E N-10°W

Distance 39 32

Do you believe this to be a genuine Land Office Corner? Yes

If not, why? \_\_\_\_\_

Balka (Signature)

1936 (Date)

\_\_\_\_\_ (Title)

Dotted lines for writing.

Corner again.

Give any further facts which will aid in finding this  
chains distant.  
from which this Corner bears  
side of  
tree inches diameter, on the  
Metal Location Poster is on a

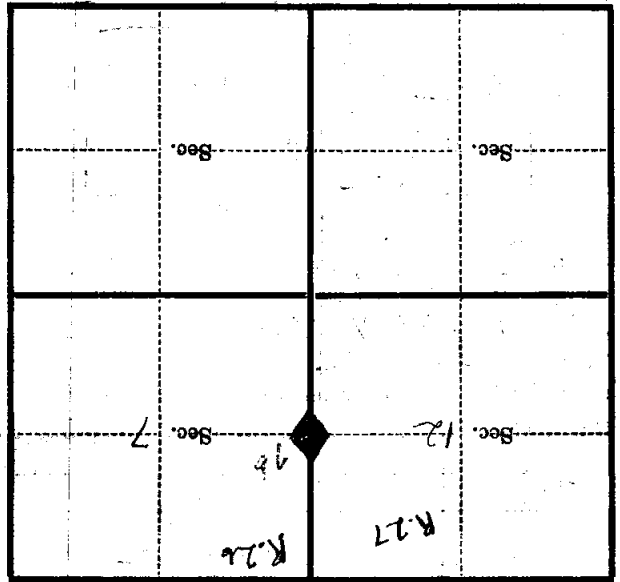

(Make sketch of topography near Corner)

U. S. Department of Agriculture  
FOREST SERVICE

G.1

*Chippewa* NATIONAL FOREST

CORNERS OF THE PUBLIC SURVEY

T. *147N* R. *26W* *5th* Mer.

*1/4* Corner common to Sections  
*7*, and *12*

Corner consists of a *iron pipe* (not) in place

State condition *new*

Dimensions above ground *2-28* inches

Sketch grooves, letters, figures, or notches, on proper face or edge.

CARDINAL POSITION

DIAGONAL POSITION

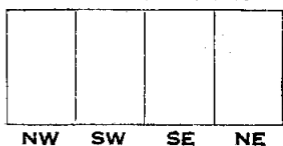
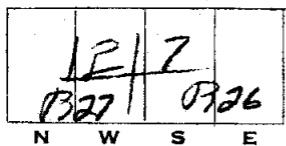

Mound of \_\_\_\_\_ is located \_\_\_\_\_

Pits are located \_\_\_\_\_

Sketch markings of Bearing Trees (or Rocks) in proper box and fill blanks below, giving bearings from Corner to Trees and Distances in Links.

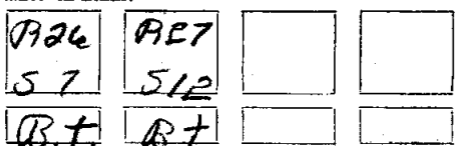

Species *Spruce Spruce*

Diameter *4 5*

Bearing *N57°E N10°W*

Distance *39 82*

Do you believe this to be a genuine Land Office Corner? *Yes*

If not, why? \_\_\_\_\_

(Signature)

(Date)

(Title)

53

Metal Location Poster is on a tree \_\_\_\_\_ inches diameter, on the \_\_\_\_\_ side of \_\_\_\_\_ from which this Corner bears \_\_\_\_\_ chains distant.

Give any further facts which will aid in finding this Corner again.

	Sec. _____		Sec. _____
	Sec. 7	Sec. 12	
326		327	

(Make sketch of topography near Corner)

T. HAIN R. 266  
 5 H  
 Mer.



U. S. Department of Agriculture  
FOREST SERVICE

9-1

Chippewa NATIONAL FOREST

CORNERS OF THE PUBLIC SURVEY

T. 147N R. 26W 5th Mer.

1/4 Corner common to Sections  
7, and 12

Corner consists of a iron pipe (not) in place

State condition new

Dimensions above ground 2-28 inches

Sketch grooves, letters, figures, or notches, on proper face or edge.

CARDINAL POSITION

DIAGONAL POSITION

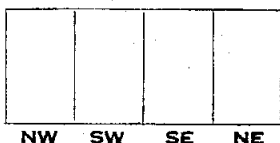
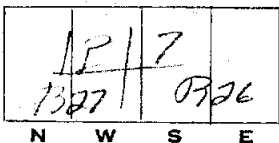

Mound of \_\_\_\_\_ is located \_\_\_\_\_

Pits are located \_\_\_\_\_

Sketch markings of Bearing Trees (or Rocks) in proper box and fill blanks below, giving bearings from Corner to Trees and Distances in Links.

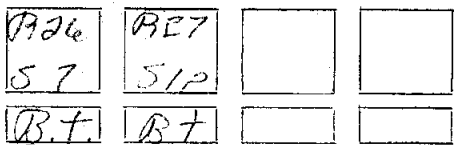

Species Spruce Spruce

Diameter 7 5

Bearing N57°W N10°W

Distance 39 52

Do you believe this to be a genuine Land Office Corner? *ya*

If not, why? \_\_\_\_\_

(Signature)

(Date)

(Title)

53

Metal Location Poster is on a tree \_\_\_\_\_ inches diameter, on the \_\_\_\_\_ side of \_\_\_\_\_ from which this Corner bears \_\_\_\_\_ chains distant.  
 Give any further facts which will aid in finding this Corner again.

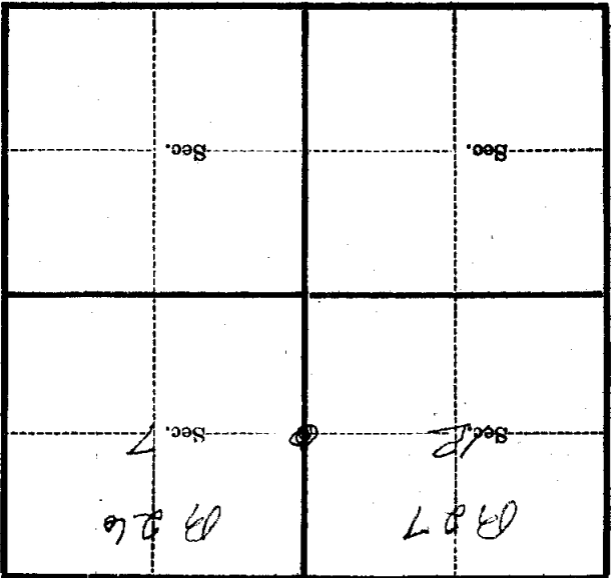

(Make sketch of topography near Corner)

T. H. N. R. 260  
 Mer. 574