

U. S. Department of Agriculture  
FOREST SERVICE

51

Chippewa NATIONAL FOREST

CORNERS OF THE PUBLIC SURVEY

T. 147 R. 26 S. 5<sup>th</sup> Mer.

Sec. Corner common to Sections  
12, 13, 7, and 19.

Corner consists of a CAP IN CEMENT (not) in place  
State condition new

Dimensions above ground 6-24-20 inches

Sketch grooves, letters, figures, or notches, on proper face or edge.

CARDINAL POSITION

DIAGONAL POSITION

T. 147			R. 26
R. 27	S. 12	S. 7	
	S. 13	S. 19	
N	W	S	E

NW	SW	SE	NE

Mound of \_\_\_\_\_ is located \_\_\_\_\_

Pits are located \_\_\_\_\_

Sketch markings of Bearing Trees (or Rocks) in proper box and fill blanks below, giving bearings from Corner to Trees and Distances in Links.

		T. 147 R. 26 S. 19	T. 147 R. 27 S. 13
		B. T.	B. T.

Species	N. P.	N. P.	S. P.	W. P.
Diameter	36"	36"	10"	14"
Bearing	N. 60° E	N. 57° W	S. 82° E	S. 24° W
Distance	1.14	32	.27	.54

Do you believe this to be a genuine Land Office Corner? Yes  
If not, why? \_\_\_\_\_

B. alke

(Signature)

Leader

(Title)

1937

(Date)

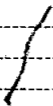

Corner again.

Give any further facts which will aid in finding this

chains distant.

from which this Corner bears

side of

tree inches diameter, on the

Metal Location Poster is on a

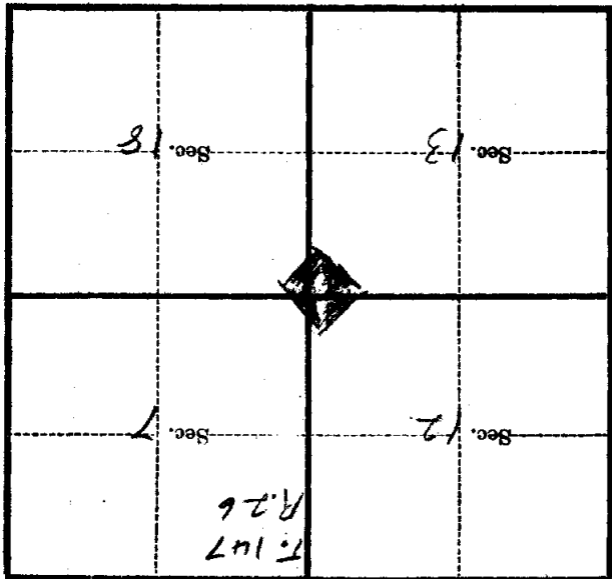

(Make sketch of topography near Corner)

T. 147 R. 26 5-25 Mer.

U. S. Department of Agriculture  
FOREST SERVICE

J-1

Chippewa NATIONAL FOREST

CORNERS OF THE PUBLIC SURVEY

T. 147 R. 26 5<sup>th</sup> Mer.  
Sec. Corner common to Sections

12, 13, 7, and 18

Corner consists of a Brass by an Cement (not) in place

State condition Just Erected

Dimensions above ground 6-24-20 inches

Sketch grooves, letters, figures, or notches, on proper face or edge.

CARDINAL POSITION

DIAGONAL POSITION

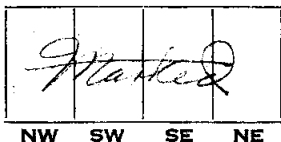
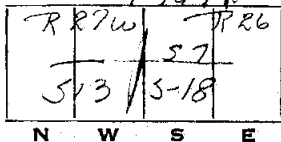

Mound of \_\_\_\_\_ is located \_\_\_\_\_

Pits are located \_\_\_\_\_

Sketch markings of Bearing Trees (or Rocks) in proper box and fill blanks below, giving bearings from Corner to Trees and Distances in Links.

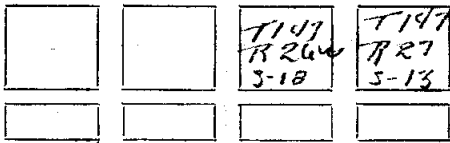

Species N.P. Pine N.P. J.P. W.P.  
Diameter 36" 36" 10" 14"  
Bearing N 66° E N 57 1/2° W S 82 1/2° E S 84° W  
Distance 1.14 3.2 27 54

Do you believe this to be a genuine Land Office Corner? Yes  
If not, why? \_\_\_\_\_

Balke  
(Signature)  
Leader  
(Title)

1937  
(Date)

Metal Location Poster is on a tree \_\_\_\_\_ inches diameter, on the side of \_\_\_\_\_ from which this Corner bears \_\_\_\_\_ chains distant.

Give any further facts which will aid in finding this Corner again.

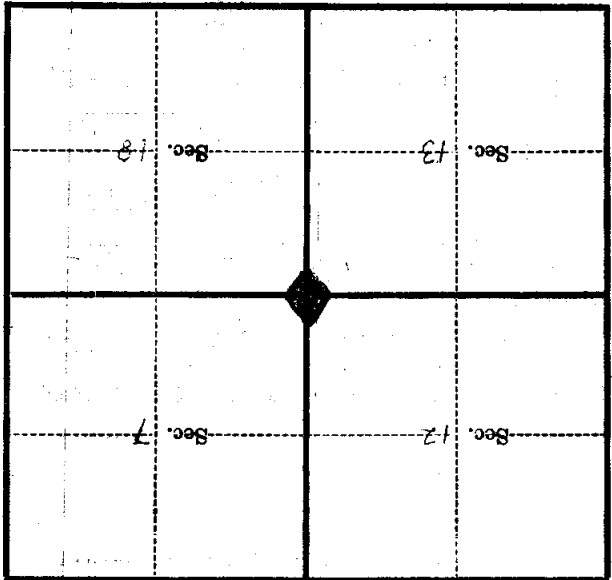

(Make sketch of topography near Corner)

T. 147N R. 26W Mer.

U. S. Department of Agriculture  
FOREST SERVICE

J-1

CHIPPENAW NATIONAL FOREST

CORNERS OF THE PUBLIC SURVEY

T. 147 R. 26 5<sup>th</sup> Mer.  
Sec. Corner common to Sections  
12, 13, 7, and 18

Corner consists of a CAP IN CEMENT (not) in place  
State condition new

Dimensions above ground 6-24-20 inches  
Sketch grooves, letters, figures, or notches, on proper face or edge.

			R.26
R.27	S.12	S.7	
	S.13	S.18	
N	W	S	E

NW	SW	SE	NE

Mound of \_\_\_\_\_ is located \_\_\_\_\_

Pits are located \_\_\_\_\_

Sketch markings of Bearing Trees (or Rocks) in proper box and fill blanks below, giving bearings from Corner to Trees and Distances in Links.

		T.147 R.26 S.18	T.147 R.27 S.13
		B.T	B.T

Species	<u>N.P.</u>	<u>N.P.</u>	<u>S.P.</u>	<u>W.P.</u>
Diameter	<u>36"</u>	<u>36"</u>	<u>10"</u>	<u>10"</u>
Bearing	<u>N.57°E</u>	<u>N.57°W</u>	<u>S.82°E</u>	<u>S.24°W</u>
Distance	<u>1.14</u>	<u>32</u>	<u>.27</u>	<u>.54</u>

Do you believe this to be a genuine Land Office Corner? YES

If not, why? \_\_\_\_\_

B. Baker

(Signature)

1937

(Date)

Leader

(Title)

Metal Location Poster is on a tree inches diameter, on the side of from which this Corner bears chains distant.

Give any further facts which will aid in finding this Corner again.

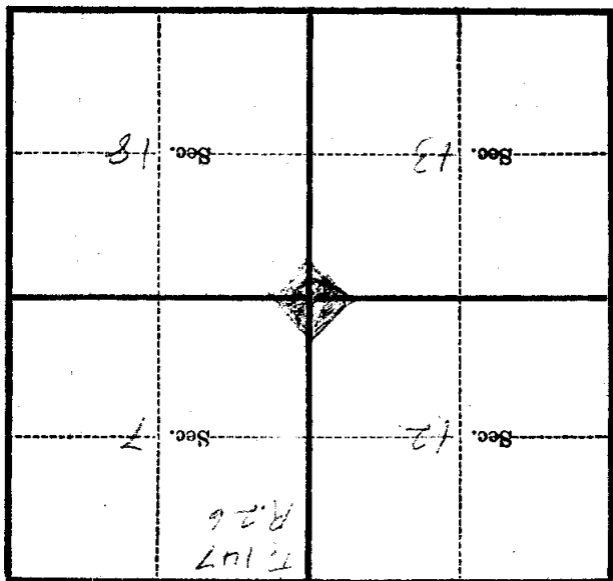

(Make sketch of topography near Corner)

T. 147 R. 26 Mer. 5-25