

U. S. Department of Agriculture

FOREST SERVICE

posted 57

CHIPPEWA NATIONAL FOREST

CORNERS OF THE PUBLIC SURVEY

T. *147* R. *25* S. Mer.

1/4 Corner common to Sections

8, and *17*

Corner consists of a _____ (not) in place

State condition _____

Dimensions above ground _____ inches.

Sketch grooves, letters, figures, or notches, on proper face or edge.

CARDINAL POSITION

DIAGONAL POSITION

--	--	--	--

--	--	--	--

N W S E

NW SW SE NE

Mound of _____ is located _____

_____ Pits are located _____

Sketch markings of Bearing Trees (or Rocks) in proper box and fill blanks below, giving bearings from Corner to Trees and Distances in Links.

<i>1/4</i> <i>58</i>			
-------------------------	--	--	--

<i>BT</i>			
-----------	--	--	--

Species *WP Road Stump*

Diameter *16"*

Bearing _____

Distance _____

Do you believe this to be a genuine Land Office Corner? _____

If not, why? *Resurvey corner*

Paul J. Stewart

(Signature)

11-28-33

(Date)

Chief of Party

(Title)

Corner again. *Map corner marked Aug 13*

Give any further facts which will aid in finding this
 chains distant.

from which this Corner bears
 side of

Metal Location Poster is on a *Talghum Pole*
 tree inches diameter, on the *N 51 5/8 W*
side of road

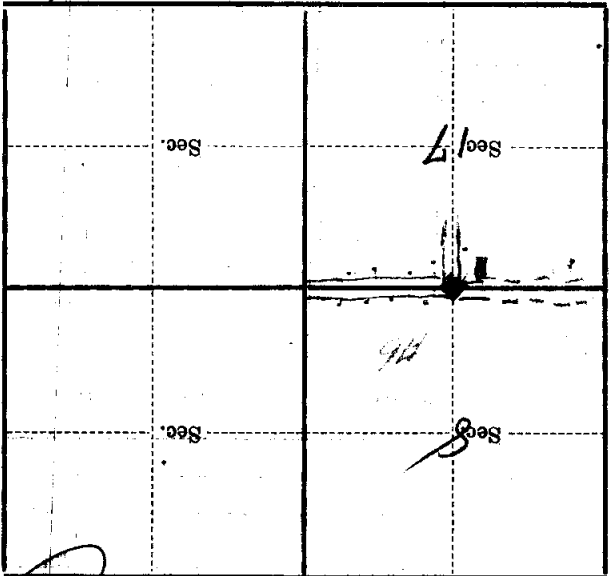

(Make sketch of topography near Corner)

T. 147 R. 25
 5
 Mer