

U. S. Department of Agriculture
FOREST SERVICE

V-16 V16

Chippewa NATIONAL FOREST
CORNERS OF THE PUBLIC SURVEY

T. 146 R. 31 5th Mer.
East 1/16 Corner common to Sections
27, and 34

Corner consists of a Brass capped pipe (not) in place
State condition good

Dimensions above ground 8 inches

Sketch grooves, letters, figures, or notches, on proper face or edge.
CARDINAL POSITION DIAGONAL POSITION



Mound of _____ is located _____

Pits are located _____

Sketch markings of Bearing Trees (or Rocks) in proper box and
fill blanks below, giving bearings from Corner to Trees and
Distances in Links.

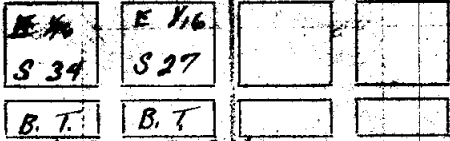

Species N. P. R. Oak.

Diameter 12" 7"

Bearing S 39° 45' W. N 72° W

Distance 18 29

Do you believe this to be a genuine Land Office Corner? Yes
If not, why? _____

Carl Steadland

3/19/35
(Date)

J. E. A.
(Title)

V-16

U. S. Department of Agriculture

V-16

NATIONAL FOREST

CORNERS OF THE PUBLIC SURVEY

T. R. M...
Other corners to sections

Other corners of a... (not in place)
Corner again.

Give any further facts which will aid in finding this
Dimensions above ground

from which this corner bears
CARDINAL POSITION
N... S... E... W...
NE SW SE NW

tree
inches diameter, on the
side of
M... S... E... W...
NE SW SE NW

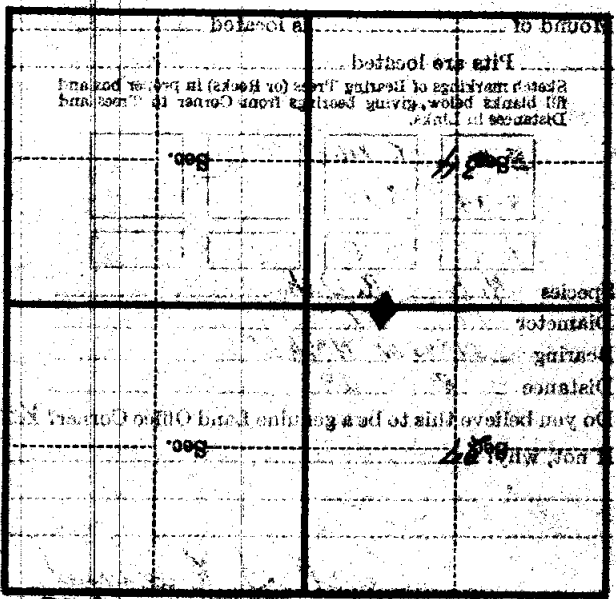

V-16

(Make sketch of topography, trees, corners)