

U. S. Department of Agriculture  
FOREST SERVICE

M-13

NATIONAL FOREST

CORNERS OF THE PUBLIC SURVEY

T. 14<sup>1</sup> R. 31 Mer. 5

S 7/16<sup>1</sup> Corner common to Sections  
16, 15, and

Corner consists of a pipe & Brass cap (not) in place  
State condition Good

Dimensions above ground 8" inches

Sketch grooves, letters, figures, or notches, on proper face or edge.

CARDINAL POSITION

DIAGONAL POSITION

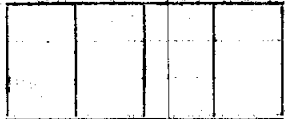
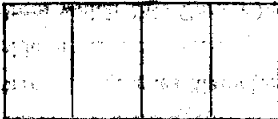

Mound of \_\_\_\_\_ is located \_\_\_\_\_

Pits are located \_\_\_\_\_

Sketch markings of Bearing Trees (or Rocks) in proper box and fill blanks below, giving bearings from Corner to Trees and Distances in Links.



See 1/6 See 1/6

Species S. PINE K. PINE

Diameter 11" 8"

Bearing N 62° E S 56° W

Distance 5.750 chs 4.055 chs

Do you believe this to be a genuine Land Office Corner?

If not, why? Yes

Bob Grille  
(Signature)

2/27/35  
(Date)

M-13

W-1  
UNITED STATES DEPARTMENT OF THE INTERIOR  
BUREAU OF LAND MANAGEMENT

COMPLETION OF THE SURVEY

1. Name of the landowner

2. Name of the surveyor

3. Date of survey

4. Name of the person who made the map

5. Name of the person who made the plat

6. Name of the person who made the certificate

7. Name of the person who made the plat

8. Name of the person who made the certificate

9. Name of the person who made the plat

10. Name of the person who made the certificate

11. Name of the person who made the plat

12. Name of the person who made the certificate

13. Name of the person who made the plat

14. Name of the person who made the certificate

15. Name of the person who made the plat

16. Name of the person who made the certificate

17. Name of the person who made the plat

18. Name of the person who made the certificate

19. Name of the person who made the plat

20. Name of the person who made the certificate

21. Name of the person who made the plat

22. Name of the person who made the certificate

23. Name of the person who made the plat

24. Name of the person who made the certificate

25. Name of the person who made the plat

26. Name of the person who made the certificate

27. Name of the person who made the plat

28. Name of the person who made the certificate

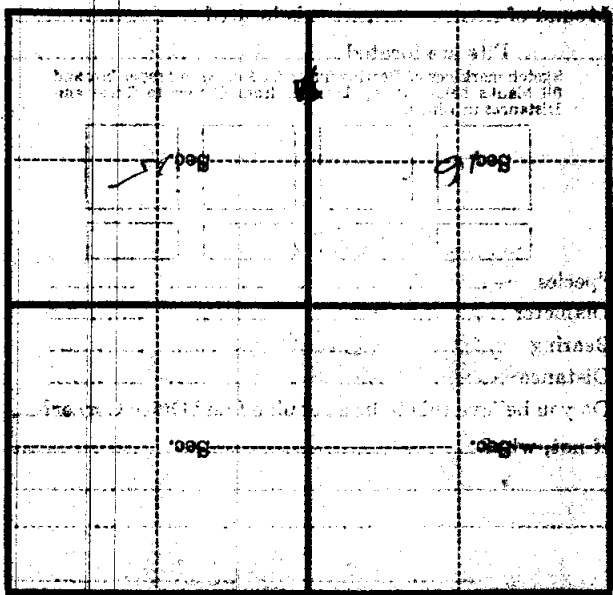

(Make sketch of topography near Corner)

W-1  
R 31  
T 16 S 1

U. S. Department of Agriculture  
FOREST SERVICE

P  
36  
M-13 M113

Chippewa NATIONAL FOREST

CORNERS OF THE PUBLIC SURVEY

T. 146 R. 31 S. 46 Mer.

Corner common to Sections  
15, and 16

Corner consists of a Y L O (not) in place

State condition Good

Dimensions above ground 8 inches

Sketch grooves, letters, figures, or notches, on proper face or edge.

CARDINAL POSITION

DIAGONAL POSITION

--	--	--	--

--	--	--	--

N W S E

NW SW SE NE

Mound of \_\_\_\_\_ is located \_\_\_\_\_

Pits are located \_\_\_\_\_

Sketch markings of Bearing Trees (or Rocks) in proper box and fill blanks below, giving bearings from Corner to Trees and Distances in Links.

T 146  
R- 31  
S- 46

T 146  
R- 31  
S- 16

B T

B T

Species J. P. Pine N. P. M.

Diameter 11 8'

Bearing N 62 E S 56 W

Distance 5.74 4. Ch

Do you believe this to be a genuine Land Office Corner? Yes

If not, why? \_\_\_\_\_

Smith  
(Signature)

3/27/35  
(Date)

U.S. Department of Agriculture

FOREST SERVICE

NATIONAL FOREST

CORNERS OF THE PUBLIC SURVEY

Corner of section 16, T. 122 N., R. 3 E., S. 13

Corner again.

Give any further facts which will aid in finding this

chain of posts.

from which this corner bears

side of

tree inches diameter, on the

Metal Location Poster is on a

N W S E NW SW SE NE

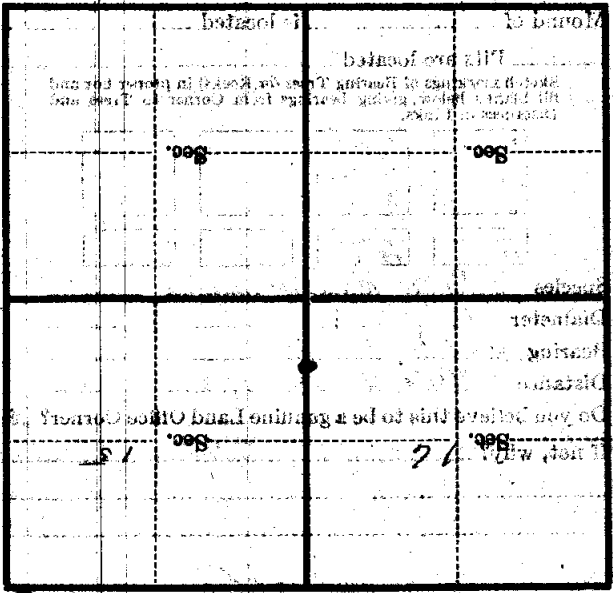

(State sketch of topographic corner)

M-13

NOT

M-13

3/1

R.

T. 122 N.

S. 13