

U. S. Department of Agriculture
FOREST SERVICE

N 9 N-9

NATIONAL FOREST

CORNERS OF THE PUBLIC SURVEY

T. 146 R. 31 S Mer.

SECTION 11 Corner common to Sections
17, 16, 20, and 21

Corner consists of a Cement Post (not) in place
State condition Good

Dimensions above ground 2" Below inches

Sketch grooves, letters, figures, or notches, on proper face or edge.

CARDINAL POSITION

DIAGONAL POSITION

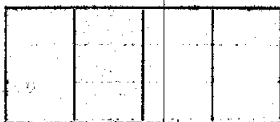
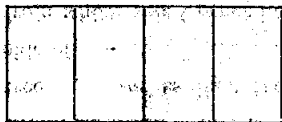

N W S E

NW SW SE NE

Mound of _____ is located _____

Pits are located _____

Sketch markings of Bearing Trees (or Rocks) in proper box and fill blanks below, giving bearings from Corner to Trees and Distances in Links.



Species N. Pine N. Pine N. Pine

Diameter 4.5 5.0 6"

Bearing S. 74° E N. 77° 30' E N. 75° W

Distance 144 2.15 74

Do you believe this to be a genuine Land Office Corner? _____

If not, why? Yes

Guil

(Signature)

3/24/35
(Date)

N-2
N-9

U.S. DEPARTMENT OF AGRICULTURE

FOREST SERVICE

NATIONAL FOREST

CORNERS OF THE PUBLIC SURVEY

Section 17, Township 14N, Range 14W, T14N, R14W

Corner consists of a wood stake (not in place)

Give any further facts which will aid in finding this corner.

Corner distant

from which this corner bears

inches diameter, on the

side of

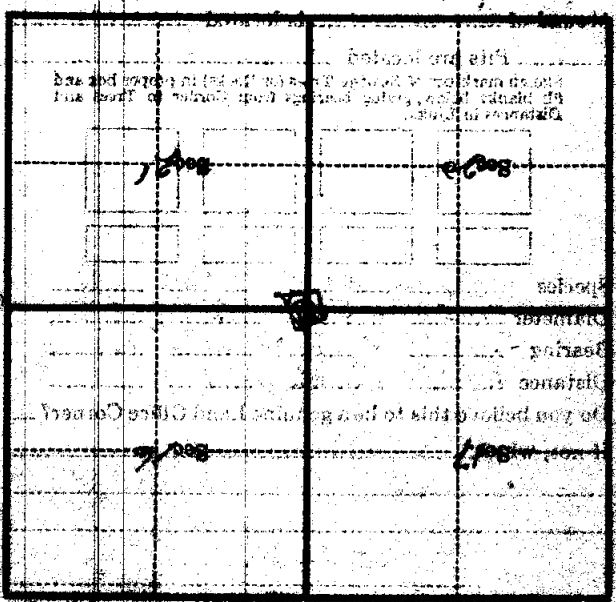

Make sketch of topography near corner

Form 874-9—Revised May, 1918
U. S. Department of Agriculture
FOREST SERVICE

Copies
Posted
N-9/36N9

Chippewa NATIONAL FOREST

CORNERS OF THE PUBLIC SURVEY

T. 176 R. 31 5th Mer.

Section Corner common to Sections
16, 17, 20, and 21

Corner consists of a Y L O (nat.) in place
State condition Good

Dimensions above ground Underground inches
Sketch grooves, letters, figures, or notches, on proper face or edge.
CARDINAL POSITION DIAGONAL POSITION

N	W	S	E

NW	SW	SE	NE

Mound of _____ is located _____

Pits are located _____

Sketch markings of Bearing Trees (or Rocks) in proper box and fill blanks below, giving bearings from Corner to Trees and Distances in Links.

Species N. Pine N. Pine N. Pine

Diameter 7" 5" 6"

Bearing S. 74 E N. 77 E N. 73 W

Distance 1.44 ch 2.14 ch 1.74 ch

Do you believe this to be a genuine Land Office Corner? Y

If not, why? _____

Y. Mill
(Signature)

3/24/35
(Date)

(Title)

N-9

Metal Location Poster is on a tree inches diameter, on the side of from which this Corner bears chains distant. Give any further facts which will aid in finding this Corner again.

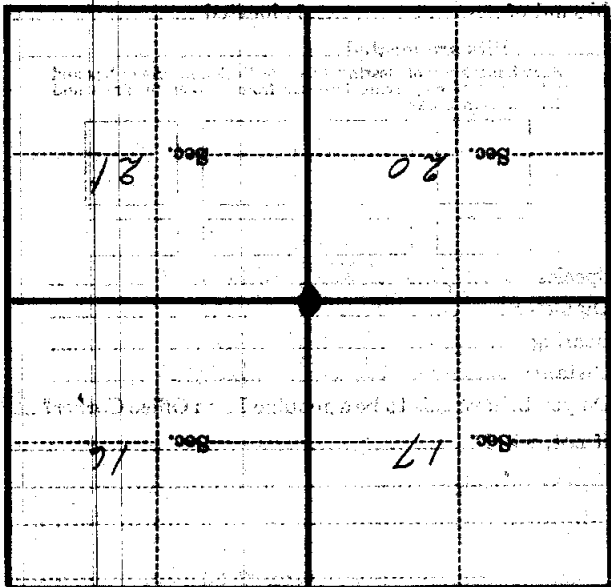

(Make sketch of topography near Corner)

N-9

T. 176 R. 31

5-14-51