

U. S. Department of Agriculture
FOREST SERVICE

*Copied
Pasted
5/31*

H-1

Chippewa

NATIONAL FOREST

CORNERS OF THE PUBLIC SURVEY

T. *146* R. *31-32* *5th* Mer.

S 46 Corner common to Sections
7-146-31, 4, 12-146-32
and

Corner consists of a *iron pipe* (not) in place
State condition *Good*

Dimensions above ground *4* inches

Sketch grooves, letters, figures, or notches, on proper face or edge.

CARDINAL POSITION

DIAGONAL POSITION

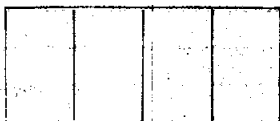

Mound of _____ is located _____

Pits are located _____

Sketch markings of Bearing Trees (or Rocks) in proper box and fill blanks below, giving bearings from Corner to Trees and Distances in Links.

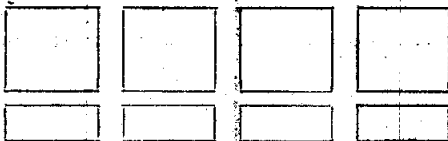

Species _____

Diameter _____

Bearing _____

Distance _____

Do you believe this to be a genuine Land Office Corner? _____

If not, why? *No trees or features*

wooden stake beside pipe

J. Murphy
(Signature)

4/11/36
(Date)

(Title)

H-1

Metal Location Poster is on a
 tree inches diameter, on the
 side of
 from which this Corner bears
 chains distant.
 Give any further facts which will aid in finding this
 Corner again.

	Sec.		Sec.
	Sec.	12	Sec.
		146-32	
		146-31	

(Please sketch of topography near Corner)

1176 B. 31-32
 5
 M. 1
 N-1

U. S. Department of Agriculture
FOREST SERVICE

36

H-1 H 1

Cheffewa NATIONAL FOREST

CORNERS OF THE PUBLIC SURVEY

T. *146* R. *31-32* *5th* Mer.

S 1/2

Corner common to Sections

7-146-31, and *12-146-32*

Corner consists of a *iron pipe* (not) in place

State condition *Good*

Dimensions above ground *4"* inches

Sketch grooves, letters, figures, or notches, on proper face or edge.

CARDINAL POSITION

DIAGONAL POSITION

--	--	--	--

--	--	--	--

N W S E

NW SW SE NE

Mound of _____ is located _____

Pits are located _____

Sketch markings of Bearing Trees (or Rocks) in proper box and fill blanks below, giving bearings from Corner to Trees and Distances in Links.

Species _____

Diameter _____

Bearing _____

Distance _____

Do you believe this to be a genuine Land Office Corner? _____

If not, why? _____

*No bearing trees or features
marked. Stake inside pipe*

[Signature]

4/10/35
(Date)

(Title)

H-1

Form 974-3- Revised May, 1915

U. S. Department of Agriculture

FOREST SERVICE

NATIONAL FOREST

CORNERS OF THE PUBLIC SURVEY

Township R. 31 N. Range 32 E. Mer. Corner corner to section

Corner consists of a ... Corner again.

Give any further facts which will aid in finding this ... chains diameter.

from which this Corner bears ... side of

tree inches diameter, on the

Metal Location Poster is on a

H W E NW SW SE NE

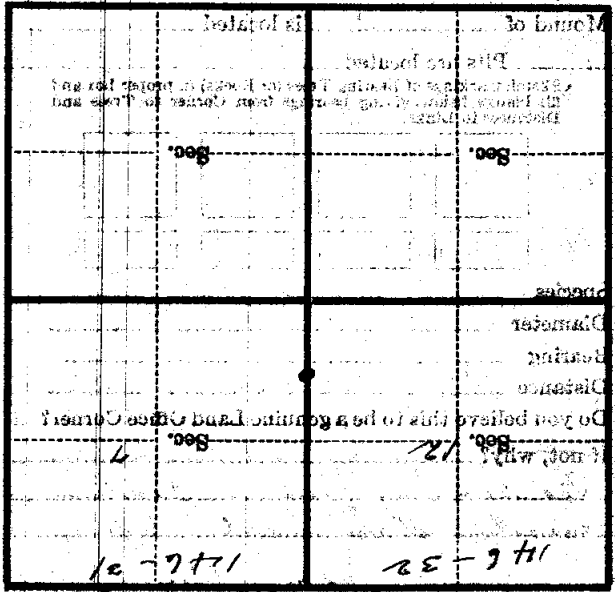

(Make sketch of topography at Corner)

T. 146 N. R. 31-32 (Township) Mer. H-1

U. S. Department of Agriculture
FOREST SERVICE

H-1

NATIONAL FOREST

CORNERS OF THE PUBLIC SURVEY

T. 146 R. 31-32 Mer. Corner common to Sections

7, and 12
Corner consists of a *single post* (set) in place
State condition *Good*

Dimensions above ground *4"* inches

Sketch grooves, letters, figures, or notches, on proper face or edge.

CARDINAL POSITION

DIAGONAL POSITION



N W S E

NW SW SE NE

Mound of is located

Pits are located

Sketch markings of Bearing Trees (or Rocks) in proper box and fill blanks below, giving bearings from Corner to Trees and Distances in Links.

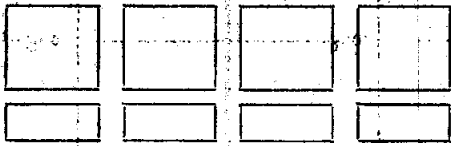

Species

Diameter

Bearing

Distance

Do you believe this to be a genuine Land Office Corner?

If not, why?

No bearing trees or rocks were observed. I believe this is a genuine corner.
J. T. Murphy
(Signature)

4/11/32 (Date)

E

(Type)

H-1
H-1

1-1

Handwritten notes and signatures, including 'H. J. Jones' and 'N. S. Smith'.

Give any further facts which will aid in finding this
chain's distant
from which this Corner bears
side of
tree inches diameter, on the
Metal Location Poster is on a

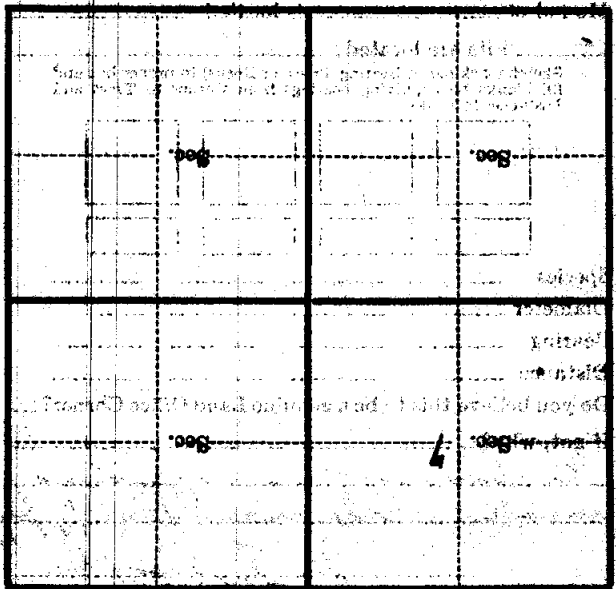

(Make sketch of topography near Corner)

H-1
H-Mer
R
1/11/36
3-1304