

Form 874-9—Revised May, 1918  
 U. S. Department of Agriculture  
 FOREST SERVICE

V-20

Chippewa NATIONAL FOREST

CORNERS OF THE PUBLIC SURVEY

T. 146 N R. 80 W 5th Mer.  
 E 1/16 Corner common to Sections

35, and 26  
 Corner consists of a metal cap (not) in place  
 State condition good

Dimensions above ground 3 inches  
 Sketch grooves, letters, figures, or notches, on proper face or edge.

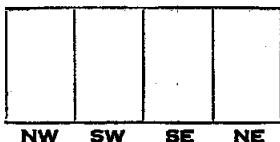
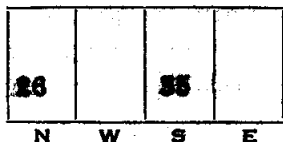

Mound of \_\_\_\_\_ is located \_\_\_\_\_

Pits are located \_\_\_\_\_

Sketch markings of Bearing Trees (or Rocks) in proper box and fill blanks below, giving bearings from Corner to Trees and Distances in Links.

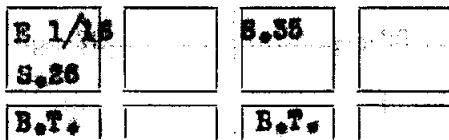

Species J. P. \_\_\_\_\_ J. P. \_\_\_\_\_  
 Diameter 8" \_\_\_\_\_ 8" \_\_\_\_\_  
 Bearing N 31 E \_\_\_\_\_ S 45 E \_\_\_\_\_  
 Distance 1.74 ch. \_\_\_\_\_ 18.4 ch. \_\_\_\_\_

Do you believe this to be a genuine Land Office Corner? **Y**  
 If not, why? \_\_\_\_\_

Harold Hennes  
 (Signature)

Jan. 15, 1937  
 (Date)

(Title)

V-20

V-50

# CORNER OF THE PUBLIC SURVEY

Corner located in **THURGOOD**

Give any further facts which will aid in finding this

chain distant

from which this Corner bears

side of

tree inches diameter, on the

Metal Location Poster is on a

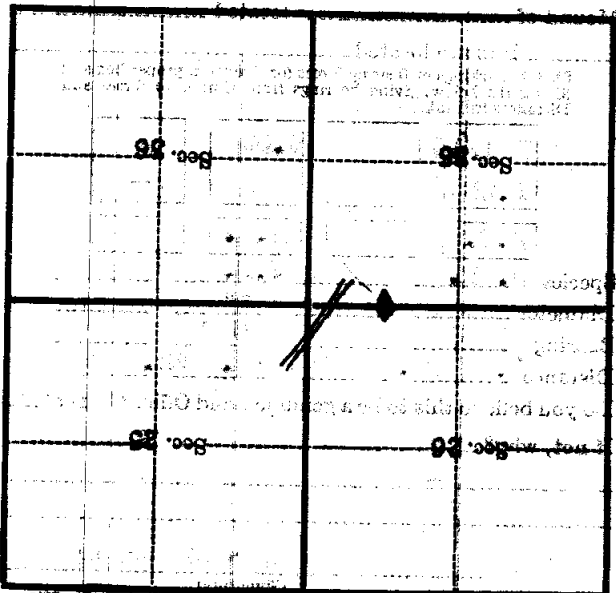

(Make sketch of topography near Corner)