

V-W-5

Form 874-9—Revised May, 1918

U. S. Department of Agriculture

FOREST SERVICE

~~Clippan~~ NATIONAL FOREST

CORNERS OF THE PUBLIC SURVEY

T. 146 R. 29 8th Mer.

~~Header~~ Corner common to Sections  
31, and 32

Corner consists of a Brass cap (not) in place  
State condition good

Dimensions above ground 7 inches

Sketch grooves, letters, figures, or notches, on proper face or edge.

CARDINAL POSITION

DIAGONAL POSITION

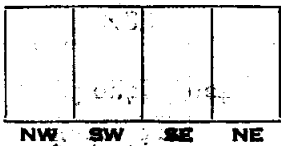
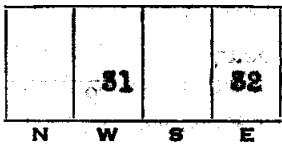

Mound of \_\_\_\_\_ is located \_\_\_\_\_

Pits are located \_\_\_\_\_

Sketch markings of Bearing Trees (or Rocks) in proper box and fill blanks below, giving bearings from Corner to Trees and Distances in Links.

|              |  |
|--------------|--|
| T. 146N      |  |
| R. 29W       |  |
| <u>S. 31</u> |  |



|              |  |
|--------------|--|
| T. 146N      |  |
| R. 29W       |  |
| <u>S. 32</u> |  |



M.C.



M.C.

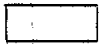

Species J. Pine J. Pine

Diameter 12" 6"

Bearing S 16 W S 42 E

Distance 1.49 ch. 1.31 ch.

Do you believe this to be a genuine Land Office Corner? yes

If not, why? \_\_\_\_\_

Harold Barnes

(Signature)

Apr. 6, 1937

(Date)

(Title)

V-W-5

10-10-3

1002-8

UNITED STATES DEPARTMENT OF THE INTERIOR

CORNER OF THE SECTION

Corner again.

Give any further facts which will aid in finding this

1.33 ch. change distat

8425

from which this Corner bears

tree

side of

tree 6 inches diameter, on the North West

Jack Pine

Metal Location Poster is on a

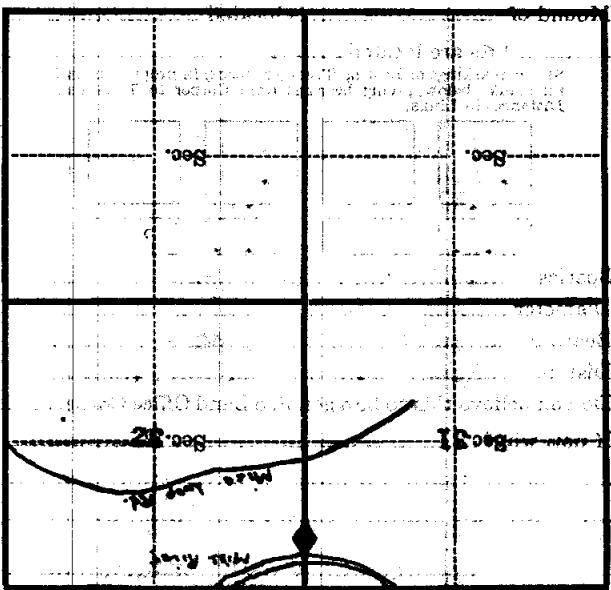

(Make sketch of topography near Corner)

10-10-3

8425

29

R.

T. 146

V-W-5

Form 874-9--Revised May, 1918

U. S. Department of Agriculture  
FOREST SERVICE

Chippewa NATIONAL FOREST

CORNERS OF THE PUBLIC SURVEY

T. 146 R. 29 5th Mer.

Meander Corner common to Sections  
31, and 32

Corner consists of a Brass cap (not) in place

State condition good

Dimensions above ground 7 inches

Sketch grooves, letters, figures, or notches, on proper face or edge.

CARDINAL POSITION

DIAGONAL POSITION

|   |    |   |    |
|---|----|---|----|
|   |    |   |    |
|   | 31 |   | 32 |
| N | W  | S | E  |

|    |    |    |    |
|----|----|----|----|
|    |    |    |    |
|    |    |    |    |
| NW | SW | SE | NE |

Mound of \_\_\_\_\_ is located \_\_\_\_\_

\_\_\_\_\_ Pits are located \_\_\_\_\_

Sketch markings of Bearing Trees (or Rocks) in proper box and fill blanks below, giving bearings from Corner to Trees and Distances in Links.

|         |  |         |  |
|---------|--|---------|--|
| T. 146N |  | T. 146N |  |
| R. 29W  |  | R. 29W  |  |
| S. 31   |  | S. 32   |  |

|      |  |      |  |
|------|--|------|--|
| M.C. |  | M.C. |  |
|------|--|------|--|

Species J. Pine J. Pine

Diameter 12" 6"

Bearing S 16 W S 42 E

Distance 1.49 ch. 1.31 ch.

Do you believe this to be a genuine Land Office Corner? yes

If not, why? \_\_\_\_\_

Harold Hennes  
(Signature)

Apr. 6, 1937  
(Date)

(Title)

UNITED STATES GEOLOGICAL SURVEY  
BUREAU OF LAND SURVEY

SECTION 36 T. 148 N. R. 29 E.

CORNER OF THE PUBLIC HIGHWAY

T. 148 N. R. 29 E. S. 36

SECTION 36

S. 36

Corner again.

Give any further facts which will aid in finding this

corner.

from which this Corner bears

side of

tree inches diameter, on the North West

Metal Location Poster is on a

Block Plate

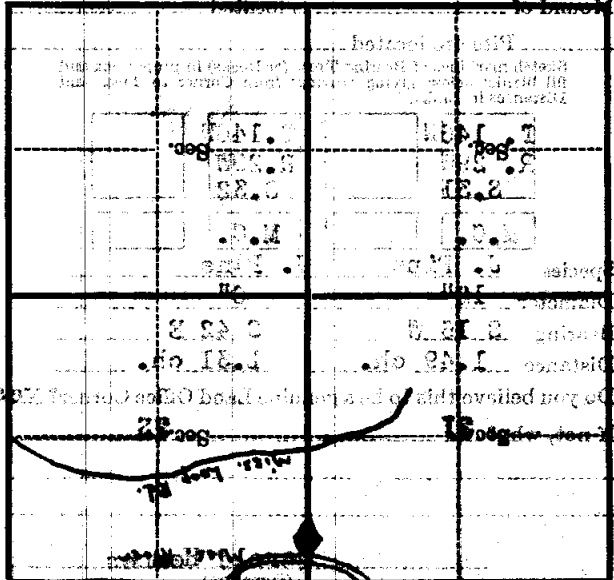

Mark north of topography near Corner

T. 148 N. R. 29 E.

V-W-3 Mer.