

See 104

Q-R-1

Form 374-9 - Revised May, 1913

U. S. Department of Agriculture
FOREST SERVICE

Chippewa NATIONAL FOREST

CORNERS OF THE PUBLIC SURVEY

T. 146 R. 29-30 5th Mar.

Meander Corner common to Sections
19, and 24

Corner consists of a brass cap (not) in place
State condition good

Dimensions above ground 6 inches

Sketch grooves, letters, figures, or notches, on proper face or edge.

CARDINAL POSITION

DIAGONAL POSITION

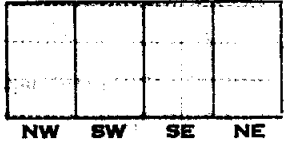
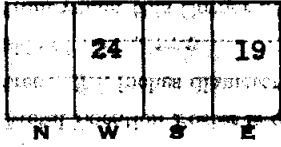

Mound of is located

Pits are located

Sketch markings of Bearing Trees (or Rocks) in proper box and fill blanks below, giving bearings from Corner to Trees and Distances in Links.

T146N
R. 30W
S. 24



T146N
R. 29W
S. 19



M.C.



M.C.



Species Ash Ash

Diameter 8 8

Bearing N 58 W N 12 E

Distance 1.24 ch. 3.4 ch.

Do you believe this to be a genuine Land Office Corner? Yes

If not, why?

Harold Hennes
(Signature)

March 31, 1937
(Date)

Q-R-1

Metal Location Poster is on a
 tree 7 inches diameter, on the East
 side of the
 from which this Corner bears
 chains distant
 Give any further facts which will aid in finding this
 Corner again.

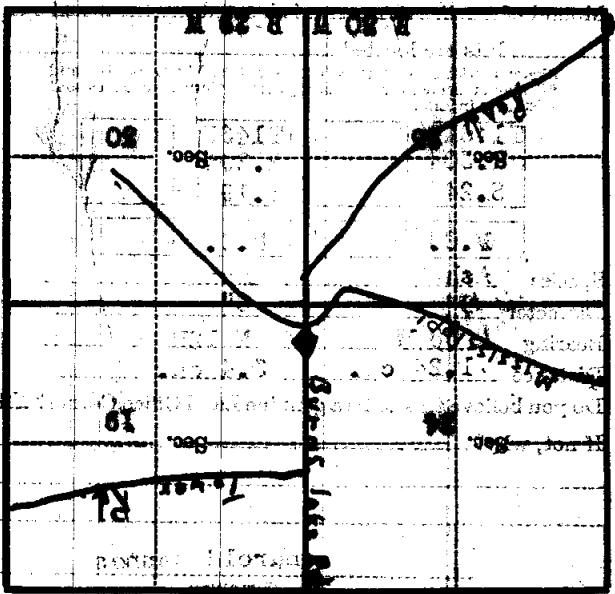

(Make sketch of topography near Corner)

Form 874-9—Revised May, 1918
U. S. Department of Agriculture
FOREST SERVICE

Chippewa NATIONAL FOREST
CORNERS OF THE PUBLIC SURVEY

T. 146 R. 29-30 5th Mer.

Meander Corner common to Sections
19 and 24

Corner consists of a brass cap (not) in place

State condition good

Dimensions above ground 8 inches

Sketch grooves, letters, figures, or notches, on proper face or edge.

CARDINAL POSITION

DIAGONAL POSITION

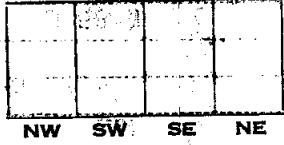
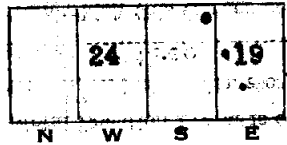

Mound of is located

Pits are located

Sketch markings of Bearing Trees (or Rocks) in proper box and fill blanks below, giving bearings from Corner to Trees and Distances in Links.

T146N
R. 30W
S. 24

T146N
R. 29W
S. 19

M.C.

M.C.

Species Ash Ash

Diameter 7" 9"

Bearing N 88 W N 12 E

Distance 1.24 ch. 3.4 ch.

Do you believe this to be a genuine Land Office Corner? Yes

If not, why?

Harold Hennes
(Signature)

March 31, 1937
(Date)

(Title)

Corner again.
Mississippi bridge a few links south
east of corner

Give any further facts which will aid in finding this
1.24 chains distant.

N 58 W

from which this Corner bears

side of tree

tree 7 inches diameter, on the East

Metal Location Poster is on a
Ash

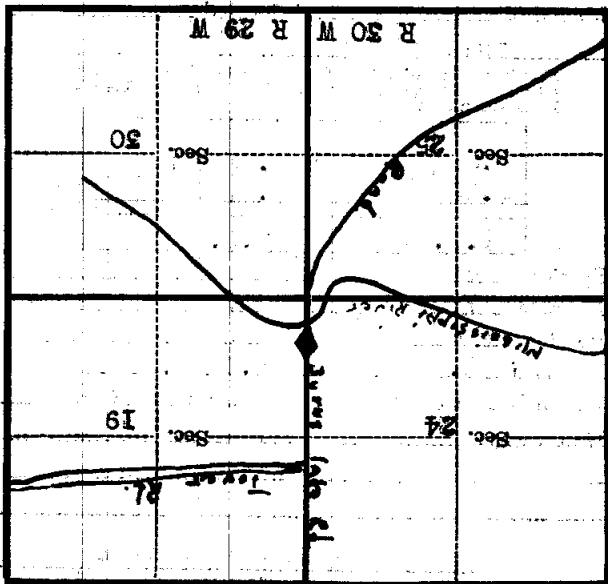

(Make sketch of topography near Corner)