

Form 874-9—Revised May, 1918
U. S. DEPARTMENT OF AGRICULTURE
FOREST SERVICE

J-9
 Posted

 NATIONAL FOREST

CORNERS OF THE PUBLIC SURVEY

T. 146 R. 17 Mer.

Section Corner common to Sections

8, 9, 10, and 11

Corner consists of a (not) in place
 State condition

Dimensions above ground inches.

Sketch grooves, letters, figures, or notches, on proper face or edge.

CARDINAL POSITION

DIAGONAL POSITION

--	--	--	--

--	--	--	--

N W S E NW SW SE NE

Mound of is located

 Pits are located

Sketch markings of Bearing Trees (or Rocks) in proper box and fill blanks below, giving bearings from Corner to Trees and Distances in Links.

Species
 Diameter
 Bearing
 Distance

Do you believe this to be a genuine Land Office Corner?

If not, why?

 Signature

Date Title

J-9 8-3027

Corner again.

Give any further facts which will aid in finding this

chains distant.

from which this Corner bears

side of

tree inches diameter, on the

Metal Location Poster is on a

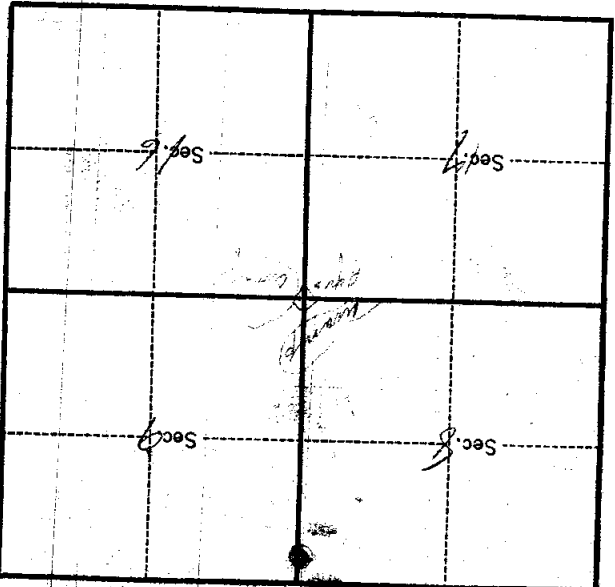

(Make sketch of topography near Corner.)