

N-5

U. S. Department of Agriculture

FOREST SERVICE

Chippewa NATIONAL FOREST

CORNERS OF THE PUBLIC SURVEY

T. 146N R. 29 W 5th Mer.

Sec. eor. Corner common to Sections

17, 18, 19, and 20

Corner consists of a metal cap (not) in place

State condition good

Dimensions above ground 1 inches

Sketch grooves, letters, figures, or notches, on proper face or edge.

CARDINAL POSITION

DIAGONAL POSITION

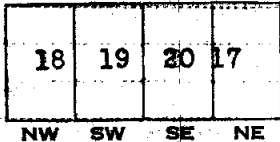
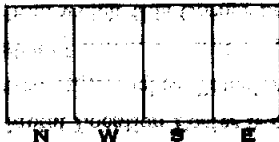

Mound of is located

Pits are located

Sketch markings of Bearing Trees (or Rocks) in proper box and fill blanks below, giving bearings from Corner to Trees and Distances in Links.

T.145N
R.29W
S.20

T.146N
R.29W
S.17

T146N
R.29W
S.18

T146N
R.29W
S.19

B.T.

B.T.

B.T.

B.T.

Species N. P. Aspen B. Spr. Balsam

Diameter 16" 10" 14" 7"

Bearing S.56E N49E N63W S46W

Distance 127 lks 23 lks 1oh. 76 lks

Do you believe this to be a genuine Land Office Corner? Yes

If not, why?

Gene Tinderholm

(Signature)

March 22, 1937

(Date)

(Title)

N-5

Metal Location Poster is on a **White Pine**  
 tree **1/2** inches diameter, on the **East**  
 side of **Sec. 19**  
 from which this Corner bears **S 45 E**  
**1/2** chains distant.  
 Give any further facts which will aid in finding this  
 Corner again.

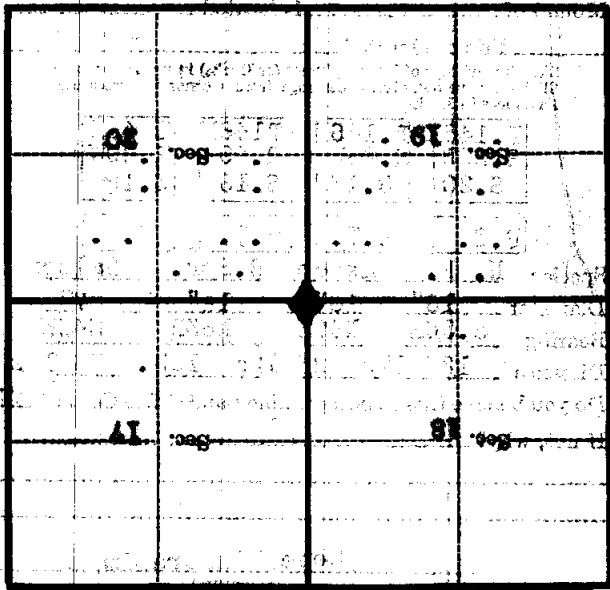

(Make sketch of topography near Corner)

N-5

U. S. Department of Agriculture  
FOREST SERVICE

Chippewa NATIONAL FOREST

CORNERS OF THE PUBLIC SURVEY

T. 100N R. 29 W 5th Mer.

Sec 17 Corner common to Sections  
17, 18, 19, and 20

Corner consists of a metal cap (not) in place  
State condition good

Dimensions above ground 1 inches

Sketch grooves, letters, figures, or notches, on proper face or edge.

CARDINAL POSITION

DIAGONAL POSITION

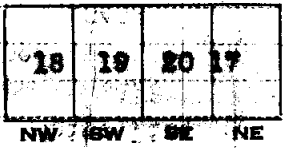
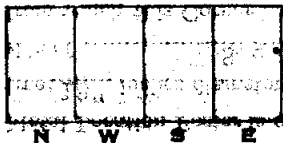

Mound of   is located  

Pits are located  

Sketch markings of Bearing Trees (or Rocks) in proper box and fill blanks below, giving bearings from Corner to Trees and Distances in Links.

T. 145N
R. 29W
S. 20

T. 145N
R. 29W
S. 17

T. 145N
R. 29W
S. 18

T. 145N
R. 29W
S. 19

B.T.

B.T.

B.T.

B.T.

Species N. P. Aspen N. Spr. Balsam

Diameter 18" 10" 14" 7"

Bearing S. 56E N 49E N 65W S 40W

Distance 127 lks 25 lks 1ch. 76 lks

Do you believe this to be a genuine Land Office Corner? yes

If not, why?  

Gene Tindholm

(Signature)

March 22, 1957

(Date)

(Title)

CORNER OF THE PUBLIC SURVEY

Corner again.

Give any further facts which will aid in finding this

Corner distant.

from which this Corner bears

S45E

side of Sec. 19

tree 18" inches diameter, on the East

Metal Location Poster is on a White Pine

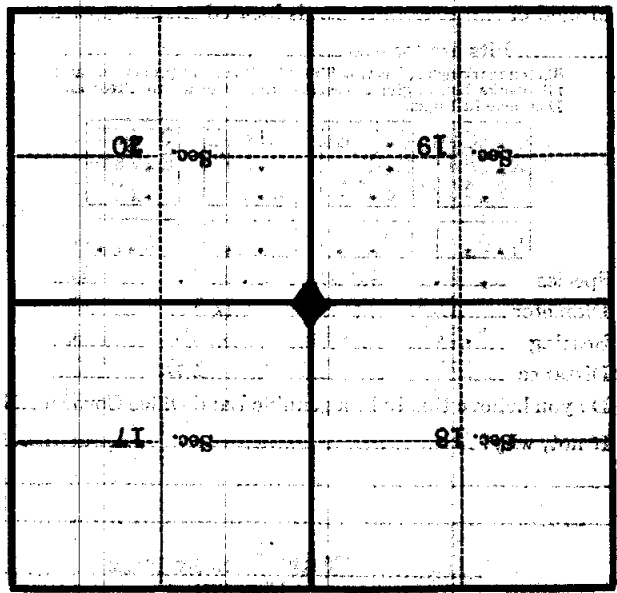

(Make sketch of topography near Corner)

U. S. Department of Agriculture  
FOREST SERVICE

Chippewa NATIONAL FOREST

CORNERS OF THE PUBLIC SURVEY

T. 146 N R. 29 W S1/4 P. Mer.

Section Corner common to Sections  
18, 17, 19, and 20

Corner consists of a Brass cap on pipe in place

State cond

Dimensions

Sketch grc  
CARDINAL

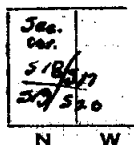

inches  
or edge.  
SITION



NE

Mound of

Pits

Sketch mar  
fill blanks  
Distances in

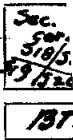

and  
and

Species White

Diameter 9

Bearing S40°E

Distance 29 chs.

14"

1/31/11

4 chs.

Do you believe this to be a genuine Land Office Corner? Yes

If not, why?

Paul Moller

(Signature)

Forest Ranger P-1

1/29/38

(Date)

(Title)

Must  
be wrong  
corner - ties  
type of monument  
don't fit  
MEH  
4/16/86

Corner again.

Give any further facts which will aid in finding this

33 chains distant.

from which this Corner bears

N 110 W

side of

tree 6 inches diameter, on the

SE

Metal Location Pester is on a

White Pine

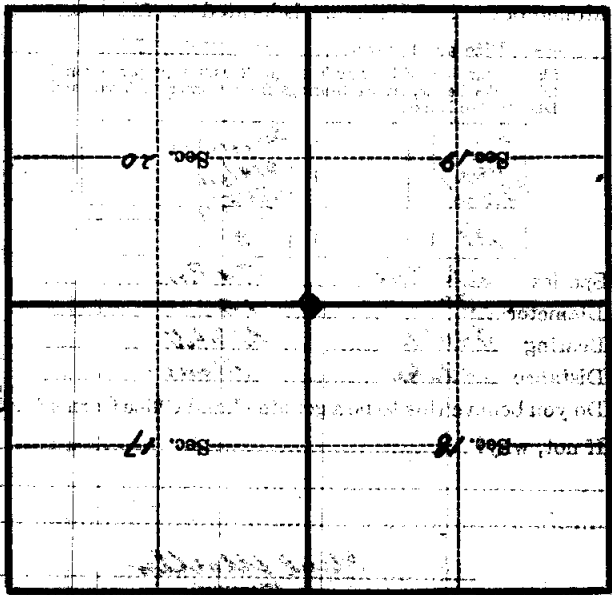

(Make sketch of topography near Corner)

T. 146 N R. 29 W

M.N.S. Mer.

U. S. Department of Agriculture  
FOREST SERVICE

Chippawa NATIONAL FOREST

CORNERS OF THE PUBLIC SURVEY

T. 146N R. 29W 6th P. Mer.

Section Corner common to Sections  
18, 17, 19, and 20

Corner consists of a Bronze cap pipe (not) in place

State condition Good

Dimensions above ground 2 inches

Sketch grooves, letters, figures, or notches, on proper face or edge.

CARDINAL POSITION

DIAGONAL POSITION

Sec. Cor. 518/517 519/520				
N	W	S	E	

NW	SW	SE	NE	

Mount of \_\_\_\_\_ is located \_\_\_\_\_

\_\_\_\_\_ Pits are located \_\_\_\_\_

Sketch markings of Bearing Trees (or Rocks) in proper box and fill blanks below, giving bearings from Corner to Trees and Distances in Links.

Sec. Cor. 518/517 519/520		Sec. Cor. 518/517 519/520	
BT.		BT.	

Species White Pine Red Pine

Diameter 9" 14"

Bearing S40°E N31°W

Distance .29 chs. .41 chs.

Do you believe this to be a genuine Land Office Corner? Yes

If not, why? \_\_\_\_\_

Pavel Mooler

(Signature)  
P. J. Foster P.

11/29/38  
(Date)

(Title)

Form No. 16

POST OFFICE

FEDERAL BUREAU OF INVESTIGATION

COMMUNICATIONS SECTION

COMMUNICATIONS SECTION

Corner consists of a square (two) in each corner.

Give any further facts which will aid in finding the

location of the corner on the map.

from which this corner bears

N.W.

of 50

feet, inches diameter, on the

metal location corner is on a white pine

This is located (Specify location of bearing lines for (a) in corner and all lines bearing from corner to a tree and distance to tree)	
Species <u>White Pine</u>	Bearing <u>50°</u>
Distance <u>50</u>	Do you believe this to be a genuine Federal Corner? <u>Yes</u>
Date <u>Dec. 19</u>	Loc. No. <u>19</u>

Draw sketch of topography and locality

T. 156N B. 25W

Mr.