

U. S. DEPARTMENT OF AGRICULTURE
FOREST SERVICE

Posted
2-19

~~CHIPPEND~~ NATIONAL FOREST

CORNERS OF THE PUBLIC SURVEY

145 T. 146 N. R. 27 W. 5th Mer.

1/4 Corner common to Sections

35, 2, and

Corner consists of a *squared stake* in place

State condition *Fair*

Dimensions above ground *3x3x72* inches.

Sketch grooves, letters, figures, or notches, on proper face or edge.

CARDINAL POSITION

DIAGONAL POSITION

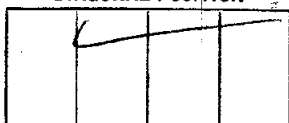
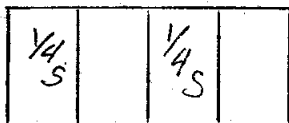

Mound of *✓* is located *✓*

✓ Pits are located

Sketch markings of Bearing Trees (or Rocks) in proper box and fill blanks below, giving bearings from Corner to Trees and Distances in Links.

<i>1/4</i> <i>S</i>			
<i>B.T.</i>			

Species *Spruce*

Diameter *9"*

Bearing *S 88 W*

Distance *6 Lks*

Do you believe this to be a genuine Land Office Corner? *yes*

If not, why? _____

Edward Inerssen

Signature.

10-22-29

Date.

Estimator

Title.

T. 146 N. R. 87 W. S. 44 Mer.

8-3027

(Make sketch of topography near corner.)

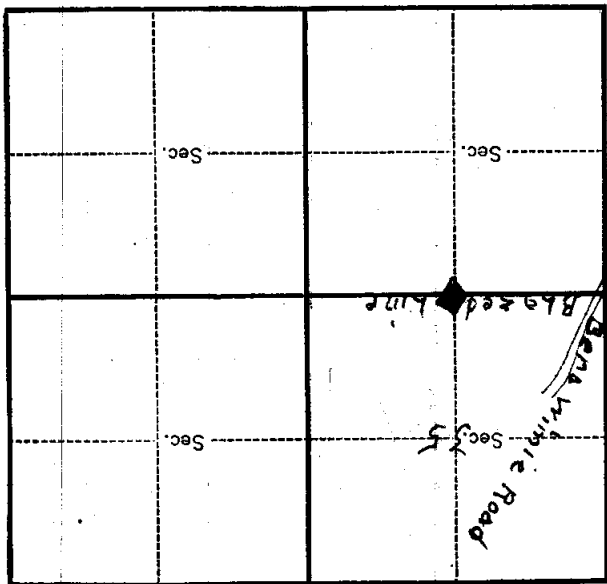

Metal Location Poster is on a

Spruce

tree *9* inches diameter, on the

side of *570 ft*

from which this Corner bears

S 88° W

104 chains distant.

Give any further facts which will aid in finding this

Corner again.

Corner is in 40 Swamp