

U. S. Department of Agriculture

FOREST SERVICE

15-9

NATIONAL FOREST

CORNERS OF THE PUBLIC SURVEY

T. 146 N. R. 26 W. Mer.

Section Corner common to Sections
17, 16, 9, and 8Corner consists of a Wood Stake (not) in placeState condition GoodDimensions above ground 2 1/2 inches

Sketch grooves, letters, figures, or notches, on proper face or edge.

CARDINAL POSITION

DIAGONAL POSITION

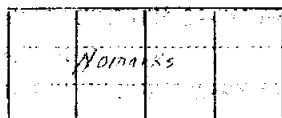

No marks

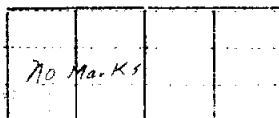

No Marks

Mound of is located Pits are located

Sketch markings of Bearing Trees (or Rocks) in proper box and fill blanks below, giving bearings from Corner to Trees and Distances in Links.

Species Green Aspen BT AspenDiameter 19 17 11Bearing N 42° W S 51° W S 69° WDistance 53 Links 82 Links 1.14 LinksDo you believe this to be a genuine Land Office Corner? If not, why? Boundary Clear. Corner not sketched381 South of Edge Corner Post

(Signature)

(Date)

(Title)

40

Faint, illegible text at the top of the page, possibly bleed-through from the reverse side.

Set for left of road and 38 Lins. North
of Coronado Pass to 5025 3 19

Corner again.
Give any further facts which will aid in finding this
chains distant.
from which this Corner bears
side of
tree inches diameter, on the
Metal Location Poster is on a

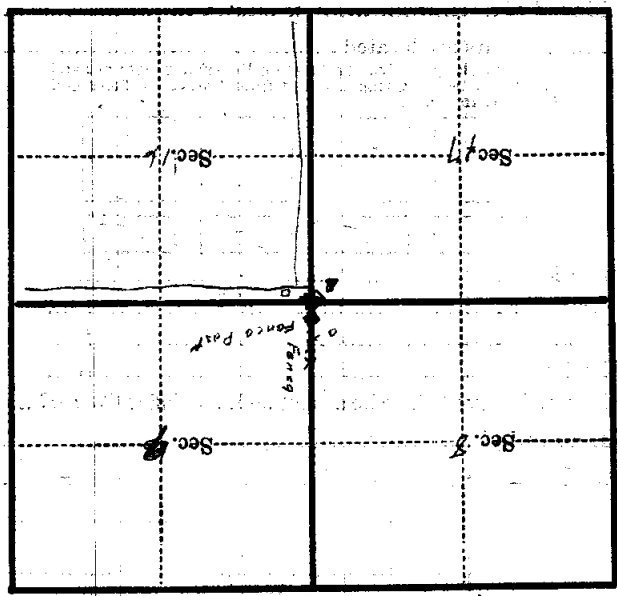

(Make sketch of topography near Corner)

U. S. Department of Agriculture
FOREST SERVICE

151

Chippewa NATIONAL FOREST
CORNERS OF THE PUBLIC SURVEY

T. 146 N. R. 26 W. 5 Mer.

SECTION Corner common to Sections
17, 16, 9, and 8

Corner consists of a Wood stake (net) in place
State condition good

Dimensions above ground 2 1/2 inches
Sketch grooves, letters, figures, or notches, on proper face or edge.
CARDINAL POSITION DIAGONAL POSITION

N	W	S	E

NW	SW	SE	NE

Mound of _____ is located _____

Pits are located _____

Sketch markings of Bearing Trees (or Rocks) in proper box and fill blanks below, giving bearings from Corner to Trees and Distances in Links.

	DOWN	SN 79 7°	Stake
	146 N	7 1/4	7 1/4
	R 26 W	R 26 W	R 26
	S 8	S 17	S 16
	BT	BT	BT

Species ASPEN ASPEN ASPEN
Diameter 13 12 11
Bearing N 92° W 55° W 56° W
Distance 83 82 1.14

Do you believe this to be a genuine Land Office Corner? _____

If not, why? Bearing 860 Oakley Nat served
386 S. of F. F. Oakley corner

(Signature)

(Date)

(Title)

40

COMPARISON OF THE TWO METHODS

Corner again
 Give any further facts which will aid in finding the
 chains distant.
 From which this Corner bears
 side of
 tree inches diameter, on the
 Metal Location Poster is on a

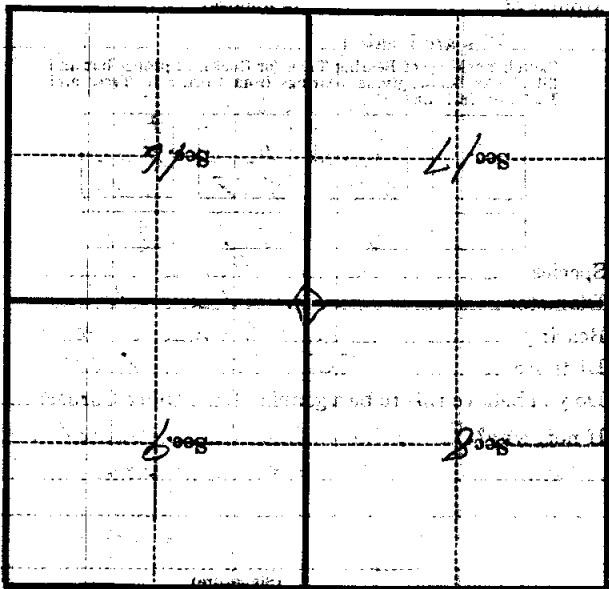

(Make sketch of topography near Corner)

U. S. Department of Agriculture
FOREST SERVICE

J-9

Chippewa NATIONAL FOREST
CORNERS OF THE PUBLIC SURVEY

T. 146 N. R. 26 W. 5th Mer.

Section 17, 16, 9, and 8
Corner common to Sections

Corner consists of a Woodstake (not) in place
State condition Good

Dimensions above ground 2 1/2 inches
Sketch grooves, letters, figures, or notches, on proper face or edge.

CARDINAL POSITION

DIAGONAL POSITION

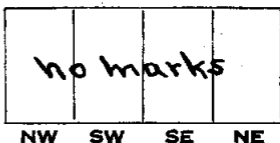
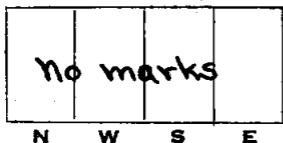

Mound of _____ is located _____

Pits are located _____

Sketch markings of Bearing Trees (or Rocks) in proper box and fill blanks below, giving bearings from Corner to Trees and Distances in Links

	Dawn	Snag 7'	Stub 6"
	T. 146 N. R. 26 W. Sec. 8	T. 146 N. R. 26 W. Sec. 17	T. 146 N. R. 26 W. Sec. 16
	BT.	BT.	BT.

Species	Aspen	Aspen	B.N. Aspen
Diameter	13	12	11
Bearing	N. 72° W.	S. 52° W.	S. 64° W.
Distance	82 Links	82 Links	1.14 ch.

Do you believe this to be a genuine Land Office Corner? _____
If not, why? Bearing G. L. O. Corner not scribed 98 N. South of Fence corner post.

(Signature)

(Date)

(Title)

(Make sketch of topography near corner)

T. 146 N. R. 26 W. 5th Mer.

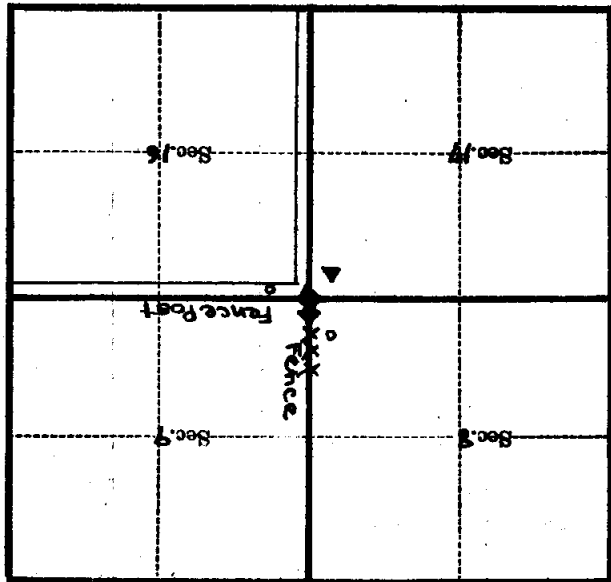

Metal Location Poster is on a

tree inches diameter, on the

side of

from which this Corner bears

chains distant.

Give any further facts which will aid in finding this

Corner again.

Set to left of road + 8 links
South of corner fence post in
Sec. 8 + 9.

U. S. DEPARTMENT OF AGRICULTURE

FOREST SERVICE

J-9

Chippewa NATIONAL FOREST

CORNERS OF THE PUBLIC SURVEY

T. 145 N R. 26 W 5th Mer.

Section

Corner common to Sections

8, 9, 10, and 17

Corner consists of a Nothing (not) in place

State condition Gone

Dimensions above ground inches.

Sketch grooves, letters, figures, or notches, on proper face or edge.

CARDINAL POSITION

DIAGONAL POSITION

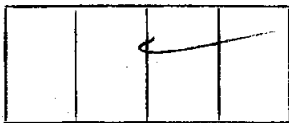
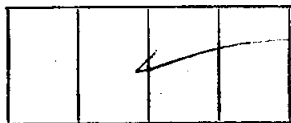

N W S E

NW SW SE NE

Mound of is located

Pits are located

Sketch markings of Bearing Trees (or Rocks) in proper box and fill blanks below, giving bearings from Corner to Trees and Distances in Links.

T145
R26
S16



Species J. Pine Stub

Diameter 11"

Bearing S.W.

Distance

Do you believe this to be a genuine Land Office Corner? yes

If not, why?

Edward J. Jensen

Signature.

9-16-29

Date.

Estimator

Title. J-9 8-3027

U. S. Department of Agriculture
FOREST SERVICE

J-9

Posted

Chippewa NATIONAL FOREST

CORNERS OF THE PUBLIC SURVEY

T. 146N. R. 26W. 5th Mer.

Section Corner common to Sections
9, 8, 17, and 16

Corner consists of a Wood Stake (not) in place
State condition Good

Dimensions above ground 2' 6" inches

Sketch grooves, letters, figures, or notches, on proper face or edge.

CARDINAL POSITION

DIAGONAL POSITION

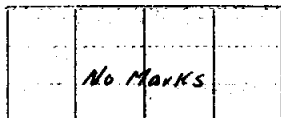

N W S E

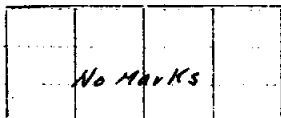

NW SW SE NE

Mound of _____ is located _____

Pits are located _____

Sketch markings of Bearing Trees (or Rocks) in proper box and fill blanks below, giving bearings from Corner to Trees and Distances in Links.

	<u>Down</u>	<u>3000'</u>	<u>Stump</u>
	T. <u>146N.</u>	T. <u>146N.</u>	T. <u>146N.</u>
	R. <u>26W.</u>	R. <u>26W.</u>	R. <u>26W.</u>
	S. <u>8</u>	S. <u>17</u>	S. <u>16</u>

	<u>BT.</u>	<u>B.T.</u>	<u>B.T. (B)</u>
--	------------	-------------	-----------------

Species Aspen Aspen Aspen

Diameter 12 12 11

Bearing N42°W S52°W S64°E

Distance 836 826 1146

Do you believe this to be a genuine Land Office Corner? _____

If not, why? Tree has G.L.O. Markings

But Stake is Not Marked

Haley J. Fuller
(Signature)

Oct 9, 1937
(Date)

(Title)

Blank lined writing area at the top of the page.

Stake to be found at left of road.
Going North 38 links South of
Corner. Fence Post.

Corner again.
Give any further facts which will aid in finding this
chains distant.
from which this Corner bears
side of
tree inches diameter, on the
Metal Location Poster is on a *Alc. poster*

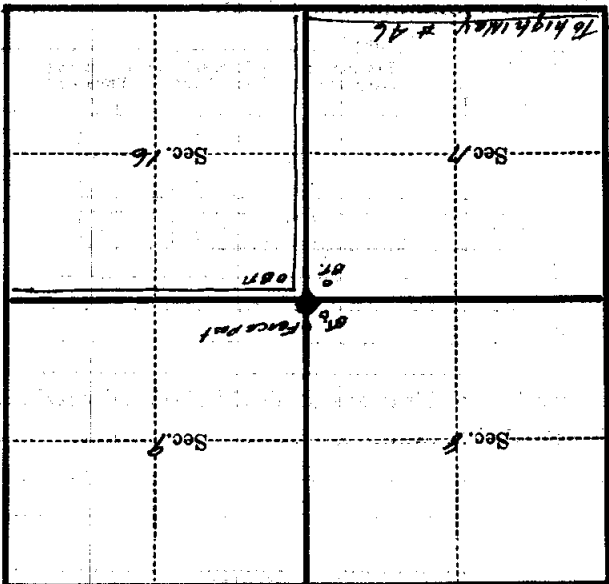

U. S. DEPARTMENT OF AGRICULTURE
FOREST SERVICE

Minn NATIONAL FOREST J-9

CORNERS OF THE PUBLIC SURVEY

T. 145 R. 26 5 Mer.
8-9-16-17 Corner common to Sections

and _____
Corner consists of a Green Birch (not) in place
State condition Squared

Dimensions above ground DBH. 8 inches.
Sketch grooves, letters, figures, or notches, on proper face or edge.

CARDINAL POSITION

DIAGONAL POSITION

--	--	--	--

--	--	--	--

N W S E

NW SW SE NE

Mound of _____ is located _____

Pits are located _____

Sketch markings of Bearing Trees (or Rocks) in proper box and fill blanks below, giving bearings from Corner to Trees and Distances in Links.

--	--	--	--

BT	BT	BT	
----	----	----	--

Species	<u>JP</u>	<u>SP</u>	<u>JP</u>	
Diameter	<u>14'</u>	<u>12</u>	<u>15</u>	
Bearing	<u>SE</u>	<u>SW</u>	<u>E</u>	
Distance	<u>6 ft</u>	<u>5 ft</u>	<u>6 ft</u>	

Do you believe this to be a genuine Land Office Corner? yes
If not, why? _____

Matt Soderback
Signature.

Date.

Title. J-9 8-3027

T. R. Mer.

3-3027

(Make sketch of topography near Corner.)

J-9

	Sec.		Sec.
	Sec.		Sec.

Metal Location Poster is on a

tree _____ inches diameter, on the

side of _____

from which this Corner bears _____

_____ chains distant.

Give any further facts which will aid in finding this

Corner again.

*The Ring Road
from the corner of 9th
and Franklin Sts
to the*