

Foot

✓ 23

Section Corners ^{betw.} 1 Secs. 25-36

T 145N. R 31W. Mer. 51st

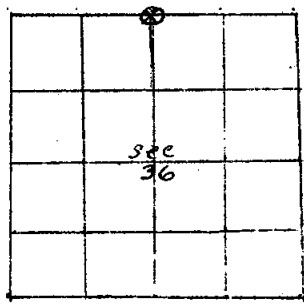

Corner is
an Oak post

Height 4'

Dia 3" square

Marked $\frac{1/2}{25} // \frac{1/2}{36}$

BEARING TREES

Marks 1/4 S 25
B.T.

Species W. Oak

Diameter 6"

Bearing N. 51 1/2 W.

District ^{and} 24 1/6

Metal poster on _____

Remarks: Govt B.T.s gone. Run true line from N.E. Cor. of Sec. 36 thru 1/6 Cor placed about 25 years ago and several Old Govt line trees on line and placed 1/4 corner 4000 chs. west.

Date 3/9/34 Signed J. A. Gjelhaug

