

U. S. Department of Agriculture

FOREST SERVICE

posted

Chippewa NATIONAL FOREST

223

CORNERS OF THE PUBLIC SURVEY

T. *145 N* R. *31 W* S. *5 1/2 P.* Mer.

SC 1/4 Corner common to Sections

Corner consists of a *Iron Pipe* (not) in place

State condition *good*

Dimensions above ground *8* inches.

Sketch grooves, letters, figures, or notches, on proper face or edge.

CARDINAL POSITION

DIAGONAL POSITION

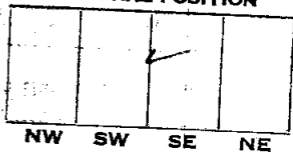
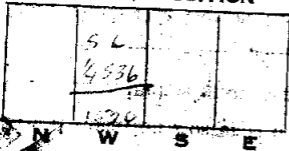

is located

Pits are located

Sketch markings of Bearing Trees (or Rocks) in proper box and fill blanks below, giving bearings from Corner to Trees and Distances in Links.

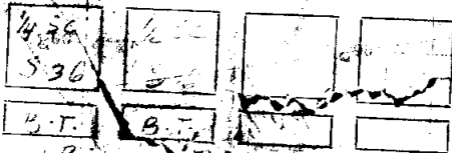

Species *J. Pine*

Diameter *7 1/2* *15*

Bearing *S 62° W* *N 51° E*

Distance *100'* *45'*

Do you believe this to be a genuine Land Office Corner? *Yes*

If not, why?

(Signature)

(Date)

(Title)

Corner again.
 An road in narrow neck of
 land between above
 corner point of road from
 road toward center of
 on narrow rocky corner

Metal Location Poster is on a
 tree inches diameter, on the
 side of
 from which this Corner bears
 chains distant.
 Give any further facts which will aid in finding this

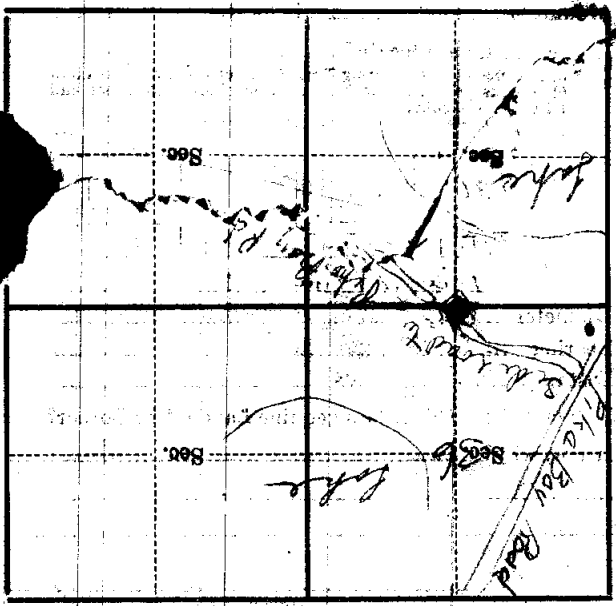

(Make sketch of topography near Corner)