

U. S. Department of Agriculture

FOREST SERVICE

N9

Posted

Chippewa NATIONAL FOREST

CORNERS OF THE PUBLIC SURVEY

T. 145 N R. 31 W 5th Mer. Section

Corner common to Sections 16, 17, 20, and 21

Corner consists of a Not Found (not) in place State condition

Dimensions above ground inches Sketch grooves, letters, figures, or notches, on proper face or edge.

CARDINAL POSITION

DIAGONAL POSITION

--	--	--	--

--	--	--	--

N W S E

NW SW SE NE

Mound of is located

Pits are located

Sketch markings of Bearing Trees (or Rocks) in proper box and fill blanks below, giving bearings from Corner to Trees and Distances in Links.

	0/4 BT		

Species J. Pine J. Pine

Diameter 4" 4"

Bearing S43 3/4 E N4 20 E

Distance 84

Do you believe this to be a genuine Land Office Corner? Yes

If not, why?

J. A. Gjelhaug

(Signature)

2-8-35 (Date)

Tech. Eng.

(Title)

by D. J. Sutton

Corner again. *Val 6'30" was use. Placed corner at intersection of north-south and east-west line, at intersection of roads. Very close to correct corner.*

Metal Location Poster is on a *No poster.* tree inches diameter, on the side of from which this Corner bears chains distant. Give any further facts which will aid in finding this

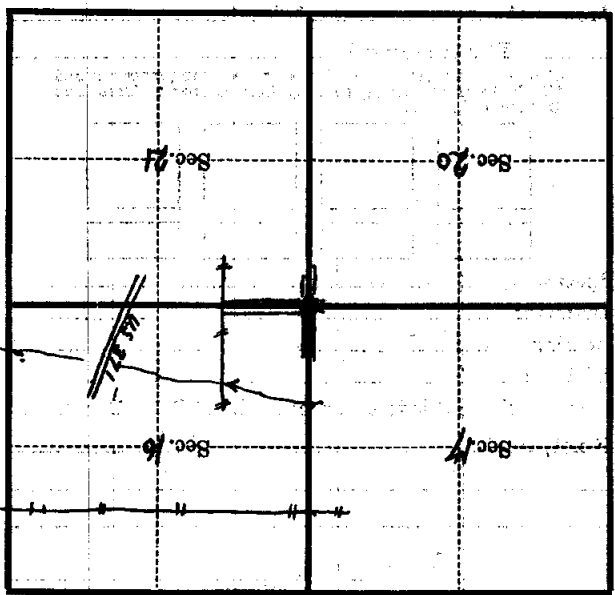

(Make sketch of topography near Corner)

T. 145 N. R. 31 W. 5th Mer.