

Form 874-9—Revised May, 1918  
 U. S. Department of Agriculture  
 FOREST SERVICE

G-25

Chippewa

NATIONAL FOREST

CORNERS OF THE PUBLIC SURVEY

T. 145 R. 29-50 5th Mer.  
 Quarter

Corner common to Sections 7 and 12

Corner consists of a Brass Cap (not) in place  
 State condition Good

Dimensions above ground 6 inches

Sketch grooves, letters, figures, or notches, on proper face or edge.  
 CARDINAL POSITION DIAGONAL POSITION

	12		7
N	W	S	E

NW	SW	SE	NE

Mound of \_\_\_\_\_ is located \_\_\_\_\_

Pits are located \_\_\_\_\_

Sketch markings of Bearing Trees (or Rocks) in proper box and fill blanks below, giving bearings from Corner to Trees and Distances in Links.

1/4			
S. 7			
B. T.			

Species J. Pine  
 Diameter 8"  
 Bearing N 35° E.  
 Distance 40 links

Do you believe this to be a genuine Land Office Corner? Yes

If not, why? \_\_\_\_\_

Herold Hermes

(Signature)

Apr. 7, 1907

(Date)

(Type)

U.S. DEPARTMENT OF AGRICULTURE  
 FOREST SERVICE  
 NATIONAL FOREST  
 CORNERS OF THE PUBLIC SURVEY  
 T. 145 N. R. 29 E. S. 30  
 Corner consists of a metal location poster in place  
 Corner again  
 Give any further facts which will aid in finding the  
 CARDINAL POSITION  
 from which this Corner bears  
 N 58.5° E.  
 side of  
 tree  
 inches diameter, on the  
 South West  
 Metal Location Poster is on a  
 Rock Top

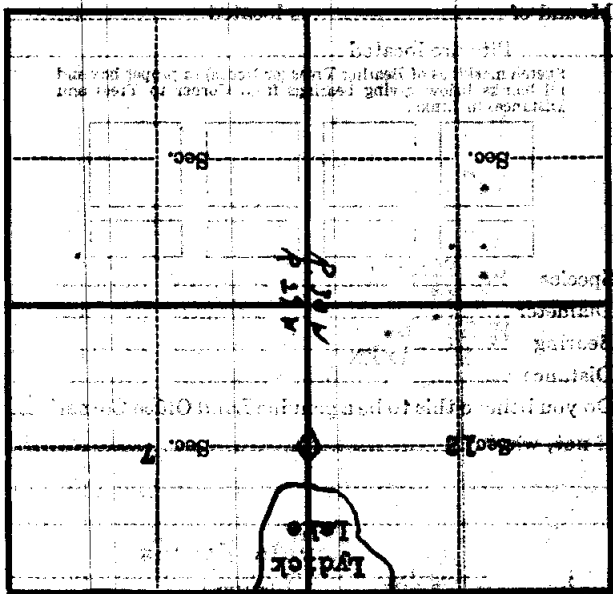

(State sketch of topography near Corner)