

Posted

J-3

Section Corners betw. Secs. 7-10

T 145N. R 30W. Mer. 5TD

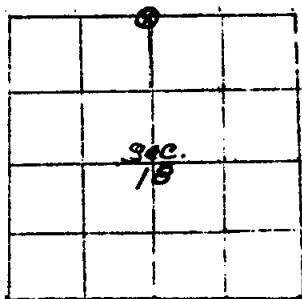

Corner is  
a BRASS Coped Cement

Height 5" above Gr.

Dia 5"

Marked 

BEARING TREES

Marks 1/4 S. 7  
BT

Species Red Oak

Diameter 6"

Bearing N 20° E

Dist ~~ance~~ 22 1/2 1/4

Metal poster on \_\_\_\_\_

Remarks:

Date 1/30/34 Signed J. A. Gjelhaug

