

Form 874-B—Revised May, 1918
 U. S. Department of Agriculture
 FOREST SERVICE

127

Chipewa NATIONAL FOREST

CORNERS OF THE PUBLIC SURVEY

T. 145N. R. 28W 5th Mer.

Section Corner common to Sections
28, 29, 32, and 33

Corner consists of a Q. Oak Post (not) in place

State condition Iron pipe 1" x 18"
Good

Dimensions above ground 90 inches

Sketch grooves, letters, figures, or notches, on proper face or edge.

CARDINAL POSITION

DIAGONAL POSITION

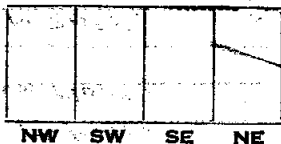
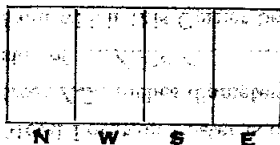

Mound of _____ is located _____

Pits are located _____

Sketch markings of Bearing Trees (or Rocks) in proper box and fill blanks below, giving bearings from Corner to Trees and Distances in Links.

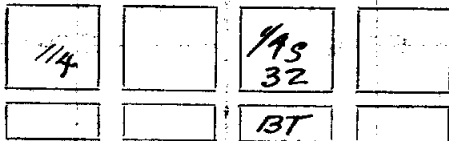

Species J. Pine M. & N. Pine

Diameter 20" 12"

Bearing S. 57° 30' W. S. 20° W.

Distance 140 13 3/4

Do you believe this to be a genuine Land Office Corner? Yes

If not, why?

J. A. Gjothang
 (Signature)
Jr. Civil Eng.
 (Title)
 V-9

140/26

Faint, illegible text on ruled lines at the top of the page.

Corner again.

Give any further facts which will aid in finding this

0.13 3/4 chains distant.

from which this Corner bears N 20° E.

side of ~~tree~~

tree 12. inches diameter, on the North

Metal Location Poster is on a N. Pine

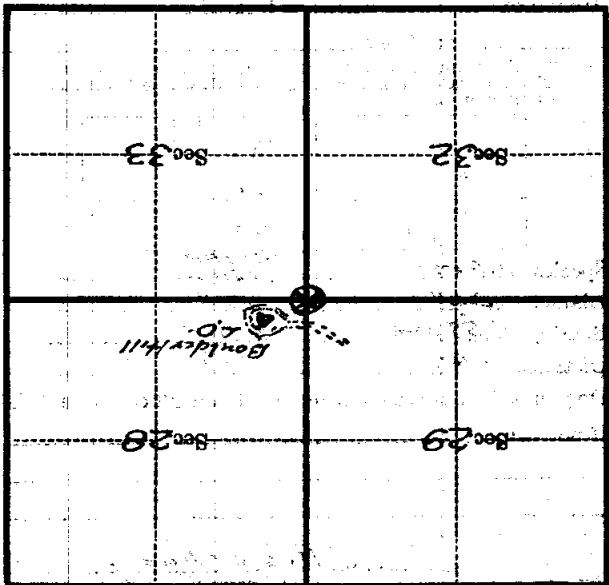

(Make sketch of topography near Corner)