

U. S. Department of Agriculture

FOREST SERVICE

38

123

Chippewa NATIONAL FOREST A-21

CORNERS OF THE PUBLIC SURVEY

T. 145 R. 27 5th Mer.

Section 1, 2, 35, and 36 Corner common to Sections

Corner consists of a square stake (not) in place State condition old but fairly solid

Dimensions above ground 30 inches

Sketch grooves, letters, figures, or notches, on proper face or edge.

CARDINAL POSITION

DIAGONAL POSITION

| | | | |
|---|---|---|---|
| | | | |
| N | W | S | E |

| | | | |
|---------|---------------------|-------------|----|
| S 36 | T145 R27 S. 2 | T145 R27 | |
| NW | SW | SE | NE |

Mound of _____ is located _____

Pits are located _____

Sketch markings of Bearing Trees (or Rocks) in proper box and fill blanks below, giving bearings from Corner to Trees and Distances in Links.

| | | | |
|--|-----------------------|--|--|
| | T145N R27W S. 2 | | |
| | | | |

Species _____ Diameter _____ Bearing _____ Distance _____

Do you believe this to be a genuine Land Office Corner? Yes. If not, why? _____

Earl M. Handy (Signature)

Jan 10, 1934 (Date)

Chief of Party (Title)

Corner again.
L.P. on No. 8 in 40 ch. down N. of cor.
see bearings here to corner.

Give any further facts which will aid in finding this
chains distant.

5.
from which this Corner bears S. W.
side of the corner
tree 8" inches diameter, on the
Metal Location Poster is on a
Back Pino N.E.

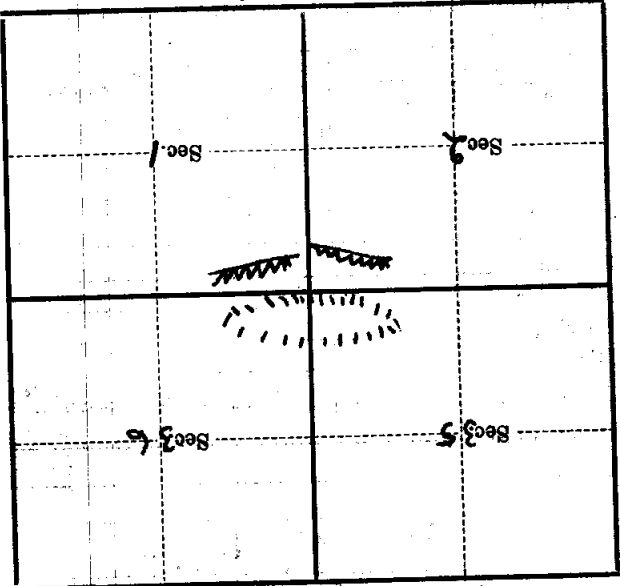

(Make sketch of topography near Corner)

T. 14 S R. 27 S. Mer.

U. S. Department of Agriculture
FOREST SERVICE

123
A-21

Chippewa NATIONAL FOREST

CORNERS OF THE PUBLIC SURVEY

T. 145N R. 27W 5th Mer.

This Corner common to Sections
35, 36, 2, and 1

Corner consists of a Squared Stake ~~(not)~~ in place
State condition New Stake

Dimensions above ground 3x3 inches

Sketch grooves, letters, figures, or notches, on proper face or edge.

CARDINAL POSITION

DIAGONAL POSITION

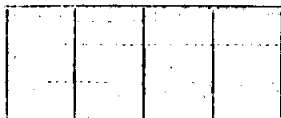

N W S E

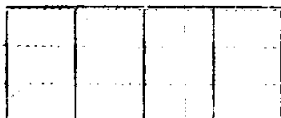

NW SW SE NE

Mound of _____ is located _____

Pits are located _____

Sketch markings of Bearing Trees (or Rocks) in proper box and fill blanks below, giving bearings from Corner to Trees and Distances in Links.

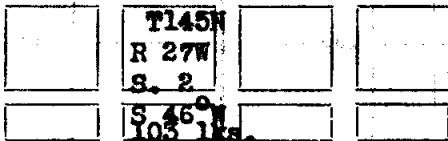

Species Norway Pine

Diameter 20"

Bearing S 46° W

Distance 103 links

Do you believe this to be a genuine Land Office Corner? ...

If not, why? _____

T. Fairbank
T. Fairbank

(Date)

C.C.C. (Title)

Corner is approximately blazed line
from west & from south
Scribed stake could not be found.

Corner again.

Give any further facts which will aid in finding this

chains distant.

20

N 75° W

from which this Corner bears

side of tree

tree 6 inches diameter, on the East

Metal Location Poster is on a Spruce

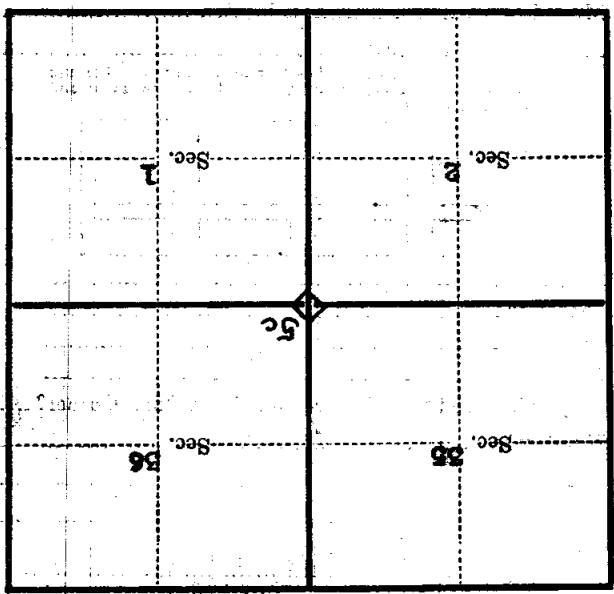

(Make sketch of topography near Corner)

U. S. DEPARTMENT OF AGRICULTURE

FOREST SERVICE

Posted
A-21

CHIPPENAW NATIONAL FOREST

CORNERS OF THE PUBLIC SURVEY

T. 145 N. R. 27 W. 5 EA Mer.

Section 12

Corner common to Sections

1, 2, 35, and 36

Corner consists of a (not) in place

State condition

Dimensions above ground inches.

Sketch grooves, letters, figures, or notches, on proper face or edge.

CARDINAL POSITION

DIAGONAL POSITION

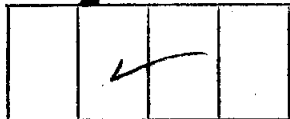

N W S E

NW SW SE NE

Mound of is located

Pits are located

Sketch markings of Bearing Trees (or Rocks) in proper box and fill blanks below, giving bearings from Corner to Trees and Distances in Links.

Empty box for sketching

145
S₂

Empty box for sketching

Empty box for sketching

Empty box for sketching

B.T.

Empty box for sketching

Empty box for sketching

Species Nor. Pine

Diameter 20

Bearing S. W

Distance 103

Do you believe this to be a genuine Land Office Corner? yes

If not, why?

Edward Jensen

Signature.

Estimator

11-1-29

Date.

Title.

(Make sketch of topography near corner.)

T. 145 N. R. 27 W. S. 24 Mer.

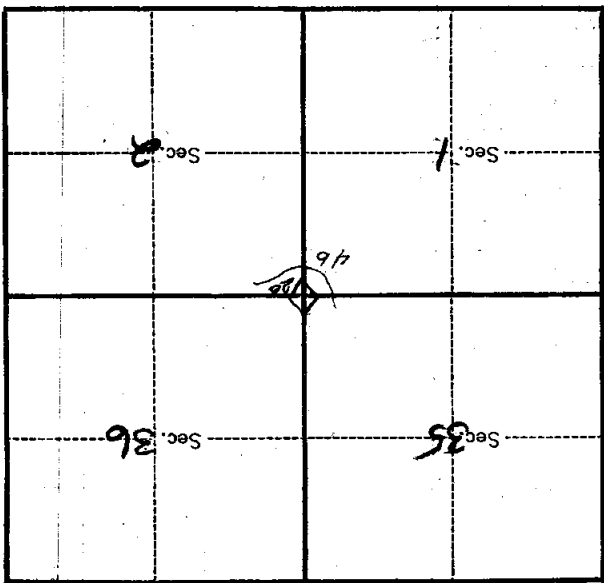

Metal Location Poster is on a spruce

tree 5 inches diameter, on the south

side of town line

from which this corner bears S 68° W

10 chains distant.

Give any further facts which will aid in finding this

Corner again.

Set a stake in approximate

location.