

Form 874-9—Revised May, 1918
 U. S. Department of Agriculture
 FOREST SERVICE

99

123
 T-19

Chippewa NATIONAL FOREST

CORNERS OF THE PUBLIC SURVEY

T. 14b N R. 27 W 5th. Mer.

1/4 Corner common to Sections
 26, and

Corner consists of a square stake in place
 State condition Rotted of at ground level

Dimensions above ground 40 inches.

Sketch grooves, letters, figures, or notches, on proper face or edge.

CARDINAL POSITION

DIAGONAL POSITION

I/4	I/4	I/4	I/4
S	S	S	S
N	W	S	E

NW	SW	SE	NE

Mound of is located

Pits are located

Sketch markings of Bearing Trees (or Rocks) in proper box and fill blanks below, giving bearings from Corner to Trees and Distances in Links.

I/4 S	I/4 S		
BT	BT		

Species Jack Pine J.P.

Diameter 10" 8"

Bearing S4W N71W

Distance 71ks. 231ks.

Do you believe this to be a genuine Land Office Corner?

If not, why?

Carl M. Handy

(Signature)

Chief of Party

(Title)

6-13-34

(Date)

Metal Location Poster is on a _____ inches diameter, on the _____ side of _____ from which this Corner bears _____ chains distant.

Give any further facts which will aid in finding this Corner again.

I B.T. is located off at ground level.

<p>Sec.</p>	<p>Sec.</p>
<p>Sec.</p> <p>1116 6 1000 B.C. 1000 1000</p>	<p>Sec.</p>

(Make sketch of topography near Corner)

U. S. Department of Agriculture
FOREST SERVICE

T-19

Chippewa NATIONAL FOREST

CORNERS OF THE PUBLIC SURVEY

T. 145 R. 27 Mer.

Center $\frac{1}{4}$ Corner common to Sections

and 26

Corner consists of a 3x3 scribed post (not) in place

State condition POOR

Dimensions above ground 15 inches

Sketch grooves, letters, figures, or notches, on proper face or edge.

CARDINAL POSITION

DIAGONAL POSITION

--	--	--	--

N W S E

--	--	--	--

NW SW SE NE

Mound of _____ is located _____

Pits are located _____

Sketch markings of Bearing Trees (or Rocks) in proper box and fill blanks below, giving bearings from Corner to Trees and Distances in Links.

No	B.T.s		

Species _____

Diameter NOTED

Bearing _____

Distance _____

Do you believe this to be a genuine Land Office Corner? No

If not, why? NO EVIDENCE OF

any B.T.s

(Signature)

3-17-58

(Date)

(Title)

I blazed line west to rd. Had put up tag on 12" R. pine west side of rd. Distance approx 850 ft East to $\frac{1}{4}$ cor.

Corner again.

Give any further facts which will aid in finding this

chains distant.

From which this Corner bears 138 ft N 30° E

side of tree

tree 5 inches diameter, on the North

Metal Location Poster is on a S. pine

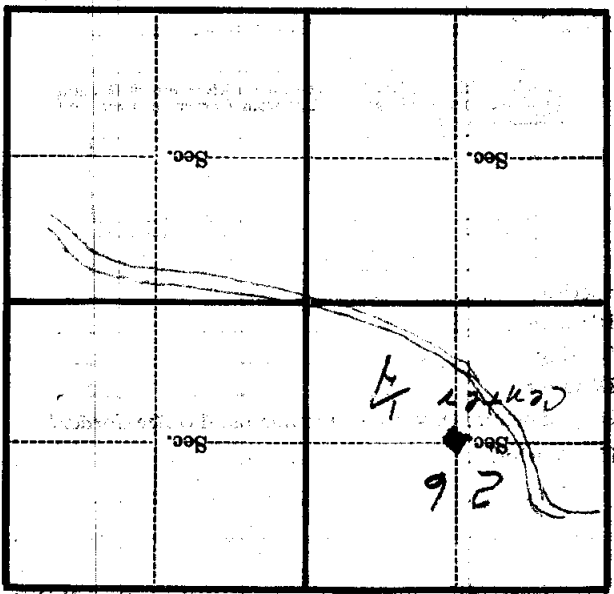

(Make sketch of topography near Corner)

T. 145 R. 07 S. 2 Mer. T-19