

Form 874-9—Revised May, 1918  
U. S. Department of Agriculture  
FOREST SERVICE

*Copied  
Posted  
5/31  
R-17*

----- NATIONAL FOREST  
**CORNERS OF THE PUBLIC SURVEY T-17**

T. 145 R. 27 Mer. 5

4 Corner common to Sections  
26, 27, and -----

Corner consists of a J P stake (not) in place  
State condition -----

Dimensions above ground ----- inches  
Sketch grooves, letters, figures, or notches, on proper face or edge.  
CARDINAL POSITION DIAGONAL POSITION

N	W	S	E

NW	SW	SE	NE

Mound of ----- is located -----

Pits are located -----

Sketch markings of Bearing Trees (or Rocks) in proper box and fill blanks below, giving bearings from Corner to Trees and Distances in Links.

Species -----

Diameter -----

Bearing -----

Distance -----

Do you believe this to be a genuine Land Office Corner? -----

If not, why? -----

-----  
-----

-----  
(Signature)

-----  
(Date)

-----  
(Title)

SECTION 27  
 SECTION 26  
 SECTION 25  
 SECTION 24  
 SECTION 23  
 SECTION 22  
 SECTION 21  
 SECTION 20  
 SECTION 19  
 SECTION 18  
 SECTION 17  
 SECTION 16  
 SECTION 15  
 SECTION 14  
 SECTION 13  
 SECTION 12  
 SECTION 11  
 SECTION 10  
 SECTION 9  
 SECTION 8  
 SECTION 7  
 SECTION 6  
 SECTION 5  
 SECTION 4  
 SECTION 3  
 SECTION 2  
 SECTION 1

sec 27 1 ft tree 10" in diam.  
 B F  
 sec 26 1 ft stand 2 ft high bearing

Corner again.

Give any further facts which will aid in finding this  
 chain distant  
 from which this Corner bears  
 side of  
 tree inches diameter, on the  
 Metal Location Poster is on a

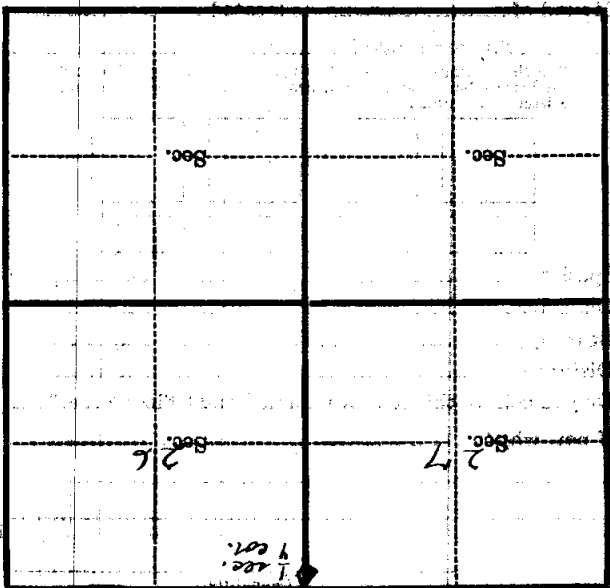

(Make sketch of topography near Corner)