

U. S. DEPARTMENT OF AGRICULTURE
FOREST SERVICE

Posted
A-11

Chippewa NATIONAL FOREST

CORNERS OF THE PUBLIC SURVEY

T. 145 N R. 27 W 5th Mer.

1/4 Corner common to Sections

....., 4, and 33

Corner consists of a ^{scribed} squared Stake (not) in place
State condition Good

Dimensions above ground 1 1/2 x 2 x 2 8 inches.

Sketch grooves, letters, figures, or notches, on proper face or edge.

CARDINAL POSITION

DIAGONAL POSITION

<u>1/4</u> <u>5</u>		<u>1/4</u> <u>5</u>	
N	W	S	E

NW	SW	SE	NE

Mound of ✓ is located ✓

✓ Pits are located ✓

Sketch markings of Bearing Trees (or Rocks) in proper box and fill blanks below, giving bearings from Corner to Trees and Distances in Links.

Species

Diameter

Bearing

Distance

Do you believe this to be a genuine Land Office Corner? yes

If not, why?

Edward J. ...
Signature.

11-9-29
Date.

Estimator
Title.

T. 145N R. 27W 5th Mer.

8-3027 (Make sketch of topography near Corner.)

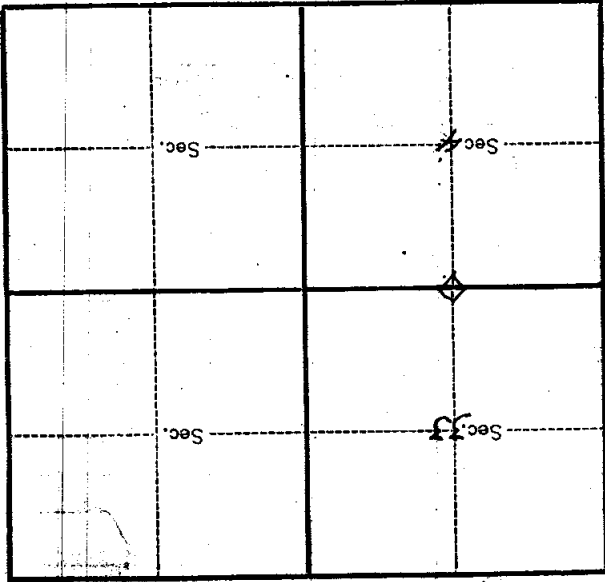

Metal Location Poster is on a *Tamarack*

tree *3* inches diameter, on the *NORTH*

side of *TOWN LINE*

from which this Corner bears *N 45° E*

180 chains distant.

Give any further facts which will aid in finding this

Corner again.

U. S. Department of Agriculture
FOREST SERVICE

A-11

Chippewa NATIONAL FOREST

CORNERS OF THE PUBLIC SURVEY

T. ¹⁴⁶*145* R. ²⁷*27* 5th PM Mer.

^{1/4} Corner common to Sections

A, *33*, and

Corner consists of a *yellow tag* (not) in place

State condition *Good*

Dimensions above ground *48* inches

Sketch grooves, letters, figures, or notches, on proper face or edge.

CARDINAL POSITION

DIAGONAL POSITION

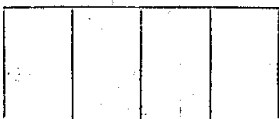
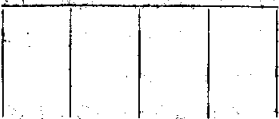

Mound of _____ is located _____

Pits are located _____

Sketch markings of Bearing Trees (or Rocks) in proper box and fill blanks below, giving bearings from Corner to Trees and Distances in Links.

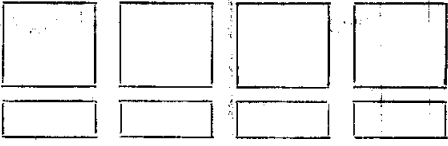

Species _____

Diameter _____

Bearing _____

Distance _____

Do you believe this to be a genuine Land Office Corner? *No*

If not, why? *No evidence of original corner*

found

Maxim K. Karvonen

(Signature)

1/16/59
(Date)

Asst Dist Forest Ranger
(Title)

Corner again.
 Old Negro log in the corner
 of a corner of what distance
 from point in the corner

Metal Location Poster is on a *Black Spruce*
 tree 8 inches diameter, on the *South*
 side of *the* from which this Corner bears
 chains distant.

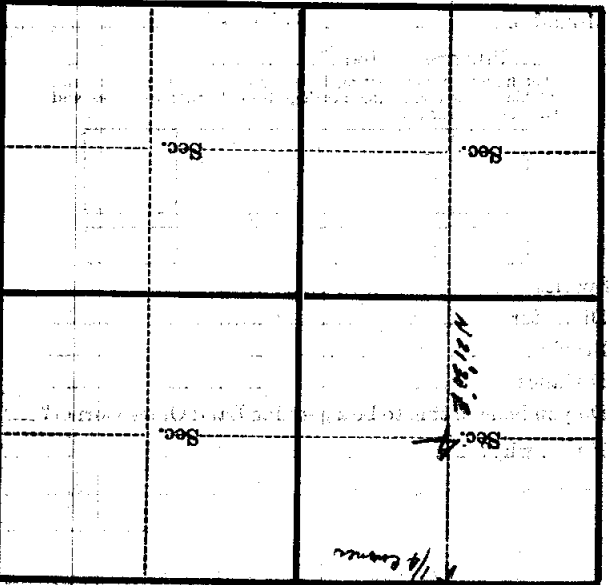

(Make sketch of topography near Corner)

T. 14 R. 27 S. 27
 Mer.

Form 874-9—Revised May, 1918
U. S. Department of Agriculture
FOREST SERVICE

*Copied
Posted
5/31
A-11*

----- NATIONAL FOREST

CORNERS OF THE PUBLIC SURVEY

T. 145,146 R. 27 Mer. 5

4 Corner common to Sections
4 33, and -----

Corner consists of a 3 1/2 tan stake (not) in place
State condition -----

Dimensions above ground ----- inches
Sketch grooves, letters, figures, or notches, on proper face or edge.

CARDINAL POSITION

N	W	S	E

DIAGONAL POSITION

NW	SW	SE	NE

Mound of ----- is located -----

Pits are located -----

Sketch markings of Bearing Trees (or Rocks) in proper box and fill blanks below, giving bearings from Corner to Trees and Distances in Links.

Species -----
Diameter -----
Bearing -----
Distance -----

Do you believe this to be a genuine Land Office Corner? -----

If not, why? -----

----- (Signature) -----

----- (Date) ----- (Title) -----

UNITED STATES GEOLOGICAL SURVEY
BUREAU OF GEOGRAPHIC NAMES

TITLE

CORNER OF THE PUBLIC SURVEY

Give any further facts which will aid in finding this corner again.

From which this corner bears
side of
tree inches diameter, on the
Metal Location Poster is on a

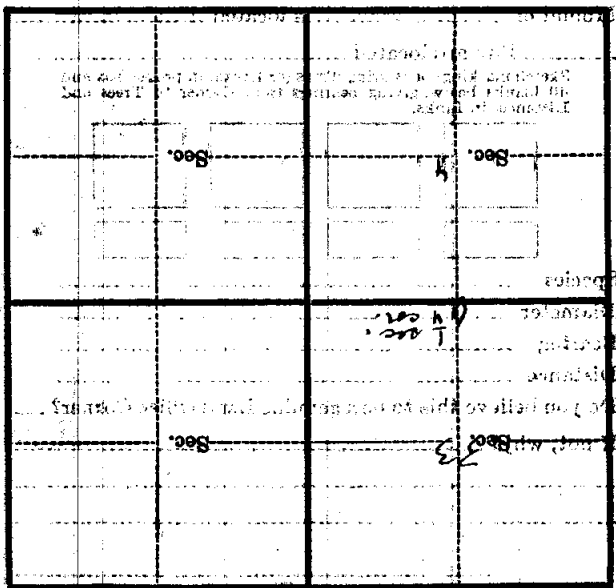

(Make sketch of topography near Corner)