

Form 874-9—Revised May, 1918
U. S. Department of Agriculture
FOREST SERVICE

4

123

E-11

Chippewa NATIONAL FOREST

CORNERS OF THE PUBLIC SURVEY

T. 145 R. 27 5th P. Mer.

1/4 section Corner common to Sections
4, and 9

Corner consists of a Squared Stake (not) in place
State condition Good

Dimensions above ground 36" inches.

Sketch grooves, letters, figures, or notches, on proper face or edge.

CARDINAL POSITION

DIAGONAL POSITION

N	W	S	E

NW	SW	SE	NE

Mound of _____ is located _____

Pits are located _____

Sketch markings of Bearing Trees (or Rocks) in proper box and fill blanks below, giving bearings from Corner to Trees and Distances in Links.

<u>1/4</u> <u>S</u>		<u>1/4</u> <u>S</u>	
------------------------	--	------------------------	--

<u>BT.</u>		<u>BT.</u>	
------------	--	------------	--

Species J.P. J.P. snag

Diameter 10" 10"

Bearing N

Distance 10'

Do you believe this to be a genuine Land Office Corner? Yes

If not, why? _____

J. Zasada
(Signature)

Tech. Foreman

1-17-34

(Date)

(Title)

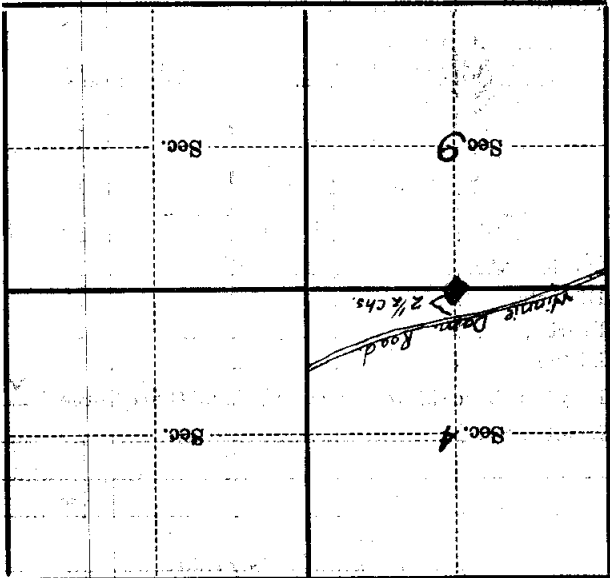

(Make sketch of topography near Corner)

T. 145 N. R. 27 W. S. 46 P. Mer.

Metal Location Poster is on a Jack Pine

tree 10" inches diameter, on the North

side of 1/4 corner stake

from which this Corner bears S

10' chains distant.

Give any further facts which will aid in finding this

Corner again.

Center is 2 1/2 chs South of

Fire pump on Winnie Dam

Road. It is located in a

metre Jack Pine stand.

Post on Winnie Dam Road

18 chs W of corner.

U. S. Department of Agriculture
FOREST SERVICE

E-11

NATIONAL FOREST

CORNERS OF THE PUBLIC SURVEY

T. 145 R. 27 5th Mer.

14 Corner common to Sections

4, and 9

Corner consists of a yellow tag (~~not~~) in place

State condition good

Dimensions above ground 48 inches

Sketch grooves, letters, figures, or notches, on proper face or edge.

CARDINAL POSITION

DIAGONAL POSITION

--	--	--	--

--	--	--	--

N W S E

NW SW SE NE

Mound of _____ is located _____

Pits are located _____

Sketch markings of Bearing Trees (or Rocks) in proper box and fill blanks below, giving bearings from Corner to Trees and Distances in Links.

Species _____

Diameter _____

Bearing _____

Distance _____

Do you believe this to be a genuine Land Office Corner? no

If not, why? No good evidence found

Merrill K. ...
(Signature)

1/16/59
(Date)

Asst Dist For Ranger
(Title)

Corner again.
 All corners are 2-20 Rod Pins
 the E-W line runs E 1/4 Corner
 from post to N on E 1/4 post

Give any further facts which will aid in finding this chains distant.

from which this Corner bears 15 Rods SW
 side of tree 18 inches diameter, on the South
 Metal Location Poster is on a Rod Pin

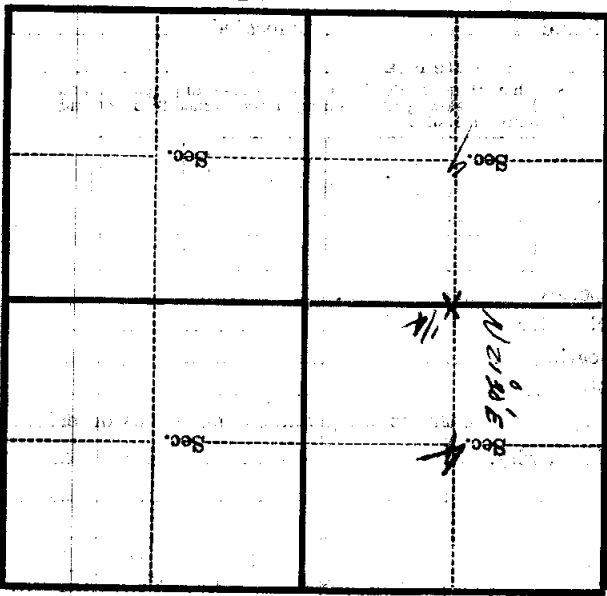

(Make sketch of topography near Corner)

T. 145 R. 27 Mer. 57

Form 874-9—Revised May, 1918
U. S. DEPARTMENT OF AGRICULTURE
FOREST SERVICE

Posted
E-11

Chippewa NATIONAL FOREST

CORNERS OF THE PUBLIC SURVEY

T. 145 N. R. 27 W. 5th Mer.

1/4 Corner common to Sections

-----, -----, 4, and 9

Corner consists of a Squared Stub in place
 State condition Fair

Dimensions above ground 9" x 15' inches.
 Sketch grooves, letters, figures, or notches, on proper face or edge.

CARDINAL POSITION

DIAGONAL POSITION

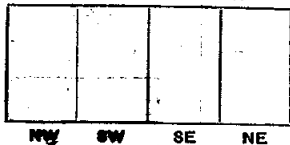
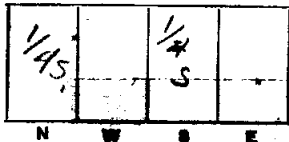

Mound of ✓ is located ✓

Pits are located

Sketch markings of Bearing Trees (or Rocks) in proper box and fill blanks below, giving bearings from Corner to Trees and Distances in Links.

<u>1/4 S</u>	<u>1/4 S</u>	<u>1/4 S</u>	<u>1/4 S</u>
<u>B.T.</u>	<u>B.T.</u>	<u>B.T.</u>	<u>B.T.</u>

Species	<u>J.P. Stub</u>	<u>J.P.</u>	<u>J.P.</u>	<u>J.P. snag</u>
Diameter	<u>11"</u>	<u>11"</u>	<u>10"</u>	<u>10"</u>
Bearing	<u>S 33° W</u>	<u>N 15° W</u>	<u>N</u>	
Distance	<u>16 Lks</u>	<u>15 Lks</u>	<u>10'</u>	

Do you believe this to be a genuine Land Office Corner? Yes
 If not, why? -----

3. Zasada
 Tech. Foreman.
Edward Jensen
 Signature.
1/17/34
10-15-29
 Date. Estimator
 Title. 8-3027

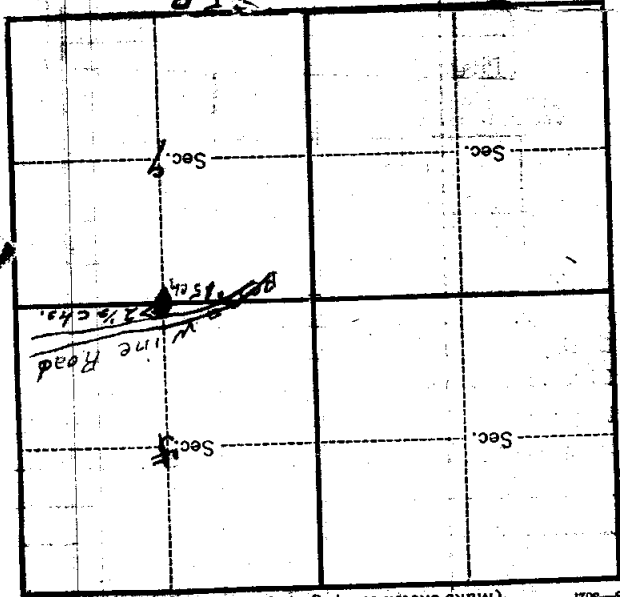

Metal Location Marker is on a Jack Pine bearing

tree 11 1/2 inches diameter on the North North

side of line 1/4 corner stake

from which this Corner bears N. 15° E. S.

15 10' chains distant.

Give any further facts which will aid in finding this

Corner again.

Bena-Winnie Road runs on N

or by a west sides of this corner

Corner is 2 1/2 chs. south of

fire pump on Winnie Dam Road.

It is located in a marker J.P.

stand.

Post on Winnie Dam Road

12 chs. W of cor