

U. S. DEPARTMENT OF AGRICULTURE
FOREST SERVICE

Posted
~~5-9~~
E-9

Chippewa NATIONAL FOREST

CORNERS OF THE PUBLIC SURVEY

T. 145 N R. 27 W 5th Mer.

section Corner common to Sections

4, 5, 8, and 9

Corner consists of a Squared Stake in place
State condition Fair

Dimensions above ground _____ inches.
Sketch grooves, letters, figures, or notches, on proper face or edge.

CARDINAL POSITION

DIAGONAL POSITION

N	W	S	E

S 5	S 8	S 9	
NW	SW	SE	NE

Mound of _____ is located _____

Pits are located _____

Sketch markings of Bearing Trees (or Rocks) in proper box and fill blanks below, giving bearings from Corner to Trees and Distances in Links.

T 145 N
R 27 W
S 4

BT

Species N. Pine Nox. Pine
Diameter 25 in 30"
Bearing N. 12° E N. of cor. N. 11° W
Distance 41 lks 1/2 ch.

Do you believe this to be a genuine Land Office Corner? Yes

If not, why? _____

Edward J. ...
Chief of Party

Signature.

10-15-29
Date.

Estimator
Title. E-9

T. 145 N. R. 27 W. 5th Mer.

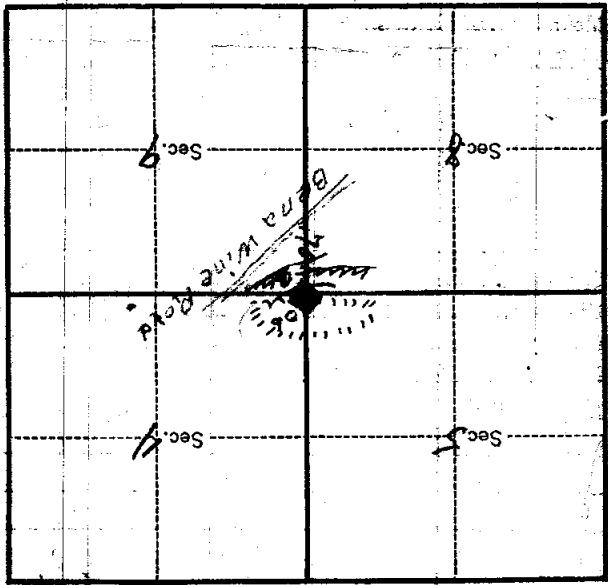

Metal Location Poster is on a Norway Pine

tree 2.530 inches diameter, on the North

side of line corner.

from which this Corner bears N12° E South

51 1/2 chains distant.

Give any further facts which will aid in finding this

Corner again,

Corner is on edge of cross

swamp. Set a new stake 2' x 2' x 40"

Corner is 7 chs. N of Minnie Dam.

Road. Location poster on road. The

corner is on the North side of a small

meadow. Cat face on B.T. points to

corner stake.

Form 874-9—Revised May, 1918
U. S. Department of Agriculture
FOREST SERVICE

123
E-9

Chippewa NATIONAL FOREST

CORNERS OF THE PUBLIC SURVEY.

T. 145N R. 27W 5th Mer.

Section Corner common to Sections
4, 5, 8, and 9

Corner consists of a square stake (not) in place
State condition Good

Dimensions above ground 2" x 94" inches.

Sketch grooves, letters, figures, or notches, on proper face or edge.

CARDINAL POSITION

DIAGONAL POSITION

--	--	--	--

N W S E

--	--	--	--

NW SW SE NE

Mound of _____ is located _____

Pits are located _____

Sketch markings of Bearing Trees (or Rocks) in proper box and fill blanks below, giving bearings from Corner to Trees and Distances in Links.

Species Norway Pine

Diameter 30"

Bearing N. of cor.

Distance 1/2 ch.

Do you believe this to be a genuine Land Office Corner? Yes

If not, why? Yes

Earl M. Handy

(Signature)

Chief of Party

(Date)

(Title)

Corner again.
 Corner is 7th N. of Williams
 Dam Road. The corner is on the
 North side of a small meadow
 1/2 mile on B. T. points to corner
 at this

Metal Location Poster is on a Norway Pine
 tree 30 inches diameter, on the North
 side of corner
 from which this Corner bears
 1/2 S 0° E
 chains distant.
 Give any further facts which will aid in finding this
 Corner again.

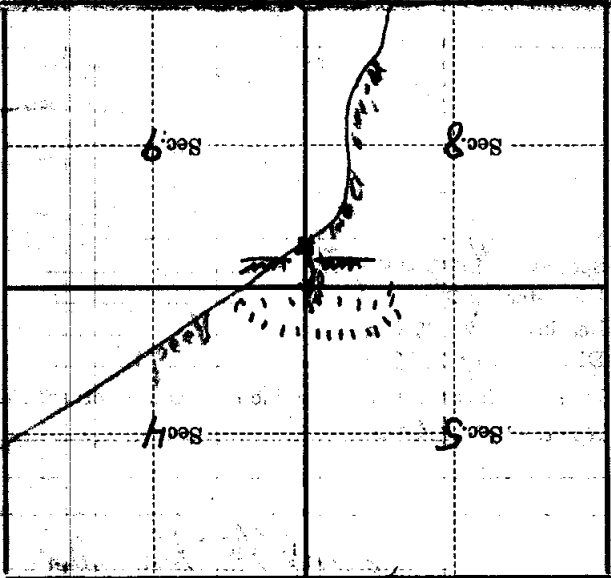

(Make sketch of topography near Corner)

T. 145 N. R. 27 W. Mer.