

U. S. DEPARTMENT OF AGRICULTURE
FOREST SERVICE

Posted
V-9

Chippewa NATIONAL FOREST

CORNERS OF THE PUBLIC SURVEY

T. 145 N R. 27 W 5th Mer.

Section

Corner common to Sections

29, 28, 32, and 33

DESCRIPTION OF CORNER

Corner consists of a squared stake

Dimension above ground 2x2x24. Rotten - Do not inches.

Sketch grooves, letters, figures, or notches, on proper face or edge.

CARDINAL POSITION

DIAGONAL POSITION

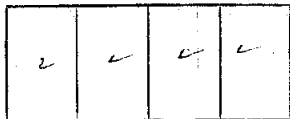
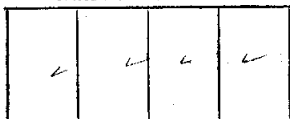

N W S E

NW SW SE NE

Mound of _____ is located _____

Pits are located _____

Sketch markings of Bearing Trees (or Rocks) in proper box and fill blanks below, giving bearings from Corner to Trees and Distances in Links.

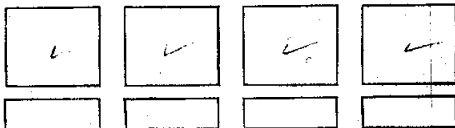

Species _____

Diameter _____

Bearing _____

Distance _____

Do you believe this to be a genuine Land Office Corner? Yes

If not, why? Blazed lines intersect at point There are no B.T.'s, and no iron stake.

Edward Inversin
Chief of Party

Signature.

Estimator

Title.

10-3-29

Date.

Title.

T. 145 N. R. 27 W. S. 4 Mer.

9-3021 (Make sketch of topography near corner.)

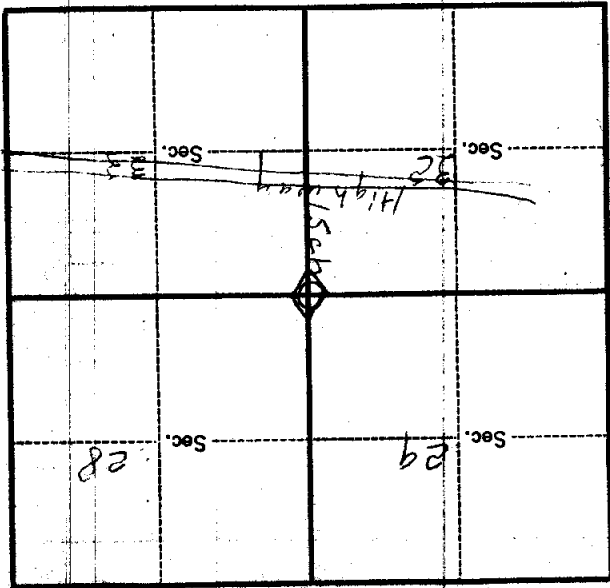

Metal Location Poster is on a *Aspen Aspen*

tree 5 8 inches diameter, on the *North NW*

side of *East-West* Section *hinge* corner.

from which this Corner bears *N 64 W 5 E*

180 21 lbs chains distant.

Give any further facts which will aid in finding this

Corner again.

• *Recall Poster on Highway H 8*

13.5 chs. S. of sec. cor. Gate

on L.P. Tree points to cor.

U. S. Department of Agriculture

FOREST SERVICE

301

123

N-9

Chippawa NATIONAL FOREST

CORNERS OF THE PUBLIC SURVEY

T. 145 N R. 27 W 5th Mer.

Section Corner common to Sections 28, 29, 32, and 33

Corner consists of a square stake (not) in place State condition good condition

Dimensions above ground 24 inches.

Sketch grooves, letters, figures, or notches, on proper face or edge.

CARDINAL POSITION

DIAGONAL POSITION

--	--	--	--

N W S E

--	--	--	--

NW SW SE NE

Mound of _____ is located _____

_____ Pits are located _____

Sketch markings of Bearing Trees (or Rocks) in proper box and fill blanks below, giving bearings from Corner to Trees and Distances in Links.

Species _____

Diameter _____

Bearing _____

Distance _____

Do you believe this to be a genuine Land Office Corner? no.

If not, why? There are no B.T.'s and no iron stake

Carl M. Handy

(Signature)

Chief of Party

(Title)

1-5-34

(Date)

Corner again.
2 sections on highway
No. 8. 13. 5 Ch. 5 of sec.
Cor. of base of h.p. to base
to cor.

Give any further facts which will aid in finding this

chains distant.

21

from which this Corner bears

S. E.

side of

Corner

tree 8 inches diameter, on the

N. W.

Metal Location Poster is on a

corner

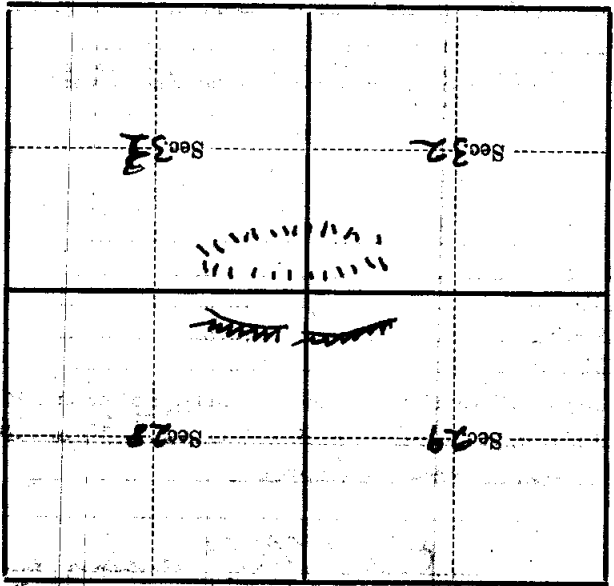

(Make sketch of topography near Corner)

T. 14 S N. R. 27 W. 5th Mer.