

U. S. DEPARTMENT OF AGRICULTURE
FOREST SERVICE

Posted

Chippewa NATIONAL FOREST

5-7

CORNERS OF THE PUBLIC SURVEY

T. *145 N*

R. *27 W*

5th Mer.

1/4 Corner common to Sections
8, 17, and

DESCRIPTION OF CORNER

Corner consists of a *5 stakes*
Dimension above ground *2' x 2' x 28"* inches.
Sketch grooves, letters, figures, or notches, on proper face or edge.

CARDINAL POSITION

DIAGONAL POSITION

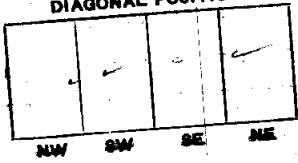
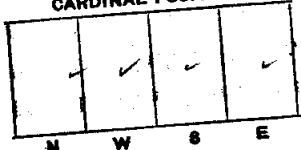

Mound of _____ is located _____

Pits are located _____

Sketch markings of Bearing Trees (or Rocks) in proper box and fill blanks below, giving bearings from Corner to Trees and Distances in Links.

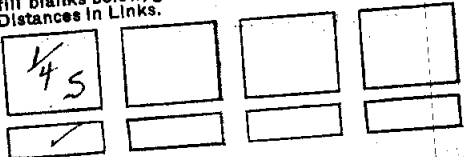

Species *Tam.*

Diameter *9"*

Bearing *S 82° E*

Distance *26 ch*

Do you believe this to be a genuine Land Office Corner? *yes*

If not, why? _____

Egil Juntunen
Signature.

Estimator
Title.

11/8/29
Date.

Corner again. *Tamara's logging camp*

Give any further facts which will aid in finding this

chains distant. *1/5*

from which this Corner bears

S 44° E

side of

E & W LINE

tree *2 1/2* inches diameter, on the

Metal Location Poster is on a *TAMARAC S*

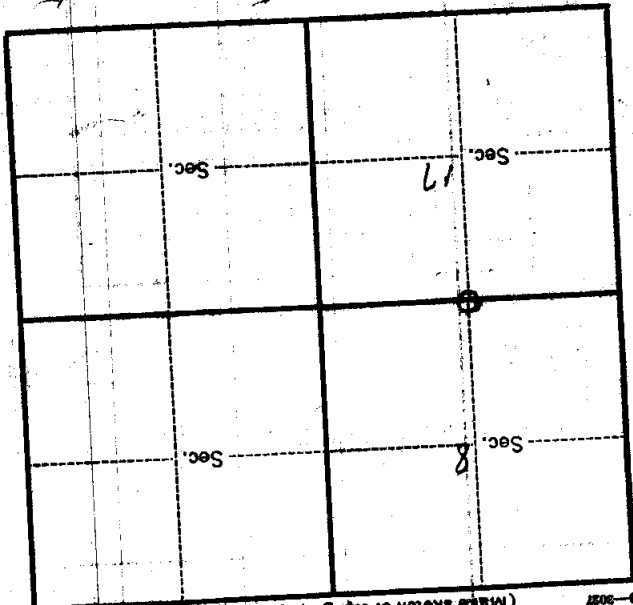

(Make sketch of topography near Corner.)

9-3027

T. 145 N R. 31 W

U. S. Department of Agriculture
FOREST SERVICE

Chippewa NATIONAL FOREST J-7

CORNERS OF THE PUBLIC SURVEY

T. 145 R. 27 5th Mer.

VA Corner common to Sections
8, and 17

Corner consists of a Sqd. Stake (net) in place
State condition Pres.

Dimensions above ground 2A inches.
Sketch grooves, letters, figures, or notches, on proper face or edge.

STONE CORNERS

METAL CORNERS

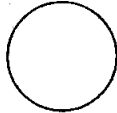
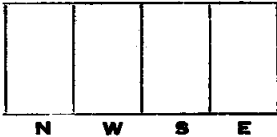

Mound of _____ is located _____

Pits are located _____

Sketch markings of Bearing Trees (or Rocks) in proper box and fill blanks below, giving bearings from Corner to Trees and Distances in Links.

<input type="checkbox"/>	<input type="checkbox"/>	<input type="checkbox"/>	<input type="checkbox"/>
<input type="checkbox"/>	<input type="checkbox"/>	<input type="checkbox"/>	<input type="checkbox"/>

Species _____

Diameter _____

Bearing _____

Distance _____

Do you believe this to be a genuine Land Office Corner? No

If not, why? No evidence

[Handwritten Signature]
(Signature)

3/28/61
(Date)

Forester
(Title)

T. 145 R. 27 Mer. 5-71

(Make sketch of topography near Corner and show section line markers thus "X")

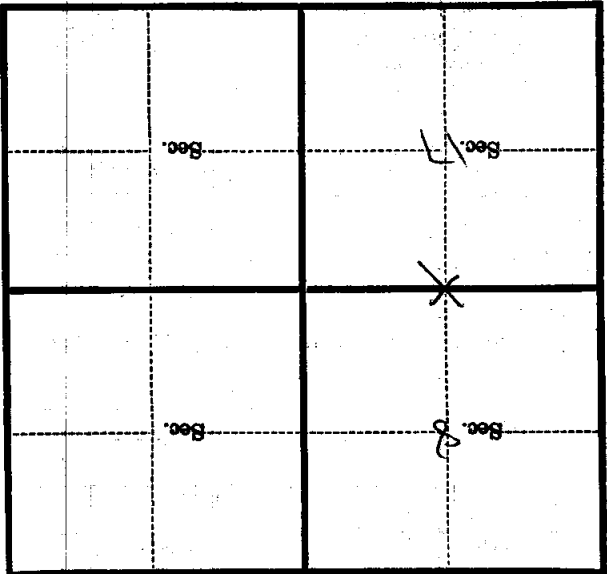

Metal Location Poster is on a Tarack tree 8 inches diameter, on the East side of NNW from which this Corner bears (Bearing) 71° and (Distance) 7 chains.

Section line marker between Secs. 17 and 8 is on

a tree on the East (Tree, post, etc.) (Name of road, trail, etc.)

located chains 17, N. 8, from Sec. Cor.; 1/2 Cor.; 1/4 Sec. Cor. (Cross out nonapplicable)

Give any further facts needed to find Corner again:

Blue line painted West from corner

1/16 A East of 1/4 A is 2 feet 22 ch 45 ft

Old Jay found at this 1/4 A