

Form 874-9—Revised May, 1918
U. S. Department of Agriculture
FOREST SERVICE

*all ready
for
R-5*

chippewa NATIONAL FOREST

CORNERS OF THE PUBLIC SURVEY

T. *145 N.* R. *27 W.* *5th* Mer.

Section Corner common to Sections
19, 20, 29, and 30

Corner consists of a *Squared post (not)* in place
State condition *Rotted at base and scorched.*

Dimensions above ground *2' 2"* inches.

Sketch grooves, letters, figures, or notches, on proper face or edge.
CARDINAL POSITION DIAGONAL POSITION

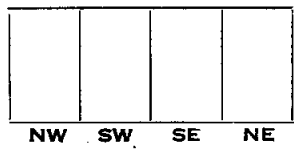
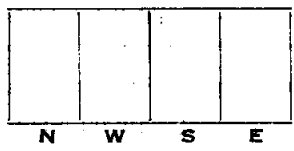

Mound of _____ is located _____

Pits are located _____

Sketch markings of Bearing Trees (or Rocks) in proper box and fill blanks below, giving bearings from Corner to Trees and Distances in Links.

No bearing trees

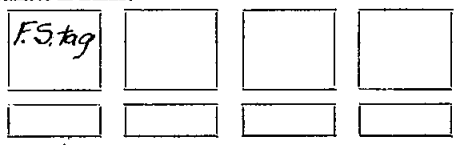

Species *Birch* _____

Diameter *10"* _____

Bearing *SE of stake* _____

Distance *67 LKS.* _____

Do you believe this to be a genuine Land Office Corner? *No* *Yes*

If not, why? _____

Earl Handy *same.*
(Signature)

CCC Surveyor
(Title)

12-1-33
(Date)

30-8

Corner again.
Location poster is on
Nushka trail, 3 chs N of
corner
This corner is 3 chs S of Nushka
trail. Location poster on trail.

Give any further facts which will aid in finding this

chains distant.

from which this Corner bears 67 Lks

side of stake

tree 10 inches diameter, on the S.E.

Metal Location Poster is on a Birch

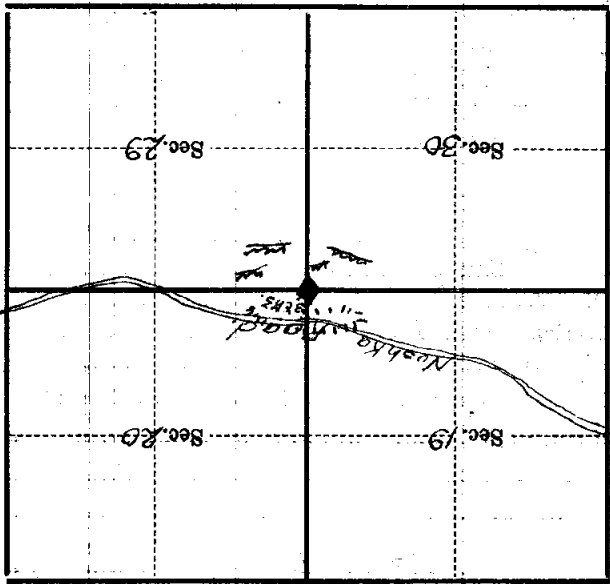

(Make sketch of topography near Corner)

T. 145 N. R. 27 W. 5th Mer.

Form 874-9—Revised May, 1918
U. S. Department of Agriculture
FOREST SERVICE

est
R-5

..... NATIONAL FOREST

CORNERS OF THE PUBLIC SURVEY

T. 115 R. 27 Mer.

..... Corner common to Sections

19, 20, 29, and 30

Corner consists of a Post (not) in place

State condition FAIR

Dimensions above ground 3' inches

Sketch grooves, letters, figures, or notches, on proper face or edge.

CARDINAL POSITION

DIAGONAL POSITION

--	--	--	--

N W S E

--	--	--	--

NW SW SE NE

Mound of is located

Pits are located

Sketch markings of Bearing Trees (or Rocks) in proper box and fill blanks below, giving bearings from Corner to Trees and Distances in Links.

Species

Diameter

Bearing

Distance

Do you believe this to be a genuine Land Office Corner?

If not, why?

.....

.....

.....

1/27/58
(Date)

(Signature)
W. E. Heron
(Title)

Corner again.
I claim North of
Tamarack country

Give any further facts which will aid in finding this
chains distant.
from which this Corner bears N 70 W
side of
tree 5 inches diameter, on the
West
Metal Location Poster is on a
W Birch

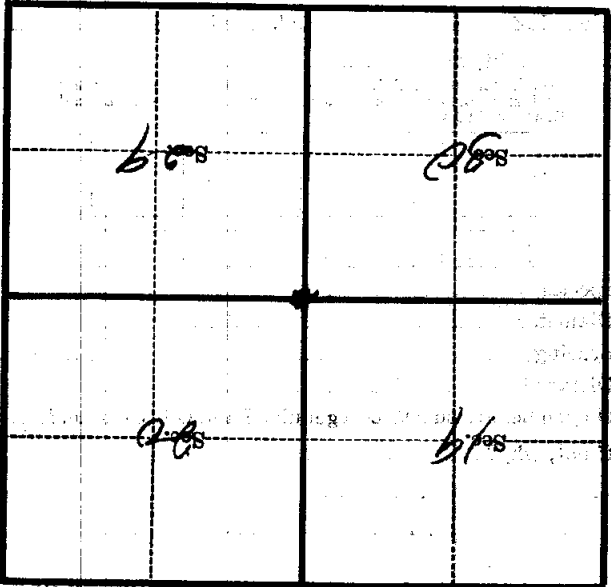

(Make sketch of topography near Corner)

U. S. DEPARTMENT OF AGRICULTURE
FOREST SERVICE

Posted
R-5

Chippewa NATIONAL FOREST

CORNERS OF THE PUBLIC SURVEY

T. 145 R. 27 S. 5 Mer.

Section Corner common to Sections
29, 30, 19, and 20

Corner consists of a square scribed (not) in place
State condition Burnt

Dimensions above ground 2 1/2" x 3 1/2" inches.

Sketch grooves, letters, figures, or notches, on proper face or edge.

CARDINAL POSITION

DIAGONAL POSITION

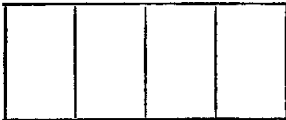

Mound of is located

Pits are located

Sketch markings of Bearing Trees (or Rocks) in proper box and fill blanks below, giving bearings from Corner to Trees and Distances in Links.



Species Birch

Diameter 10"

Bearing SE. of stake

Distance 67 1/2'

Do you believe this to be a genuine Land Office Corner? Yes *No*

If not, why?

Carl Handy

G.C.C. Surveyor

Emil Juntunen

Signature.

Estimator

12/1/33

10/15/29

Date.

Title.

No Bearing trees

T. 145 N. R. 27 W. 5 Mer.

8-3027 (Make sketch of topography near corner.)

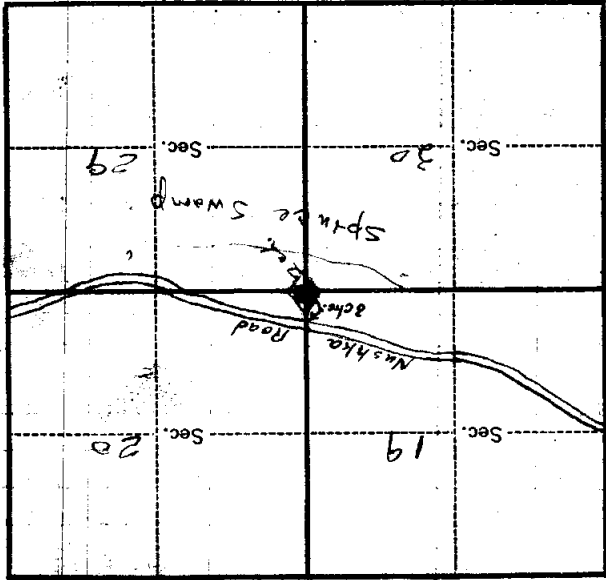

Metal Location Poster is on a White Birch

tree 10 1/2 inches diameter, on the SE SE side of E & W 4 S line stake

from which this Corner bears 1/2 ^{links} 62 chains distant.

Give any further facts which will aid in finding this

Corner again.

Stake bearing 9 ch

Location Poster is on Nushka

trail, 3 chs. N. of corner.