

U. S. Department of Agriculture
FOREST SERVICE

wt

5-5

NATIONAL FOREST

CORNERS OF THE PUBLIC SURVEY

T. 145 R. 27 Mer.

1/14 Corner common to Sections
29, 30, and

Corner consists of a WOOD POST (not) in place

State condition FAIR

Dimensions above ground 31 inches

Sketch grooves, letters, figures, or notches, on proper face or edge.

CARDINAL POSITION

DIAGONAL POSITION

--	--	--	--

N W S E

--	--	--	--

NW SW SE NE

Mound of _____ is located _____

Pits are located _____

Sketch markings of Bearing Trees (or Rocks) in proper box and fill blanks below, giving bearings from Corner to Trees and Distances in Links.

Species _____

Diameter _____

Bearing _____

Distance _____

Do you believe this to be a genuine Land Office Corner? _____

If not, why? _____

1/27/58
(Date)

(Signature) W. E. Nelson
(Title)

EDGE OF SWAMP
1/2 CHAIN SOUTH OF

Corner again.

Give any further facts which will aid in finding this

7 LK5 chains distant.

from which this Corner bears N 30 E

side of

tree 8 inches diameter, on the

Metal Location Poster is on a N. Point

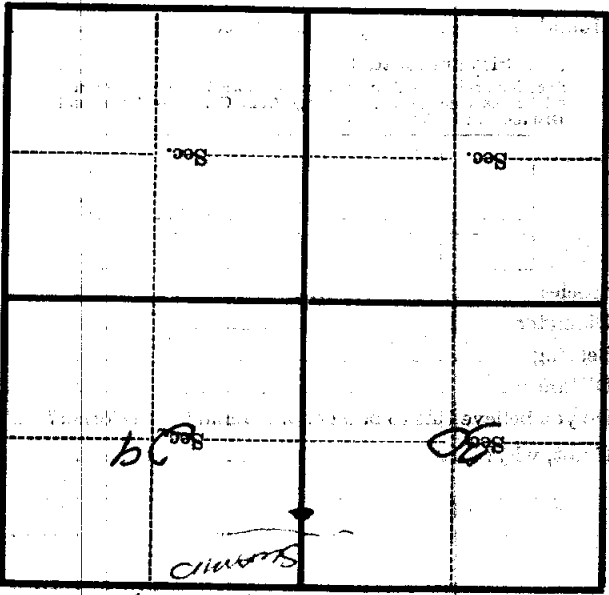

(Make sketch of topography near Corner)

T. R. Mer.