

U. S. DEPARTMENT OF AGRICULTURE

FOREST SERVICE

Posted
7-5

Chippewa NATIONAL FOREST

CORNERS OF THE PUBLIC SURVEY

T. 145 R. 27 5 Mer.

1/4 Cor. Corner common to Sections

29, 30, and

Corner consists of a squard stake in place

State condition good

Dimensions above ground 2 by 2 by 30 inches.

Sketch grooves, letters, figures, or notches, on proper face or edge.

CARDINAL POSITION

DIAGONAL POSITION

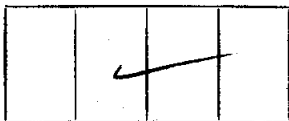
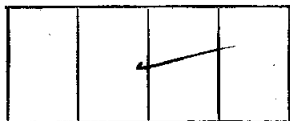

N W S E

NW SW SE NE

Mound of _____ is located _____

Pits are located _____

Sketch markings of Bearing Trees (or Rocks) in proper box and fill blanks below, giving bearings from Corner to Trees and Distances in Links.

Not
edgable

F. S. M.

.

-

.

Species stump J. P.

Diameter --- 3"

Bearing S 41 E S 40 E

Distance 60 lks 60 lks.

Do you believe this to be a genuine Land Office Corner? No

If not, why? Crushed corner on

old see line. Stake bears no scribing

found old But Not bearing toward present

Emil Juntunen H. A. Bull
C. C. C.

Signature.

12/6/33

10/9/29

Date.

Estimator

Title.

T. 145 N R. 27 W Mer. 5

9-2027 (Make sketch of topography near Corner.)

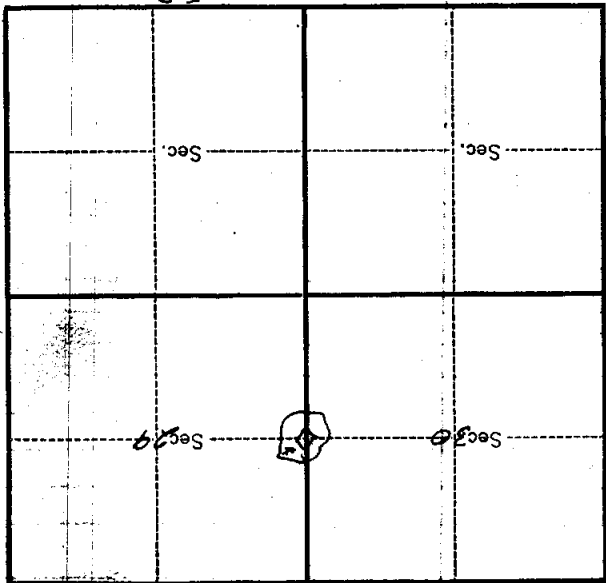

Metal Location Poster is on a *J.P. TINE* tree 53 inches diameter, on the *W NW 1/4*

side of *N 4 S line tree*

from which this Corner bears *N 85° E 540 E.*

60 lbs. 1/4 chains distant.

Give any further facts which will aid in finding this

Corner again.

Little Knob of *St. Louis*

TINE IN THE CENTER

of a CHAIN of grass, of a CHAIN SOUTH of it.

Form 874-9—Revised May, 1918
U. S. Department of Agriculture
FOREST SERVICE

99

123

Chippewa NATIONAL FOREST

T-5

CORNERS OF THE PUBLIC SURVEY

T. 145 R. 27 S. Mer.

$\frac{1}{4}$ Corner common to Sections
29, and 30

Corner consists of a wooden stake (not) in place
State condition Rotten at base

Dimensions above ground 24 inches.

Sketch grooves, letters, figures, or notches, on proper face or edge.

CARDINAL POSITION

DIAGONAL POSITION

--	--	--	--

N W S E

--	--	--	--

NW SW SE NE

Mound of _____ is located _____

Pits are located _____

Sketch markings of Bearing Trees (or Rocks) in proper box and fill blanks below, giving bearings from Corner to Trees and Distances in Links.

Not
locable

Forest
Service
Marker

Species Stump J.P.

Diameter 3 inches

Bearing S 41° E S 40° E

Distance 60 links 60 links

Do you believe this to be a genuine Land Office Corner? No

If not, why? Stake bears no scribbling

Found old bearing tree N. bearing

General present corner.

Howard B. Tills

(Signature)

12/6/33
(Date)

C.C.C. Surverax
Chief (Title) of party.

Corner again.

Give any further facts which will aid in finding this

60 Links chains distant.

from which this Corner bears S 40° E

side of ~~office~~

tree 3 inches diameter, on the SE NW

Metal Location Poster is on a Jack Pine

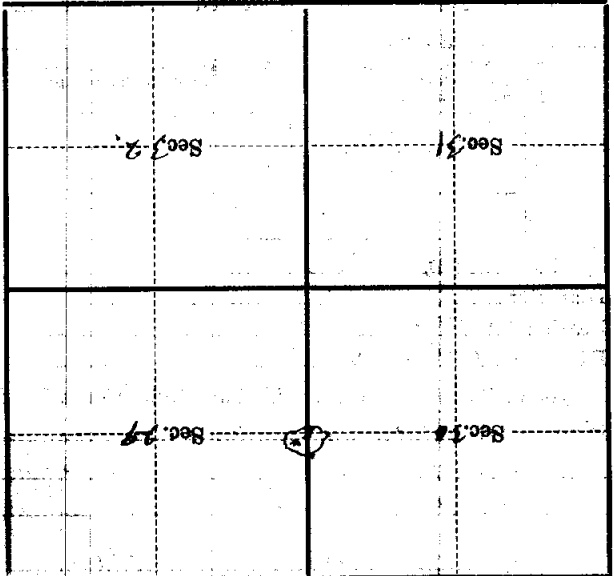

(Make sketch of topography near Corner)