

U. S. Department of Agriculture  
FOREST SERVICE

A-12

Chippewa NATIONAL FOREST

CORNERS OF THE PUBLIC SURVEY

T. 145 R. 26 Sth Mer.

1/4 Corner common to Sections  
4, \_\_\_\_\_, and \_\_\_\_\_

Corner consists of a yellow tin (not) in place  
State condition good

Dimensions above ground 54 inches

Sketch grooves, letters, figures, or notches, on proper face or edge.

CARDINAL POSITION

DIAGONAL POSITION

--	--	--	--

--	--	--	--

N W S E

NW SW SE NE

Mound of \_\_\_\_\_ is located \_\_\_\_\_

Pits are located \_\_\_\_\_

Sketch markings of Bearing Trees (or Rocks) in proper box and fill blanks below, giving bearings from Corner to Trees and Distances in Links.

Species \_\_\_\_\_

Diameter \_\_\_\_\_

Bearing \_\_\_\_\_

Distance \_\_\_\_\_

Do you believe this to be a genuine Land Office Corner? no

If not, why? no evidence found

M. K. Lauritzen

(Signature)

Forest Ranger

(Title)

8/13/59  
(Date)

Corner again.

Give any further facts which will aid in finding this

~~corner~~ distant.

from which this Corner bears

N 66° 40' W

side of

tree <sup>the</sup> inches diameter, on the

South

Metal Location Poster is on a

Look Post

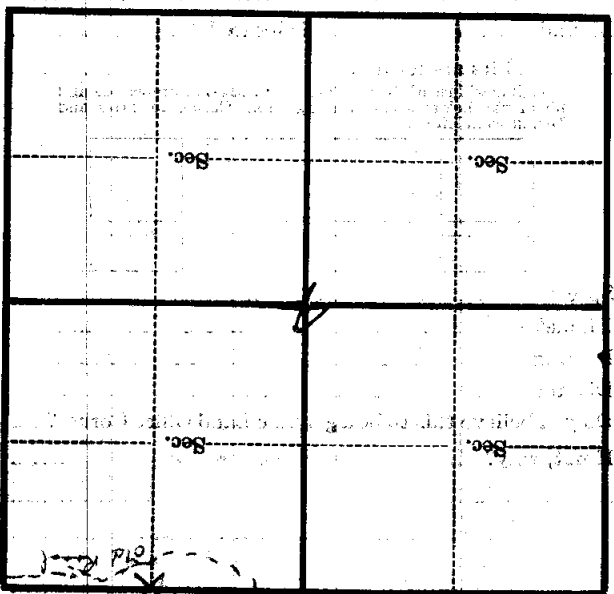

(Make sketch of topography near Corner)

Mer.

572

R. 26

T. 145