

Plotted
 Meander Section Corners btw. Sec's 25-26 on N. side of R. 24E

T 144N. R 31W Mer. 51A

Corner is

a Brass Cap/iron pipe

Height 6" above Gr.

Dia 1"

Marked (326/325) ME

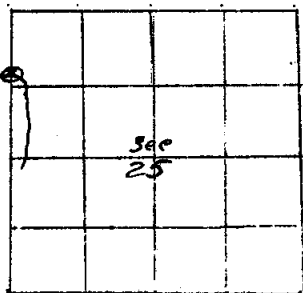

BEARING TREES

Marks MC. 325
BT.

Species Cedar.

Diameter 8"

Bearing N. 59° E.

Dist. ^{920'} ~~121~~ 121 1/2.

Metal poster on _____

Remarks: _____

Date 5/2/34 Signed J. A. Gjelhaug

