

U. S. Department of Agriculture

FOREST SERVICE

*posted*

*Chippewa* NATIONAL FOREST *TR 20*

CORNERS OF THE PUBLIC SURVEY

T. *144 N* R. *30 W* Mer. *5*  
*on center line*  
Corner common to Sections

....., *26*, and .....,  
Corner consists of a *Metal hub* (not) in place  
State condition *good*

Dimensions above ground *10* inches.

Sketch grooves, letters, figures, or notches, on proper face or edge.

CARDINAL POSITION

DIAGONAL POSITION

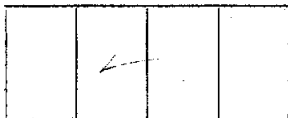
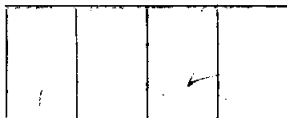

Mound of ..... is located .....

..... Pits are located .....

Sketch markings of Bearing Trees (or Rocks) in proper box and fill blanks below, giving bearings from Corner to Trees and Distances in Links.

<i>526 MC</i>	<i>526 MC</i>		
<i>BT</i>	<i>BT</i>		

Species	<i>Aspen</i>	<i>Elm</i>		
Diameter	<i>6"</i>	<i>9"</i>		
Bearing	<i>S 20° W</i>	<i>N 45° W</i>		
Distance	<i>19'</i>	<i>130'</i>		

Do you believe this to be a genuine Land Office Corner? *Yes*  
If not, why? .....

.....  
*W. J. Key*  
(Signature)  
.....  
(Date) (Title)

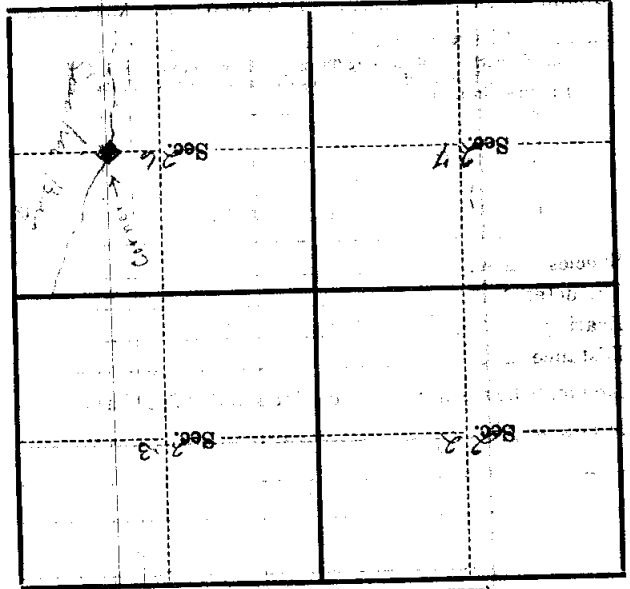

(Make sketch of topography near Corner)

T. 144 N. R. 30 W. S. 5 Mer. 20-21

Metal Location Poster is on a \_\_\_\_\_ inches diameter, on the \_\_\_\_\_ side of \_\_\_\_\_ from which this Corner bears \_\_\_\_\_ chains distant.

Give any further facts which will aid in finding this \_\_\_\_\_ Corner again:

Corner in a chain east of \_\_\_\_\_ line and a chain west of \_\_\_\_\_ north edge. Small tower of \_\_\_\_\_ on top of \_\_\_\_\_