

U. S. Department of Agriculture
FOREST SERVICE

J-9

Posted

Chippewa NATIONAL FOREST

J9

CORNERS OF THE PUBLIC SURVEY

T. *144N* R. *30W* Mer. *5th*

Section Corner common to Sections
16, 17, 8, and 9

Corner consists of a *Bronze in cement* (rod) in place
State condition *good*

Dimensions above ground *2"* inches

Sketch grooves, letters, figures, or notches, on proper face or edge.

CARDINAL POSITION

DIAGONAL POSITION

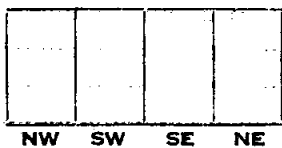
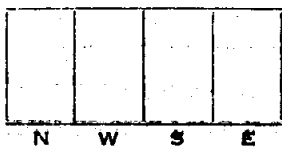

Mound of _____ is located _____

Pits are located _____

Sketch markings of Bearing Trees (or Rocks) in proper box and fill blanks below, giving bearings from Corner to Trees and Distances in Links.

317	38	39	316
B.T.	B.T.	B.T.	B.T.

Species	<i>W. Birch</i>	<i>W. Birch</i>	<i>Aspen</i>	<i>Aspen</i>
Diameter	<i>5"</i>	<i>4"</i>	<i>4"</i>	<i>9"</i>
Bearing	<i>S 50 1/2° W</i>	<i>N 23 1/2° W</i>	<i>N 43° E</i>	<i>S 72° 30' E</i>
Distance	<i>37 3/4</i>	<i>50 1/2</i>	<i>5 1/2</i>	<i>18 1/2</i>

Do you believe this to be a genuine Land Office Corner? *Yes*

If not, why? _____

Harold B. Rose
(Signature)

9/19/34
(Date)

Compassman
(Title)

J-9



Corner again.

Give any further facts which will aid in finding this

5 1/2 miles distant.

from which this Corner bears S 93° W

side of tree.

tree 4 inches diameter, on the SW

Metal Location Poster is on a *Aspen*.

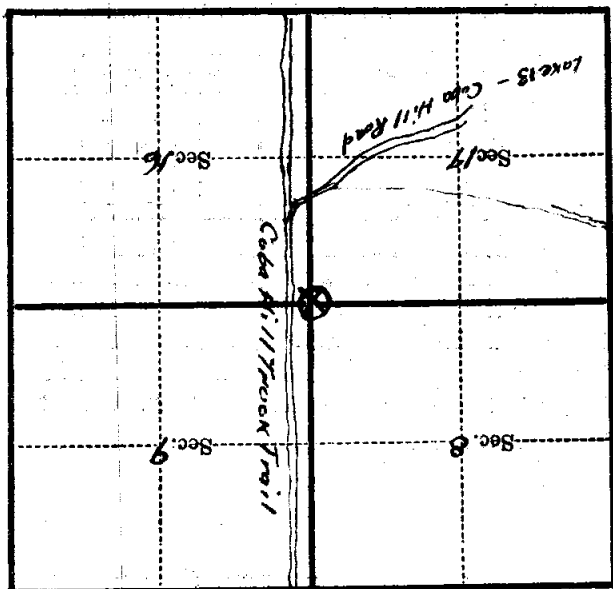

(Make sketch of topography near Corner)

T. 144 N. R. 30 W. S 17 E. Mer. 15-9