

U. S. Department of Agriculture  
FOREST SERVICE

Pasted 55

Chippewa NATIONAL FOREST  
CORNERS OF THE PUBLIC SURVEY

T. 144N R. 30W 5<sup>th</sup> Mer.

1/16 Corner common to Sections 30, and 29

Corner consists of a B.C. Coped 1" (not) in place  
State condition good

Dimensions above ground 10" inches  
Sketch grooves, letters, figures, or notches, on proper face or edge.

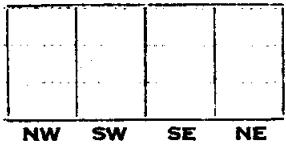
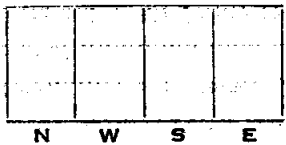

Mound of \_\_\_\_\_ is located \_\_\_\_\_

Pits are located \_\_\_\_\_

Sketch markings of Bearing Trees (or Rocks) in proper box and fill blanks below, giving bearings from Corner to Trees and Distances in Links.

<u>N</u> <u>1/16</u> <u>529</u>	<u>N</u> <u>1/16</u> <u>530</u>		
<u>B.T.</u>	<u>B.T.</u>		

Species H. Maple H. Maple

Diameter 8" 6"

Bearing N 45° 45' E N 72° 45' W

Distance 23 53

Do you believe this to be a genuine Land Office Corner? Yes

If not, why? \_\_\_\_\_

Harold B. Rose

(Signature)

8/27/39  
(Date)

Compassman  
(Title)

Sec 31  
N  
1/2

Corner again.

Give any further facts which will aid in finding this  
chains distant.  
from which this Corner bears  
side of  
tree inches diameter, on the  
Metal Location Poster is on a *None*

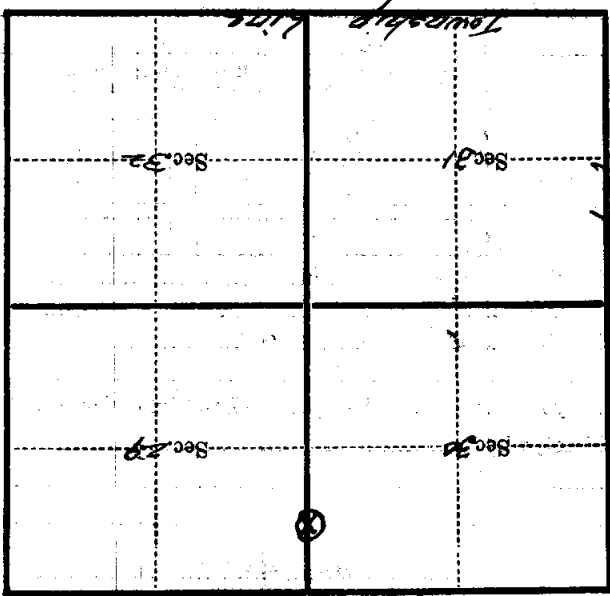

(Make sketch of topography near Corner)

T 199 N R 30 W  
5th Mer.  
S-S