

**U. S. DEPARTMENT OF AGRICULTURE**  
**FOREST SERVICE**

*Postle*

Chippewa NATIONAL FOREST

**CORNERS OF THE PUBLIC SURVEY**

T. 144 R. 29 W 5<sup>th</sup> Mer.

1/4 Corner common to Sections

12, 13, and

Corner consists of a metal stake (not) in place

State condition good

Dimensions above ground 16" inches.

Sketch grooves, letters, figures, or notches, on proper face or edge.

**CARDINAL POSITION**

**DIAGONAL POSITION**

<u>S12 1/4</u>	<u>S13</u>		
N	W	S	E

NW	SW	SE	NE

Mound of \_\_\_\_\_ is located \_\_\_\_\_

Pits are located \_\_\_\_\_

Sketch markings of Bearing Trees (or Rocks) in proper box and fill blanks below, giving bearings from Corner to Trees and Distances in Links.

<u>1/4 S</u>	<u>1/4 S</u>		
<u>B.T.</u>	<u>B.T.</u>		

Species Tam (d) Tam (d.d)

Diameter 8" 11"

Bearing N 63° E N 63° W

Distance 10 ft. 10 ft.

Do you believe this to be a genuine Land Office Corner? Yes

If not, why? \_\_\_\_\_

E. J. Jentunen  
Signature.

3/7/31 Date

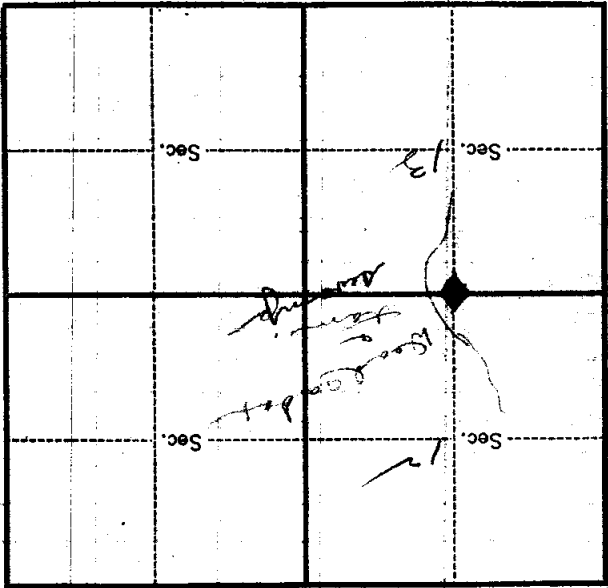

Metal Location Poster is on a

tree inches diameter, on the

side of

from which this Corner bears

chains distant.

Give any further facts which will aid in finding this

Corner again.

*The best case  
 of Township survey  
 of Meridian survey  
 of road*