

Form 874-B—Revised May, 1918
U. S. Department of Agriculture
FOREST SERVICE

✓
Chippewa NATIONAL FOREST
CORNERS OF THE PUBLIC SURVEY

T. 144 N R. 29 W Mer.

1/16 Corner common to Sections
1, and 2

Corner consists of a Weed Stake (not) in place
State condition all rotted away but 6" Top

Dimensions above ground _____ inches

Sketch grooves, letters, figures, or notches, on proper face or edge.

CARDINAL POSITION

DIAGONAL POSITION

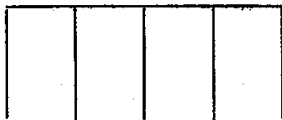
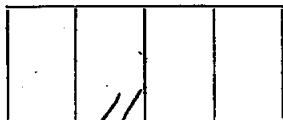

Mound of _____ is located _____

_____ Pits are located _____

Sketch markings of Bearing Trees (or Rocks) in proper box and fill blanks below, giving bearings from Corner to Trees and Distances in Links.

<u>S 1/16</u>			

Species oak

Diameter 12

Bearing N 40° E

Distance 49 Ls.

Do you believe this to be a genuine Land Office Corner? yes.

If not, why? _____

Hanson
(Signature)

12/6/35
(Date)

Metal Location Poster is on a *Sack Pine*
 tree *6* inches diameter, on the *North*
 side of *Trees*
 from which this Corner bears
N 50 E
1375 chains distant.
 Give any further facts which will aid in finding this
 Corner again.
Only Part of
scribing left on stake

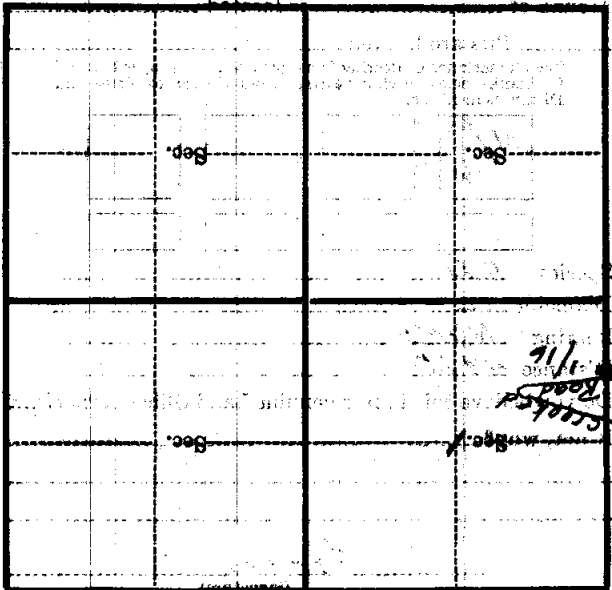

(Make sketch of topography near Corner)

U. S. Department of Agriculture
FOREST SERVICE

Chippewa NATIONAL FOREST

CORNERS OF THE PUBLIC SURVEY

T. 144 N. R. 29 W. 5th Mer.

1/16 Corner common to Sections

11, and 12
Corner consists of a U.S. G.L.O. S. IRON PIPE (not) in place

State condition good

Dimensions above ground 12 inches

Sketch grooves, letters, figures, or notches, on proper face or edge.

CARDINAL POSITION

DIAGONAL POSITION

--	--	--	--

N W S E

--	--	--	--

NW SW SE NE

Mound of _____ is located _____

Pits are located _____

Sketch markings of Bearing Trees (or Rocks) in proper box and fill blanks below, giving bearings from Corner to Trees and Distances in Links.

Species J.P.

Diameter 12"

Bearing N-NE

Distance 3.5 paces

Do you believe this to be a genuine Land Office Corner? yes

If not, why? _____

Max von Dahlen

(Signature)

Tech. Foreman

(Title)

12/9/33
(Date)

U. S. DEPARTMENT OF AGRICULTURE

FOREST SERVICE

CONTINUATION OF THE FIELD NOTES

This to sec. cor. is on an old logging trail leading East to Leech Lake Road.

Corner again!

Give any further facts which will aid in finding this

chain distant.

from which this Corner bears

side of

tree inches diameter, on the

Metal Location Poster is on a

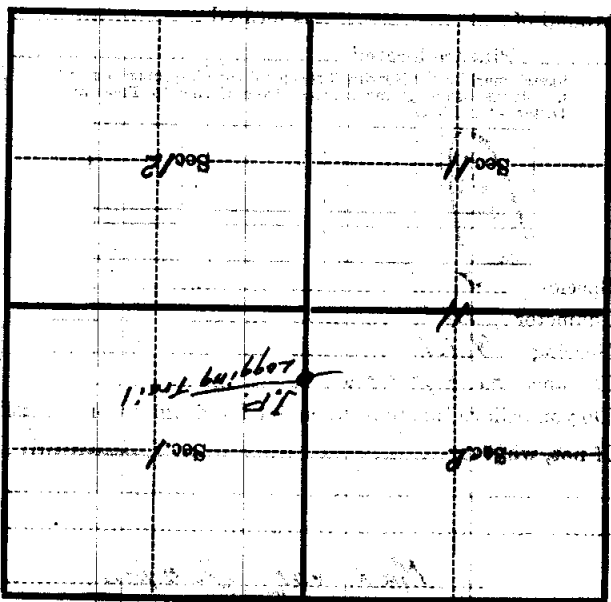

(Make sketch of topography near Corner)

T. 144N R. 29W S. 14 Mer.

U. S. Department of Agriculture

FOREST SERVICE

Chippewa NATIONAL FOREST

CORNERS OF THE PUBLIC SURVEY

T. 144N R. 29W Mer.

1116

Corner common to Sections

1, and 2

Corner consists of a Wood Stake (not in place State condition All rotted away but 6" of top

Dimensions above ground inches

Sketch grooves, letters, figures, or notches, on proper face or edge.

CARDINAL POSITION

DIAGONAL POSITION



N W S E

NW SW SE NE

Mound of is located

Pits are located

Sketch markings of Bearing Trees (or Rocks) in proper box and fill blanks below, giving bearings from Corner to Trees and Distances in Links.



Species Oak

Diameter 12"

Bearing N40E

Distance 49 Links

Do you believe this to be a genuine Land Office Corner? Yes

If not, why?

Hanson (Signature)

12/6/35 (Date)

(Title)

(Make sketch of topography near Corner)

	Sec.		Sec.
	Sec.		Sec. 1

Metal Location Poster is on a **Black Pine**

tree 6 inches diameter, on the **North**

side of **Tree**

from which this Corner bears **N 50 E**

~~13.1 miles~~ distant.

Give any further facts which will aid in finding this

Corner again.

ONLY PART OF

scribbling left on

stake.