

Form 874-9—Revised May, 1918
 U. S. Department of Agriculture
 FOREST SERVICE

Chippewa NATIONAL FOREST
 CORNERS OF THE PUBLIC SURVEY

T. 144N R. 29W Mer.

Sec. 11/16 Corner common to Sections
 _____, _____, 11, and _____

Corner consists of a Iron Pipe (not) in place
 State condition Good

Dimensions above ground 12" high inches
 Sketch grooves, letters, figures, or notches, on proper face or edge.

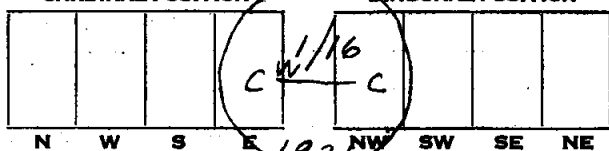

Mound of _____ is located _____

Pits are located _____

Sketch markings of Bearing Trees (or Rocks) in proper box and fill blanks below, giving bearings from Corner to Trees and Distances in Links.

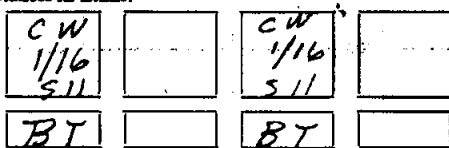

Species Cedar Cedar snag 5' high

Diameter 12 6"

Bearing N 67 W N 65 W

Distance 14 15

Do you believe this to be a genuine Land Office Corner? Yes

If not, why? _____

H. Hanson
 (Signature)

1/7/36
 (Date)

(Make sketch of topography near Corner)

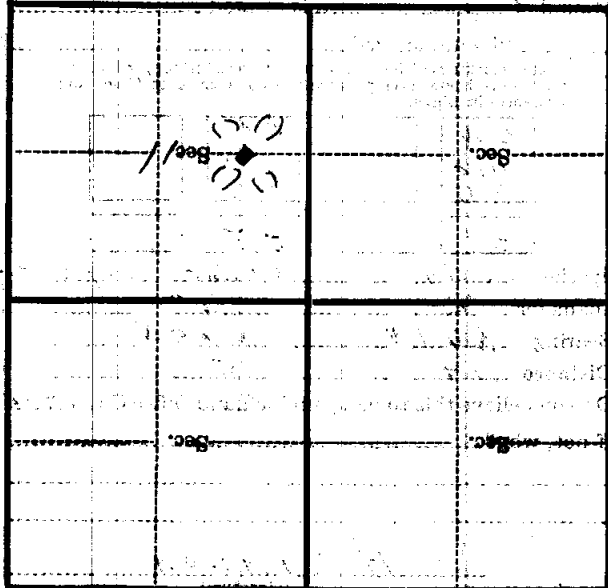

Metal Location Poster is on a Cedar tree 10 inches diameter, on the North side of Tree

from which this Corner bears N. 21. E

35 LKs, chains distant.

Give any further facts which will aid in finding this

Corner again.

U. S. Department of Agriculture
FOREST SERVICE

Chippewa NATIONAL FOREST

123

CORNERS OF THE PUBLIC SURVEY

T. 144N R. 29W. Mer.

W.C. 1/16 Corner common to Sections

11, and

Corner consists of a iron pipe (not) in place

State condition Good

Dimensions above ground 12" high inches

Sketch grooves, letters, figures, or notches, on proper face or edge.

CARDINAL POSITION DIAGONAL POSITION

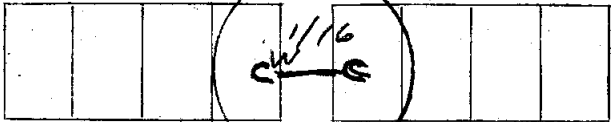

Mound of is located

Pits are located

Sketch markings of Bearing Trees (or Rocks) in proper box and fill blanks below, giving bearings from Corner to Trees and Distances in Links.

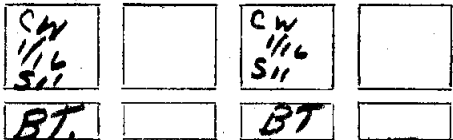

Species Cedar Cedar 5' high

Diameter 12" 6"

Bearing N67W N65W

Distance 14 15

Do you believe this to be a genuine Land Office Corner? Yes

If not, why?

HANSON (Signature)

1/7/36 (Date)

(Title)

U. S. Department of Agriculture
FOREST SERVICE

NATIONAL FOREST

CORNERS OF THE PUBLIC SURVEY

T. 144 R. 29 Mer.

CW 116 Corner common to Sections
11, and

Corner consists of a (not) in place

State condition

Dimensions above ground inches

Sketch grooves, letters, figures, or notches, on proper face or edge.

CARDINAL POSITION

DIAGONAL POSITION

--	--	--	--

--	--	--	--

N W S E

NW SW SE NE

Mound of is located

Pits are located

Sketch markings of Bearing Trees (or Rocks) in proper box and
fill blanks below, giving bearings from Corner to Trees and
Distances in Links.

Species

Diameter

Bearing

Distance

Do you believe this to be a genuine Land Office Corner?

If not, why?

(Signature)

(Date)

Corner again.

OK Logging Trail
Poster

Give any further facts which will aid in finding this
to chains distant.

from which this Corner bears
side of

Metal Location Poster is on a
tree 10 inches diameter, on the
E 1/4 Sec 1
South

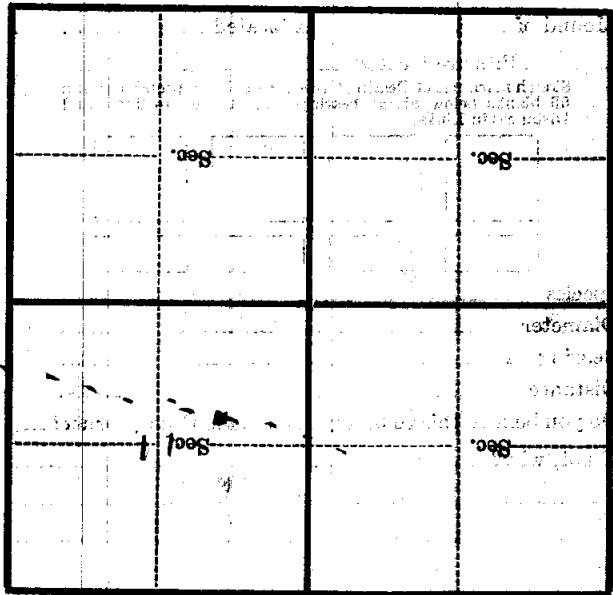

(Make sketch of topography near Corner)

T. 144 R. 29
G-18
Mer.