

U. S. Department of Agriculture
FOREST SERVICE

Chippewa NATIONAL FOREST

123

CORNERS OF THE PUBLIC SURVEY

T. 14th N R. 29 W 5th Mer.

Section Corner common to Sections

21, 22, 27, and 28

Corner consists of a iron pipe with cap (not) in place

State condition Good

Dimensions above ground 10" high inches

Sketch grooves, letters, figures, or notches, on proper face or edge.

CARDINAL POSITION DRAGONAL POSITION

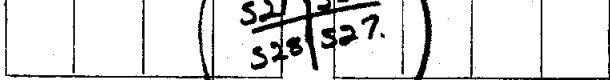

Mound of 1926 is located

Pits are located

Sketch markings of Bearing Trees (or Rocks) in proper box and fill blanks below, giving bearings from Corner to Trees and Distances in Links.

T14N R29W 327	T14N R29W 3.28	T14N R29W 522	T14N R29W 321
---------------------	----------------------	---------------------	---------------------

BT.	BT.	BT	B.T.
-----	-----	----	------

Species Birch Balsam Oak Balsam

Diameter 9" 10" 12" 14"

Bearing S30°E S55°W N7°E N25°W

Distance 27 Links 19 Link 35 Link 5 Link

Do you believe this to be a genuine Land Office Corner? Yes

If not, why?

H. HANSON
(Signature)

12/27/35
(Date)

(Title)

Corner again.

Give any further facts which will aid in finding this

chains distant.

from which this Corner bears

N 30 E

side of

Tree

tree 10 inches diameter, on the North

Metal Location Poster is on a

Birch

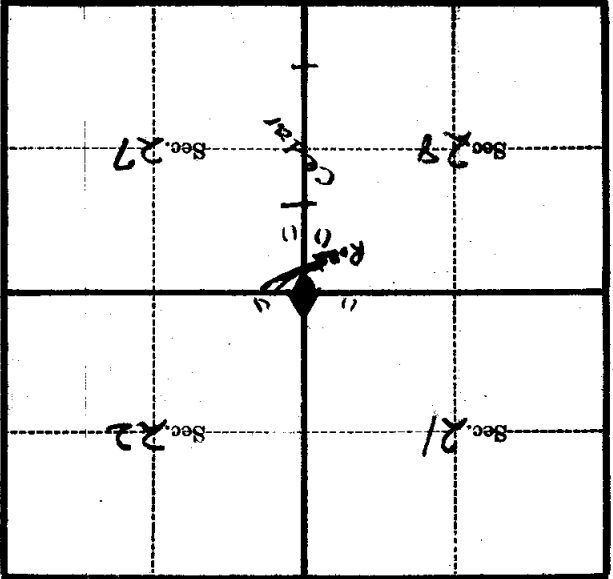

(Make sketch of topography near Corner)

T. 144 N R. 29 W 6-75 R-13 Mer.

U. S. DEPARTMENT OF AGRICULTURE
FOREST SERVICE

posted

Chippewa NATIONAL FOREST

CORNERS OF THE PUBLIC SURVEY

T. 144 R. 29 S. 5 Mer.

Sec. C Corner common to Sections
21, 22, 27, and 28

Corner consists of a Metal Stake in place
State condition good

Dimensions above ground 6" inches.
Sketch grooves, letters, figures, or notches, on proper face or edge.

CARDINAL POSITION

DIAGONAL POSITION

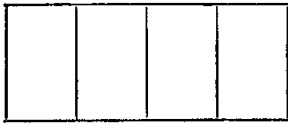

N

W

S

E

NW

SW

SE

NE

Mound of _____ is located _____

Pits are located _____

Sketch markings of Bearing Trees (or Rocks) in proper box and fill blanks below, giving bearings from Corner to Trees and Distances in Links.

T 144
R 29
S 21

T 144
R 29
S 28

T 144
R 29
S 27

T 144
R 29
S 22

BT

BT

BT

BT

Species	<u>Balsam</u>	<u>Balsam</u>	<u>(Y) Birch</u>	<u>Maple</u>
Diameter	<u>10"</u>	<u>10"</u>	<u>7"</u>	<u>14"</u>
Bearing	<u>N 31° E</u>	<u>S 53° W</u>	<u>S 36° E</u>	<u>N</u>
Distance	<u>4 lks</u>	<u>18 lks</u>	<u>25 lks</u>	<u>36 lks</u>

Do you believe this to be a genuine Land Office Corner? Yes

If not, why? _____

R. Willis

Signature.

Dec 2, 1930

Date.

Estimator

Title.

T. 144 R. 29
Mer. R-13

9-2027

(Make sketch of topography near Corner.)

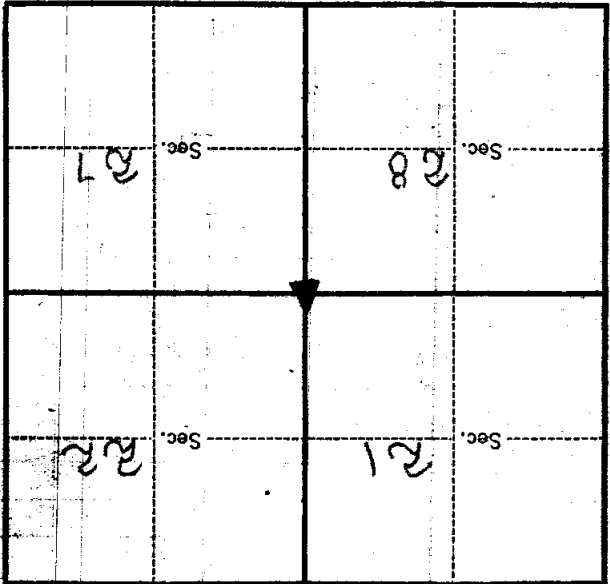

Metal Location Poster is on a _____ inches diameter, on the _____ side of _____ from which this Corner bears _____ chains distant.
Give any further facts which will aid in finding this Corner again.

already
P.O.

U. S. Department of Agriculture
FOREST SERVICE

Chippewa NATIONAL FOREST

CORNERS OF THE PUBLIC SURVEY

T. 144N. R. 29W. S. 5 Mer.

Section Corner common to Sections
21, 22, 27, and 28

Corner consists of a iron pipe with cap (not) in place
State condition Good

Dimensions above ground 10" high inches
Sketch grooves, letters, figures, or notches, on proper face or edge.

CARDINAL POSITION

DIAGONAL POSITION

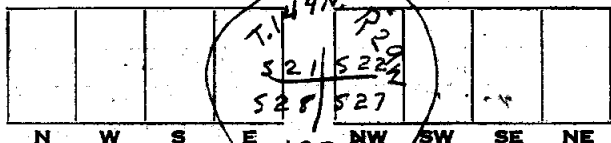

Mound of _____ is located _____

Pits are located _____

Sketch markings of Bearing Trees (or Rocks) in proper box and fill blanks below, giving bearings from Corner to Trees and Distances in Links.

T. 144N R. 29W S. 27	T. 144N R. 29W S. 28	T. 144N R. 29W S. 22	T. 144N R. 29W S. 21
B. T.	B. T.	B. T.	B. T.

Species Birch Balsam Oak Balsam

Diameter 8" 10" 12" 14"

Bearing S 30° E S 65° W N 7° E N 25° W

Distance 27 lks. 19 lks. 35 lks. 5 lks.

Do you believe this to be a genuine Land Office Corner? Yes.

If not, why? _____

H. Hanson
(Signature)

12/27/35
(Date)

(Make sketch of topography near corner)

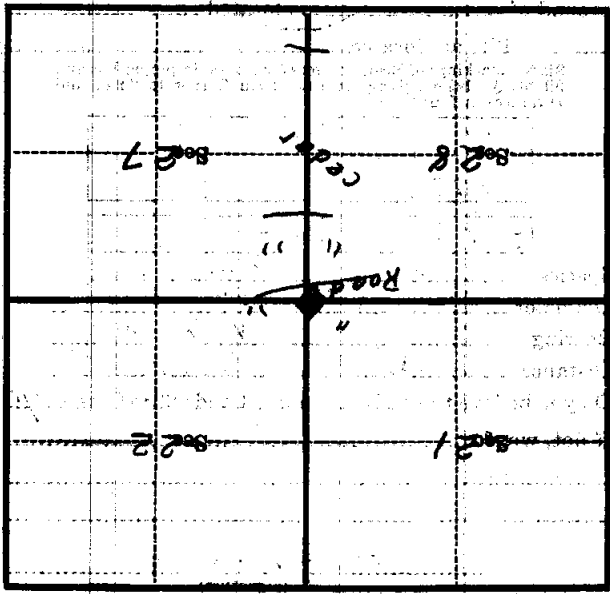

Metal Location Poster is on a *Bitch*

tree 10 inches diameter, on the *North*

side of *Tree*

from which this Corner bears

N 30 E

chains distant

Give any further facts which will aid in finding this

Corner again:

Form 874-9—Revised May, 1918
 U. S. Department of Agriculture
 FOREST SERVICE

*Copied & Posted
 5/34*

NATIONAL FOREST

CORNERS OF THE PUBLIC SURVEY

T. 144 R. 20 Mer.

Corner common to Sections
21, 22, 27, and 28

Corner consists of a new stake (not) in place
 State condition

Dimensions above ground _____ inches
 Sketch grooves, letters, figures, or notches, on proper face or edge.

CARDINAL POSITION

N	W	S	E

DIAGONAL POSITION

NW	SW	SE	NE

Mound of _____ is located _____

Pits are located _____

Sketch markings of Bearing Trees (or Rocks) in proper box and fill blanks below, giving bearings from Corner to Trees and Distances in Links.

Species _____
 Diameter _____
 Bearing _____
 Distance _____

Do you believe this to be a genuine Land Office Corner? _____

If not, why? _____

(Signature)

(Date)

(Title)

R-13

Section 27

Section 27

Section 27

Section 27

Section 27

Section 27

Section 27

Section 27

Section 27

Section 27

Section 27

Section 27

Section 27

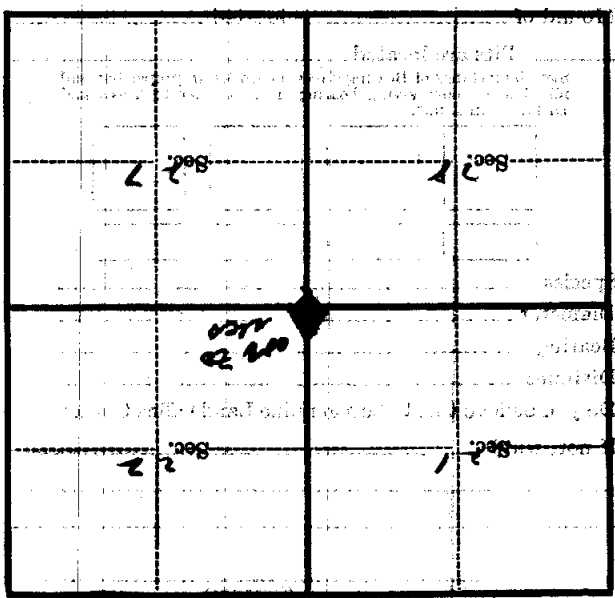

(Make sketch of topography near Corner)