

U. S. Department of Agriculture
FOREST SERVICE

Chippewa NATIONAL FOREST
CORNERS OF THE PUBLIC SURVEY

T. 144N. R. 29W. 5th Mer.

1/4 Corner common to Sections
27, 28

Corner consists of a iron pipe (not) in place
State condition Good

Dimensions above ground 10" high inches
Sketch grooves, letters, figures, or notches, on proper face or edge.

CARDINAL POSITION				DIAGONAL POSITION			
N	W	S	E	NW	SW	SE	NE
			1/4 528/527				

Mound of _____ is located _____

Pits are located _____

Sketch markings of Bearing Trees (or Rocks) in proper box and fill blanks below, giving bearings from Corner to Trees and Distances in Links.

1/4 527		1/4 528	
B.T.		B.T.	

Species Cedar Ash

Diameter 10" 10"

Bearing S89°E N4°W

Distance 31 lks. 7 lks.

Do you believe this to be a genuine Land Office Corner? Yes

If not, why? _____

H. Hanson
(Signature)

12/27/35
(Date)

(Title)

UNITED STATES GEOLOGICAL SURVEY
BUREAU OF LAND SURVEY
FIELD NOTES

Corner again:
Give any further facts which will aid in finding this
chains distant.
from which this Corner bears
side of
tree 8" inches diameter, on the West
Metal Location Poster is on a Cedar

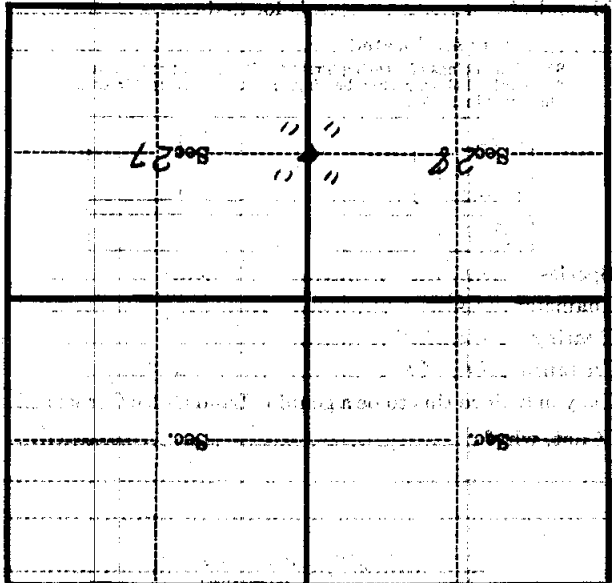

(Make sketch of topography near Corner)

T. L. VAN R. 29W

Mer. T-13

U. S. Department of Agriculture
FOREST SERVICE

Chippewa NATIONAL FOREST

123

CORNERS OF THE PUBLIC SURVEY

T. 144N R. 29W. S²⁶ Mer.

114 Corner common to Sections
27, and 28

Corner consists of a IRON PIPE (not) in place

State condition Good

Dimensions above ground 10" high inches

Sketch grooves, letters, figures, or notches, on proper face or edge.

CARDINAL POSITION

DIAGONAL POSITION

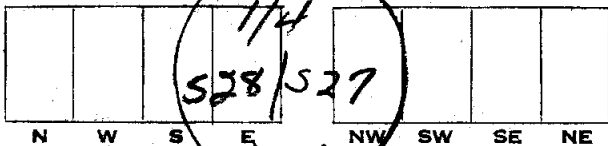

Mound of 1926 is located

Pits are located

Sketch markings of Bearing Trees (or Rocks) in proper box and fill blanks below, giving bearings from Corner to Trees and Distances in Links.

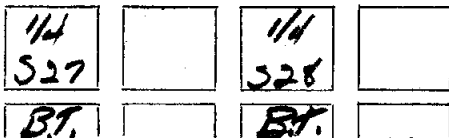

Species Cedar Ash

Diameter 10" 10"

Bearing S89°E N40W

Distance 3 1/2 Links 7 Links

Do you believe this to be a genuine Land Office Corner? Yes.

If not, why?

H. HANSON
(Signature)

12/27/25
(Date)

(Title)

Corner again.

Give any further facts which will aid in finding this

chains distant.

18

from which this Corner bears

S 85° W

side of

Tree

tree of inches diameter, on the

West

Metal Location Poster is on a

Cedar

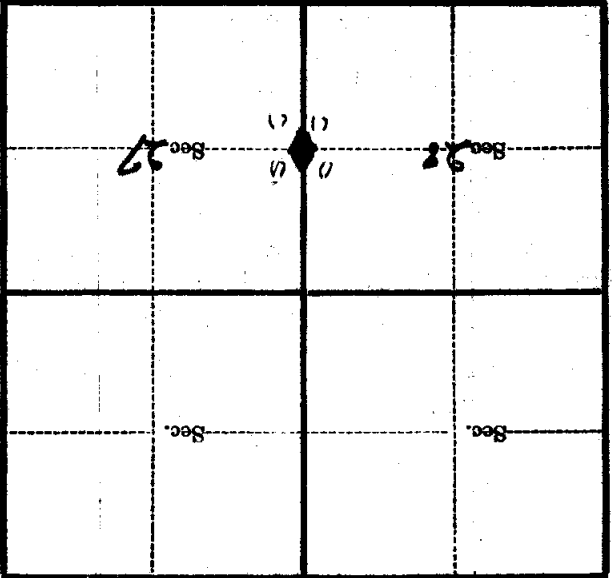

(Make sketch of topography near Corner)

Mer.

T 14 N R 29 W

F-13